

Site file copy
 Prepared for: 25 Apr 69

SITE FILE COPY

Form 10-300
 (Dec. 1968)

UNITED STATES DEPARTMENT OF THE INTERIOR
 NATIONAL PARK SERVICE

NATIONAL REGISTER OF HISTORIC PLACES INVENTORY - NOMINATION FORM

(Type all entries - complete applicable sections)

STATE: Missouri	
COUNTY: Cole	
FOR NPS USE ONLY	
ENTRY NUMBER	DATE

1. NAME

COMMON:
 Governor's Mansion

AND/OR HISTORIC:

2. LOCATION

STREET AND NUMBER:
 100 Madison Street

CITY OR TOWN:
 Jefferson City

STATE: Missouri CODE: 24 COUNTY: Cole CODE: 051

3. CLASSIFICATION

CATEGORY (Check One)	OWNERSHIP	STATUS	ACCESSIBLE TO THE PUBLIC
District <input type="checkbox"/> Building <input checked="" type="checkbox"/>	Public <input checked="" type="checkbox"/>	Occupied <input checked="" type="checkbox"/>	Yes: Restricted <input type="checkbox"/>
Site <input type="checkbox"/> Structure <input type="checkbox"/>	Private <input type="checkbox"/>	Unoccupied <input type="checkbox"/>	Unrestricted <input type="checkbox"/>
Object <input type="checkbox"/>	Both <input type="checkbox"/>	Preservation work in progress <input type="checkbox"/>	No: <input checked="" type="checkbox"/>
PRESENT USE (Check One or More as Appropriate)			
Agricultural <input type="checkbox"/>	Government <input checked="" type="checkbox"/>	Park <input type="checkbox"/>	Transportation <input type="checkbox"/> Comments <input type="checkbox"/>
Commercial <input type="checkbox"/>	Industrial <input type="checkbox"/>	Private Residence <input checked="" type="checkbox"/>	Other (Specify) <input type="checkbox"/>
Educational <input type="checkbox"/>	Military <input type="checkbox"/>	Religious <input type="checkbox"/>	_____
Entertainment <input type="checkbox"/>	Museum <input type="checkbox"/>	Scientific <input type="checkbox"/>	_____

4. OWNER OF PROPERTY

OWNERS NAME:
 State of Missouri, Board of Public Buildings

STREET AND NUMBER:
 State Capitol Building

CITY OR TOWN: Jefferson City STATE: Missouri CODE: 24

5. LOCATION OF LEGAL DESCRIPTION

COURTHOUSE, REGISTRY OF DEEDS, ETC.:
 Office of Recorder of Deeds, Cole County Courthouse

STREET AND NUMBER:
 State Capitol Building

CITY OR TOWN: Jefferson City STATE: Missouri CODE: 24

APPROXIMATE ACREAGE OF NOMINATED PROPERTY: 3.31

6. REPRESENTATION IN EXISTING SURVEYS

TITLE OF SURVEY:
 Missouri Historic Sites Catalogue

DATE OF SURVEY: 1963 Federal State County Local

DEPOSITORY FOR SURVEY RECORDS:
 State Historical Society of Missouri

STREET AND NUMBER:
 Corner, Hitt and Lowry streets

CITY OR TOWN: Columbia STATE: Missouri CODE: 24

SEE INSTRUCTIONS

STATE: Missouri
 COUNTY: Cole
 ENTRY NUMBER:
 DATE:
 1

NATIONAL REGISTER OF HISTORIC PLACES
INVENTORY - NOMINATION FORM

(Continuation Sheet)

STATE	
Missouri	
COUNTY	
Cole	
FOR NPS USE ONLY	
ENTRY NUMBER	DATE

(Number all entries)

GOVERNOR'S MANSION

6. Missouri's Contribution to American Architecture (state)

1928

John Albury Bryan

c/o St. Louis Architectural Club, Publisher

St. Louis, Missouri 63130

Code: 24

Missouri State Historical Survey (state)

1968

Missouri State Park Board

P.O. Box 176

1204 Jefferson Building

Jefferson City, Missouri 65101

Code: 24

7. DESCRIPTION

CONDITION	(Check One)					
	Excellent <input type="checkbox"/>	Good <input checked="" type="checkbox"/>	Fair <input type="checkbox"/>	Deteriorated <input type="checkbox"/>	Ruins <input type="checkbox"/>	Unexposed <input type="checkbox"/>
INTEGRITY	(Check One)			(Check One)		
	Altered <input checked="" type="checkbox"/>	Unaltered <input type="checkbox"/>		Moved <input type="checkbox"/>	Original Site <input checked="" type="checkbox"/>	

DESCRIBE THE PRESENT AND ORIGINAL (If known) PHYSICAL APPEARANCE

Three-story mansard roof Victorian residence designed by St. Louis architect George I. Barnett, situated on a bluff overlooking a wide bend in the Missouri River. Brick and stone construction, well finished with mouldings, quoins, and cresting. Red granite columns donated by Governor B. Gratz Brown (1871-1873), first governor to occupy the Mansion. Columns were quarried from his property in Iron County, Missouri. Grounds are enclosed by ornamental iron fence.

First floor includes large entrance hall, reception parlors, library and dining room. Second floor contains large hallway, seven bedrooms and four baths. Third floor has six bedrooms, two baths, billiard room, and the ballroom, which extends the full length of Mansion from north to south. Winding stairway in central hallway has ornate railing and newel post and connects the three floors.

Carriage porch and entrance on south added, 1900-1904. Interior remodeled and modernized, 1938, 1956, and 1960.

Building presently under repair. When repair work is completed, building will be in excellent condition.

SEE INSTRUCTIONS

B. SIGNIFICANCE

PERIOD (Check One or More as Appropriate)

Pre-Columbian 16th Century 18th Century 20th Century
 15th Century 17th Century 19th Century

SPECIFIC DATE(S) (If Applicable and Known)

AREAS OF SIGNIFICANCE (Check One or More as Appropriate)

Aboriginal	Education	<input type="checkbox"/>	Political	<input checked="" type="checkbox"/>	Urban Planning	<input type="checkbox"/>
Prehistoric	Engineering	<input type="checkbox"/>	Religion/Phi-		Other (Specify)	<input type="checkbox"/>
Historic	Industry	<input type="checkbox"/>	losophy	<input type="checkbox"/>	_____	
Agriculture	Invention	<input type="checkbox"/>	Science	<input type="checkbox"/>	_____	
Art	Landscape		Sculpture	<input type="checkbox"/>	_____	
Commerce	Architecture	<input type="checkbox"/>	Social/Human-		_____	
Communications	Literature	<input type="checkbox"/>	itarian	<input type="checkbox"/>	_____	
Conservation	Military	<input type="checkbox"/>	Theater	<input type="checkbox"/>	_____	
	Music	<input type="checkbox"/>	Transportation	<input type="checkbox"/>	_____	

STATEMENT OF SIGNIFICANCE (Include Personages, Dates, Events, Etc.)

The primary significance of the Governor's Mansion derives from building's use as the official residence of Missouri's governors, 1871 to present. Secondary significance of Mansion rests in the fact that it is an outstanding example of a three-story mansard roof Victorian residence and was designed by a notable St. Louis architect, George I. Barnett. Mansion faces the Cole County Historical Society Building located at 109 Madison Street. The latter building is included in a row of nineteenth century urban houses which enhance the setting of the Mansion by sustaining the period homogeneity of the neighborhood.

In April, 1871, Governor B. Gratz Brown obtained a state appropriation of \$50,000 for the construction of a new executive mansion. The Mansion replaced an earlier executive residence located slightly to the south of it. The old executive mansion was razed soon after completion of the present structure.

A marker, erected in 1941 by the Daughters of the American Colonists, commemorates the site of the first Capitol and Governor's Mansion in the City of Jefferson.

SEE INSTRUCTIONS

9. MAJOR BIBLIOGRAPHICAL REFERENCES

1. Caldwell, Dorothy J. (ed.). Missouri Historic Sites Catalogue. Columbia, Missouri: The State Historical Society of Missouri, 1963.
2. Jefferson City Daily Tribune, April 12, 1871, p. 2, col. 4. Plans for new mansion submitted.
3. _____, Oct. 24, 1895, p. 4, col. 3. History of mansion, including reference to former Governor's Mansion on same site.
4. Jefferson City News and Tribune, Nov. 17, 1957, p. 8. History of State Governor's Mansions.

10. GEOGRAPHICAL DATA

LATITUDE AND LONGITUDE COORDINATES DEFINING A RECTANGLE LOCATING THE PROPERTY			O R	LATITUDE AND LONGITUDE COORDINATES DEFINING THE CENTER POINT OF A PROPERTY OF LESS THAN ONE ACRE		
CORNER	LATITUDE	LONGITUDE		LATITUDE	LONGITUDE	
	Degrees Minutes Seconds	Degrees Minutes Seconds		Degrees Minutes Seconds	Degrees Minutes Seconds	
N NW	38° 34' 44"	92° 10' 13"		° ' "	° ' "	
E NE	38° 34' 41"	92° 10' 09"		° ' "	° ' "	
S SE	38° 34' 38"	92° 10' 12"		° ' "	° ' "	
W SW	38° 34' 40"	92° 10' 16"		° ' "	° ' "	

LIST ALL STATES AND COUNTIES FOR PROPERTIES OVERLAPPING STATE OR COUNTY BOUNDARIES

STATE:	CODE	COUNTY	CODE
STATE:	CODE	COUNTY:	CODE
STATE:	CODE	COUNTY:	CODE
STATE:	CODE	COUNTY:	CODE

11. FORM PREPARED BY

NAME AND TITLE:
M. Patricia Holmes, Research Architectural Historian

ORGANIZATION Missouri State Park Board DATE April 25, 1969
State Historical Survey and Planning Office

STREET AND NUMBER:
P.O. Box 176, 1204 Jefferson Building

CITY OR TOWN: STATE CODE
Jefferson City Missouri 65101 21

12. STATE LIAISON OFFICER CERTIFICATION

As the designated State Liaison Officer for the National Historic Preservation Act of 1966 (Public Law 89-665), I hereby nominate this property for inclusion in the National Register and certify that it has been evaluated according to the criteria and procedures set forth by the National Park Service. The recommended level of significance of this nomination is:

National State Local

Name Joseph Jaeger, Jr.

Title Director, Missouri State Park Board, and Missouri State Liaison Officer

Date _____

NATIONAL REGISTER VERIFICATION

I hereby certify that this property is included in the National Register.

Chief, Office of Archeology and Historic Preservation

Date _____

ATTEST:

Keeper of The National Register

Date _____

SEE INSTRUCTIONS

NATIONAL REGISTER OF HISTORIC PLACES
INVENTORY - NOMINATION FORM

(Continuation Sheet)

STATE	
Missouri	
COUNTY	
Cole	
FOR NPS USE ONLY	
ENTRY NUMBER	DATE

(Number all entries)

GOVERNOR'S MANSION

9.

5. Official Manual, State of Missouri, 1967-1968,
James C. Kirkpatrick, Secretary of State, State
Capitol, Jefferson City, Missouri.
6. State Historical Society of Missouri, Corner, Hitt
and Lowry streets, Columbia, Missouri, Historic
Sites Files, ref. Cole County.

SITE FILE COPY

Form 10-300
(Dec. 1968)

UNITED STATES DEPARTMENT OF THE INTERIOR
NATIONAL PARK SERVICE

NATIONAL REGISTER OF HISTORIC PLACES INVENTORY - NOMINATION FORM

(Type all entries - complete applicable sections)

STATE: Missouri	
COUNTY: Cole	
FOR NPS USE ONLY	
ENTRY NUMBER 69-05-24-0016	DATE 5/21/69

SEE INSTRUCTIONS

1. NAME

COMMON:
Governor's Mansion

AND/OR HISTORIC:

2. LOCATION

STREET AND NUMBER:
100 Madison Street

CITY OR TOWN:
Jefferson City

STATE Missouri	CODE 24	COUNTY: Cole	CODE 051
-------------------	------------	-----------------	-------------

3. CLASSIFICATION

CATEGORY (Check One)	OWNERSHIP	STATUS	ACCESSIBLE TO THE PUBLIC
District <input type="checkbox"/> Building <input checked="" type="checkbox"/>	Public <input checked="" type="checkbox"/>	Occupied <input checked="" type="checkbox"/>	Yes: <input type="checkbox"/>
Site <input type="checkbox"/> Structure <input type="checkbox"/>	Private <input type="checkbox"/>	Unoccupied <input type="checkbox"/>	Restricted <input type="checkbox"/>
Object <input type="checkbox"/>	Both <input type="checkbox"/>	Preservation work in progress <input type="checkbox"/>	Unrestricted <input type="checkbox"/>
			No: <input checked="" type="checkbox"/>

PRESENT USE (Check One or More as Appropriate)

Agricultural <input type="checkbox"/>	Government <input checked="" type="checkbox"/>	Park <input type="checkbox"/>	Transportation <input type="checkbox"/>	Comments <input type="checkbox"/>
Commercial <input type="checkbox"/>	Industrial <input type="checkbox"/>	Private Residence <input checked="" type="checkbox"/>	Other (Specify) <input type="checkbox"/>	
Educational <input type="checkbox"/>	Military <input type="checkbox"/>	Religious <input type="checkbox"/>		
Entertainment <input type="checkbox"/>	Museum <input type="checkbox"/>	Scientific <input type="checkbox"/>		

4. OWNER OF PROPERTY

OWNERS NAME:
State of Missouri, Board of Public Buildings

STREET AND NUMBER:
State Capitol Building

CITY OR TOWN: Jefferson City	STATE: Missouri	CODE 24
---------------------------------	--------------------	------------

5. LOCATION OF LEGAL DESCRIPTION

COURTHOUSE, REGISTRY OF DEEDS, ETC:
Office of Recorder of Deeds, Cole County Courthouse

STREET AND NUMBER:
State Capitol Building

CITY OR TOWN: Jefferson City	STATE: Missouri	CODE 24
---------------------------------	--------------------	------------

APPROXIMATE ACREAGE OF NOMINATED PROPERTY: 3.31

6. REPRESENTATION IN EXISTING SURVEYS

TITLE OF SURVEY:
Missouri Historic Sites Catalogue

DATE OF SURVEY: 1963 Federal State County Local

DEPOSITORY FOR SURVEY RECORDS:
State Historical Society of Missouri

STREET AND NUMBER:
Corner, Hitt and Lowry streets

CITY OR TOWN: Columbia	STATE: Missouri	CODE 24
---------------------------	--------------------	------------

STATE: MISSOURI
COUNTY: COLE
ENTRY NUMBER: 69-05-24-0016
DATE: 5/21/69
FOR NPS USE ONLY

SEE INSTRUCTIONS

9. MAJOR BIBLIOGRAPHICAL REFERENCES

1. Caldwell, Dorothy J. (ed.). Missouri Historic Sites Catalogue. Columbia, Missouri: The State Historical Society of Missouri, 1963.
2. Jefferson City Daily Tribune, April 12, 1871, p. 2, col. 4. Plans for new mansion submitted.
3. _____, Oct. 24, 1895, p. 4, col. 3. History of Mansion, including reference to former Governor's Mansion on same site.
4. Jefferson City News and Tribune, Nov. 17, 1957, p. 8. History of State Governor's Mansions.

10. GEOGRAPHICAL DATA

LATITUDE AND LONGITUDE COORDINATES DEFINING A RECTANGLE LOCATING THE PROPERTY			O R	LATITUDE AND LONGITUDE COORDINATES DEFINING THE CENTER POINT OF A PROPERTY OF LESS THAN ONE ACRE		
CORNER	LATITUDE			LONGITUDE		
	Degrees	Minutes	Seconds	Degrees	Minutes	Seconds
N NW	38°	34'	44"	92°	10'	13"
E NE	38°	34'	41"	92°	10'	09"
S SE	38°	34'	38"	92°	10'	12"
W SW	38°	34'	40"	92°	10'	16"

LIST ALL STATES AND COUNTIES FOR PROPERTIES OVERLAPPING STATE OR COUNTY BOUNDARIES

STATE:	CODE	COUNTY	CODE

11. FORM PREPARED BY

NAME AND TITLE: M. Patricia Holmes, Research Architectural Historian

ORGANIZATION: Missouri State Park Board DATE: April 25, 1969
State Historical Survey and Planning Office

STREET AND NUMBER: P.O. Box 176, 1201 Jefferson Building

CITY OR TOWN: Jefferson City STATE: Missouri 65101 CODE: 21

12. STATE LIAISON OFFICER CERTIFICATION NATIONAL REGISTER VERIFICATION

<p>As the designated State Liaison Officer for the National Historic Preservation Act of 1966 (Public Law 89-665), I hereby nominate this property for inclusion in the National Register and certify that it has been evaluated according to the criteria and procedures set forth by the National Park Service. The recommended level of significance of this nomination is:</p> <p>National <input type="checkbox"/> State <input checked="" type="checkbox"/> Local <input type="checkbox"/></p> <p>Name: <u>Joseph Jaeger, Jr.</u></p> <p>Title: <u>Director, Missouri State Park Board, and Missouri State Liaison Officer</u></p> <p>Date: _____</p>	<p>I hereby certify that this property is included in the National Register.</p> <p><u>Grant Allen Gentry</u> Chief, Office of Archeology and Historic Preservation</p> <p>Date: <u>May 21, 1969</u></p> <p>ATTEST:</p> <p><u>William J. Schwartz</u> Keeper of The National Register</p> <p>Date: <u>May 21, 1969</u></p>
-------------------------------------------------------------------------------------------------------------------------------------------------------------------------------------------------------------------------------------------------------------------------------------------------------------------------------------------------------------------------------------------------------------------------------------------------------------------------------------------------------------------------------------------------------------------------------------------------------------------------------------------------------------	------------------------------------------------------------------------------------------------------------------------------------------------------------------------------------------------------------------------------------------------------------------------------------------------------------------------------------------------------

SITE FILE COPY

Form 10-300
(Rev. 6-72)

UNITED STATES DEPARTMENT OF THE INTERIOR
NATIONAL PARK SERVICE

NATIONAL REGISTER OF HISTORIC PLACES INVENTORY - NOMINATION FORM

(Type all entries - complete applicable sections)

STATE:	Missouri
COUNTY:	Cole
FOR NPS USE ONLY	
ENTRY DATE	

SITE FILE COPY October, 1974 VERSION

1. NAME

COMMON: Governor's Mansion

AND/OR HISTORIC:

2. LOCATION

STREET AND NUMBER: 100 Madison Street

CITY OR TOWN: Jefferson City CONGRESSIONAL DISTRICT: 8th
The Hon. Richard H. Ichord

STATE: Missouri CODE: 29 COUNTY: Cole CODE: 051

3. CLASSIFICATION

CATEGORY (Check One)	OWNERSHIP	STATUS	ACCESSIBLE TO THE PUBLIC
<input type="checkbox"/> District <input type="checkbox"/> Site <input type="checkbox"/> Object <input checked="" type="checkbox"/> Building <input type="checkbox"/> Structure <input type="checkbox"/> Object	<input checked="" type="checkbox"/> Public <input type="checkbox"/> Private <input type="checkbox"/> Both	<input checked="" type="checkbox"/> Occupied <input type="checkbox"/> Unoccupied <input type="checkbox"/> Preservation work in progress	Yes: <input checked="" type="checkbox"/> Restricted <input type="checkbox"/> Unrestricted <input type="checkbox"/> No
PRESENT USE (Check One or More as Appropriate)			
<input type="checkbox"/> Agricultural <input type="checkbox"/> Commercial <input type="checkbox"/> Educational <input type="checkbox"/> Entertainment	<input checked="" type="checkbox"/> Government <input type="checkbox"/> Industrial <input type="checkbox"/> Military <input type="checkbox"/> Museum	<input type="checkbox"/> Park <input type="checkbox"/> Private Residence <input type="checkbox"/> Religious <input type="checkbox"/> Scientific	<input type="checkbox"/> Transportation <input type="checkbox"/> Other (Specify) _____ _____

4. OWNER OF PROPERTY

OWNER'S NAME: State of Missouri, Board of Public Buildings

STREET AND NUMBER: State Capitol Building

CITY OR TOWN: Jefferson City STATE: Missouri CODE: 29

5. LOCATION OF LEGAL DESCRIPTION

COURTHOUSE, REGISTRY OF DEEDS, ETC.: Office of Recorder of Deeds, Cole County Courthouse

STREET AND NUMBER: Monroe and East High streets

CITY OR TOWN: Jefferson City STATE: Missouri CODE: 29

6. REPRESENTATION IN EXISTING SURVEYS

TITLE OF SURVEY: Missouri Historic Sites Catalogue

DATE OF SURVEY: 1963 Federal State County Local

DEPOSITORY FOR SURVEY RECORDS: State Historical Society of Missouri

STREET AND NUMBER: Corner, Hitt and Lowry streets

CITY OR TOWN: Columbia, STATE: Missouri CODE: 29

SEE INSTRUCTIONS

STATE:	Missouri
COUNTY:	Cole
ENTRY NUMBER	
DATE	

FOR NPS USE ONLY

NATIONAL REGISTER OF HISTORIC PLACES
INVENTORY - NOMINATION FORM

(Continuation Sheet)

STATE Missouri	
COUNTY Cole	
FOR NPS USE ONLY	
ENTRY NUMBER	DATE

(Number all entries)

6. #1 GOVERNOR'S MANSION
2. Missouri's Contribution to American Architecture
1928 (state)
John Albury Bryan
St. Louis Architectural Club, Publisher
St. Louis, Missouri Code: 29
3. Missouri State Historical Survey
1968 & 1974 (state)
Department of Natural Resources
P.O. Box 176
Jefferson City, Missouri 65101 Code: 29

9. MAJOR BIBLIOGRAPHICAL REFERENCES

1. Bryan, John Albury. Missouri's Contribution to American Architecture. St. Louis, Missouri: St. Louis Architectural Club, 1928.
2. Brown, Linda L. Data compiled on the history of the Executive Mansion preparatory to updating the National Register Inventory Nomination Form. Miss Brown is News Assistant, Executive Office, State Capitol Building, October, 1973.

10. GEOGRAPHICAL DATA

LATITUDE AND LONGITUDE COORDINATES DEFINING A RECTANGLE LOCATING THE PROPERTY			O R	LATITUDE AND LONGITUDE COORDINATES DEFINING THE CENTER POINT OF A PROPERTY OF LESS THAN TEN ACRES		
CORNER	LATITUDE	LONGITUDE		LATITUDE	LONGITUDE	
	Degrees Minutes Seconds	Degrees Minutes Seconds		Degrees Minutes Seconds	Degrees Minutes Seconds	
N-NW	38° 34' 44"	92° 10' 12"		° ' "	° ' "	
E-NE	38° 34' 41"	92° 10' 07"				
S-SE	38° 34' 37"	92° 10' 11"				
W-SW	38° 34' 40"	92° 10' 16"				

APPROXIMATE ACREAGE OF NOMINATED PROPERTY: less than 10 acres

LIST ALL STATES AND COUNTIES FOR PROPERTIES OVERLAPPING STATE OR COUNTY BOUNDARIES

STATE:	CODE	COUNTY	CODE

11. FORM PREPARED BY

NAME AND TITLE: M. Patricia Holmes, Research Associate

ORGANIZATION: Department of Natural Resources DATE: July 22, 1974
State Historical Survey and Planning Office

STREET AND NUMBER: P. O. Box 176

CITY OR TOWN: Jefferson City STATE: Missouri CODE: 29
65101

12. STATE LIAISON OFFICER CERTIFICATION NATIONAL REGISTER VERIFICATION

<p>As the designated State Liaison Officer for the National Historic Preservation Act of 1966 (Public Law 89-665), I hereby nominate this property for inclusion in the National Register and certify that it has been evaluated according to the criteria and procedures set forth by the National Park Service. The recommended level of significance of this nomination is:</p> <p>National <input type="checkbox"/> State <input checked="" type="checkbox"/> Local <input type="checkbox"/></p> <p>Name <u>James L. Wilson</u></p> <p>Title <u>Director, Department of Natural Resources, and State Historic Preservation Officer</u></p> <p>Date _____</p>	<p>I hereby certify that this property is included in the National Register.</p> <p>_____ <i>Director, Office of Archeology and Historic Preservation</i></p> <p>Date _____</p> <p>ATTEST:</p> <p>_____ <i>Keeper of The National Register</i></p> <p>Date _____</p>
----------------------------------------------------------------------------------------------------------------------------------------------------------------------------------------------------------------------------------------------------------------------------------------------------------------------------------------------------------------------------------------------------------------------------------------------------------------------------------------------------------------------------------------------------------------------------------------------------------------------------------------------------------------------------	--------------------------------------------------------------------------------------------------------------------------------------------------------------------------------------------------------------------------------------------------------------------------------

SEE INSTRUCTIONS

NATIONAL REGISTER OF HISTORIC PLACES
INVENTORY - NOMINATION FORM

(Continuation Sheet)

STATE	
Missouri	
COUNTY	
Cole	
FOR NPS USE ONLY	
ENTRY NUMBER	DATE

(Number all entries)

9. #1

GOVERNOR'S MANSION

3. Caldwell, Dorothy J. (ed.). Missouri Historic Sites Catalogue. Columbia, Missouri: The State Historical Society of Missouri, 1963.
4. Jefferson City [Missouri] Daily Tribune, April 12, 1871, p. 2, col. 4. Plans for new mansion submitted.
5. _____, October 24, 1895, p. 4, col. 3. History of mansion, including reference to former Governor's Mansion on same site.
6. Jefferson City [Missouri] News and Tribune, November 17, 1957, p. 8. History of State Governor's Mansions.
7. Official Manual, State of Missouri, 1967-1968, James C. Kirkpatrick, Secretary of State, State Capitol, Jefferson City, Missouri.
8. State Historical Society of Missouri, Corner, Hitt and Lowry streets, Columbia, Missouri, Historic Sites Files, ref. Cole County.

Form 10-301
(Dec. 1968)

UNITED STATES DEPARTMENT OF THE INTERIOR
NATIONAL PARK SERVICE

NATIONAL REGISTER OF HISTORIC PLACES PROPERTY MAP FORM

(Type all entries - attach to or enclose with map)

STATE	Missouri
COUNTY	Cole
FOR NPS USE ONLY	
ENTRY NUMBER	
DATE	
1. NAME	
COMMON:	Governor's Mansion
AND/OR HISTORIC:	
2. LOCATION	
STREET AND NUMBER:	100 Madison Street
CITY OR TOWN:	Jefferson City
STATE:	Missouri
CODE	24
COUNTY:	Cole
CODE	051
3. MAP REFERENCE	
SOURCE:	U.S.G.S. 7.5' quadrangle Jefferson City
SCALE:	1:24,000
DATE:	1939
4. REQUIREMENTS	
TO BE INCLUDED ON ALL MAPS	
1. Property boundaries where required.	
2. North arrow.	
3. Latitude and longitude reference.	

SEE INSTRUCTIONS

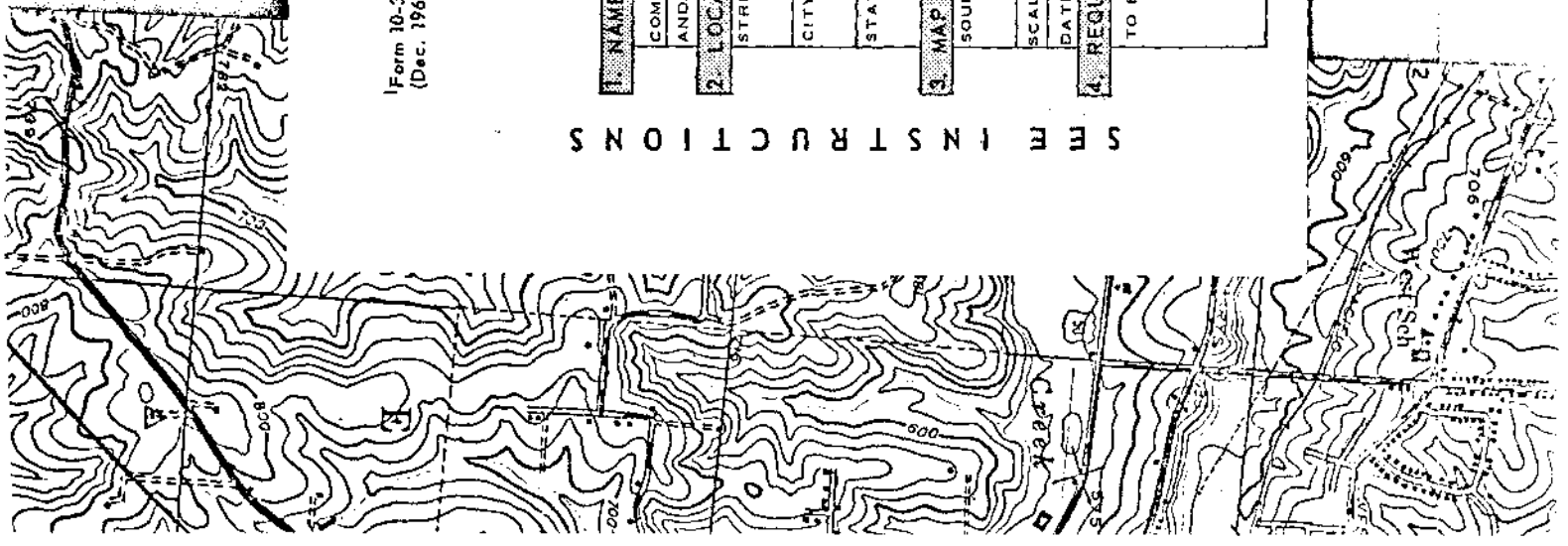

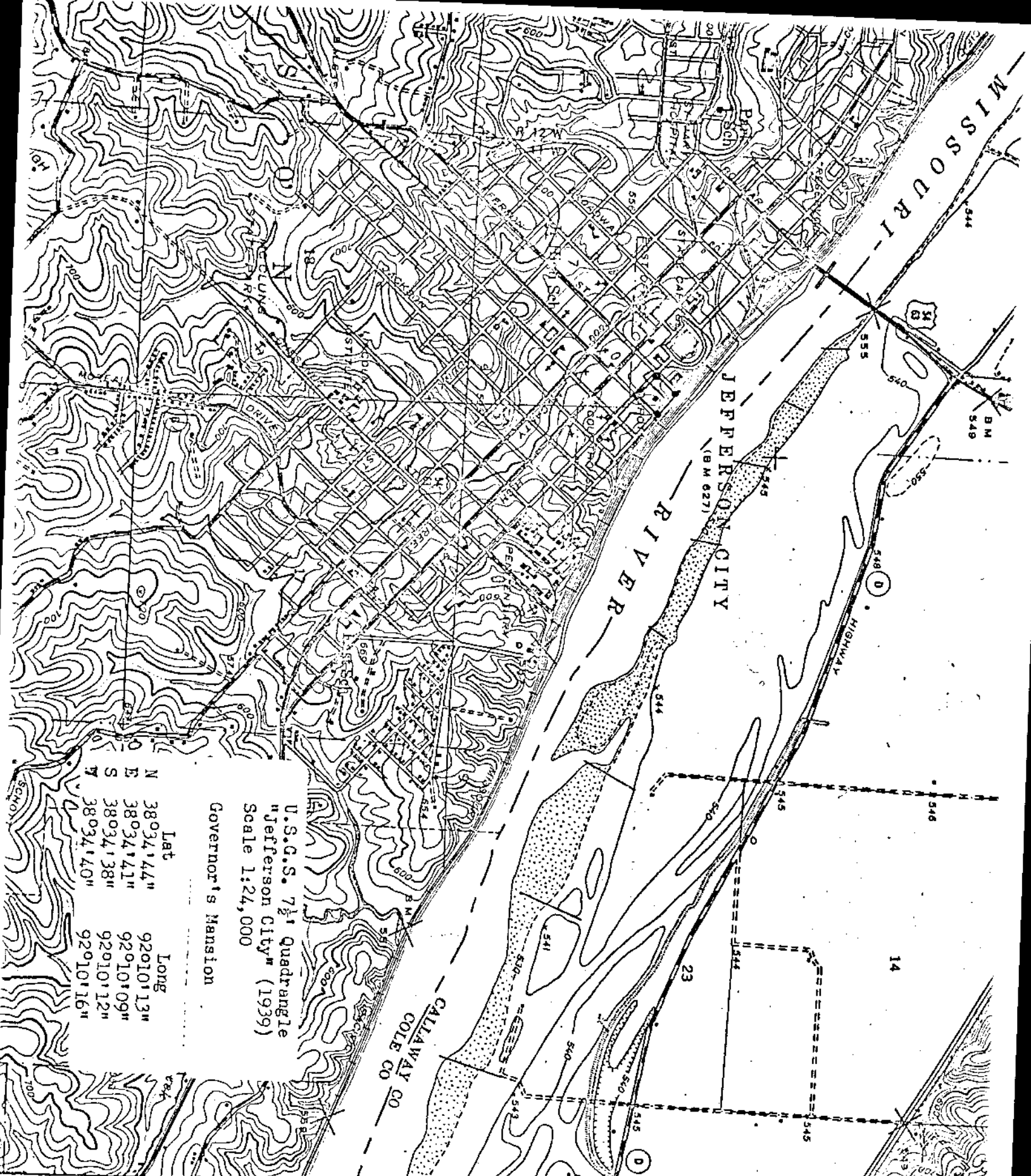

	Lat	Long
N	38°34'44"	92°10'13"
E	38°34'41"	92°10'09"
S	38°34'38"	92°10'12"
W	38°34'40"	92°10'16"

U.S.G.S. 7 1/2' Quadrangle
 "Jefferson City" (1939)
 Scale 1:24,000
 Governor's Mansion

(Jefferson City 1:62500)

8.4 MI. TO JUNC. U.S. 63
 LINN 17 MI.

TEBBETS 10 MI.
 MOKANE 16 MI.

TM
 6 1/2°

SEE INSTRUCTIONS

Form 10-301
(Dec. 1968)

UNITED STATES DEPARTMENT OF THE INTERIOR
NATIONAL PARK SERVICE

NATIONAL REGISTER OF HISTORIC PLACES
PROPERTY MAP FORM

(Type all entries - attach to or enclose with map)

1. NAME		STATE	
COMMON: Governor's Mansion		Missouri	
AND/OR HISTORIC:		COUNTY	
2. LOCATION		Cole	
STREET AND NUMBER: 100 Madison Street		FOR NPS USE ONLY	
CITY OR TOWN: Jefferson City		ENTRY NUMBER	DATE
STATE: Missouri		571	
MAP REFERENCE		CODE	
SOURCE: State Highway Department Map, Jefferson City, Missouri 65101		051	
SCALE: Not to scale			
DATE: n.d.			
4. REQUIREMENTS			
TO BE INCLUDED ON ALL MAPS			
1. Property boundaries where required.			
2. North arrow.			
3. Latitude and longitude reference.			

Form 10-301
(Dec. 1968)

UNITED STATES DEPARTMENT OF THE INTERIOR
NATIONAL PARK SERVICE

NATIONAL REGISTER OF HISTORIC PLACES

PROPERTY MAP FORM

(Type all entries - attach to or enclose with map)

STATE	Missouri
COUNTY	Cole
FOR NPS USE ONLY	
ENTRY NUMBER	DATE

1. NAME
COMMON: Governor's Mansion

AND/OR HISTORIC:
2. LOCATION
STREET AND NUMBER: 100 Madison Street

CITY OR TOWN: Jefferson City

STATE: Missouri
CODE 21
COUNTY: Cole
CODE 051

3. MAP REFERENCE
SOURCE: Sketch made by Division of Public Buildings
Jefferson City, Missouri 65101

SCALE: Not to scale
DATE: 1965

4. REQUIREMENTS
TO BE INCLUDED ON ALL MAPS
1. Property boundaries where required.
2. North arrow.
3. Latitude and longitude reference.

SEE INSTRUCTIONS

NATIONAL REGISTER OF HISTORIC PLACES
INVENTORY - NOMINATION FORM

(Continuation Sheet)

STATE	
COUNTY	
FOR NPS USE ONLY	
ENTRY NUMBER	DATE

(Number all entries)

STATE CAPITOL GROUP JEFFERSON CITY, MO.

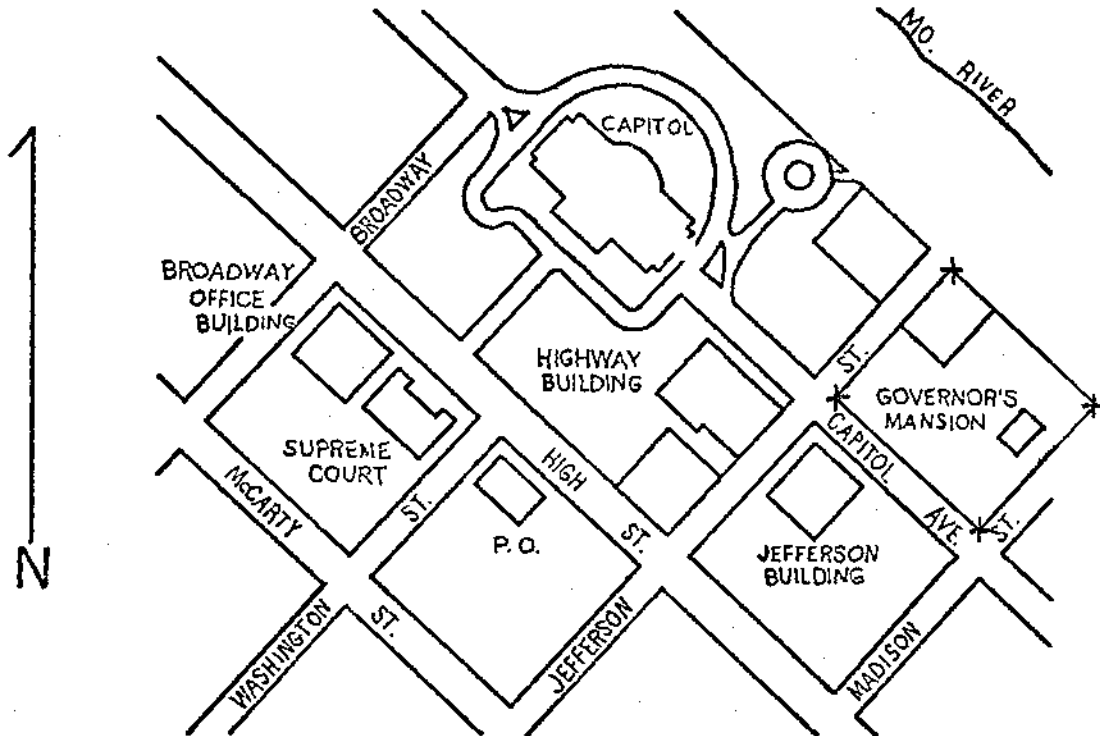

Map excerpted from
STATE HIGHWAY DEPT. MAP
JEFFERSON CITY, MO., n.d.

SCALE NOT KNOWN

MSHS, 4-24-69
Martha Godfrey

NATIONAL REGISTER OF HISTORIC PLACES
INVENTORY - NOMINATION FORM

(Continuation Sheet)

STATE	
COUNTY	
FOR NPS USE ONLY	
ENTRY NUMBER	DATE

(Number all entries)

GOVERNOR'S MANSION
JEFFERSON CITY, MO.

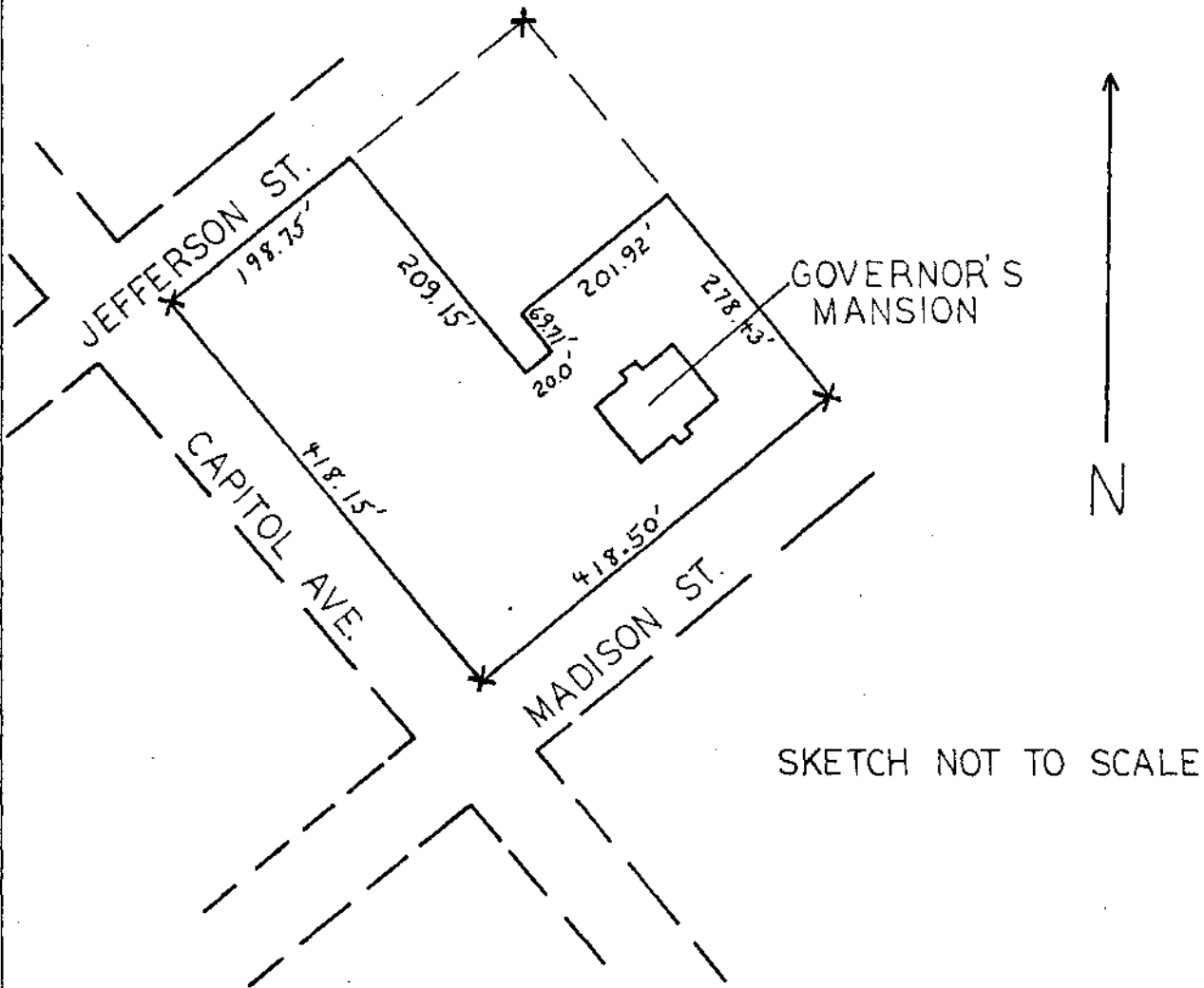

DRAWING FROM A SKETCH
MADE BY DIVISION OF PUBLIC
BUILDINGS, JEFFERSON CITY, MO.
1965.

MSHS, 4-23-69
Steven Teczar

Go
by
15
72
be
oc

C 8746

FORM 10-301 A
(6/72)

UNITED STATES DEPARTMENT OF THE INTERIOR
NATIONAL PARK SERVICE

**NATIONAL REGISTER OF HISTORIC PLACES
PROPERTY PHOTOGRAPH FORM**

(Type all entries - attach to or enclose with photograph)

1. NAME		NUMERIC CODE (Assigned by NPS)	
COMMON	AND/OR HISTORIC		
Governor's Mansion			
2. LOCATION			
STATE	COUNTY	TOWN	
Missouri	Cole	Jefferson City	
STREET AND NUMBER			
100 Madison Street			
3. PHOTO REFERENCE		NEGATIVE FILED AT	
PHOTO CREDIT	DATE	October 1974, Department of Natural Resources, P. O. Box 176, Jefferson City, Mo. 65101	
Office of the Governor	October, 1974		
4. IDENTIFICATION			
DESCRIBE VIEW, DIRECTION, ETC.			

Interior view of the mansion showing carved marble fireplace in first floor parlor.



FORM 10-301 A
(6/72)

UNITED STATES DEPARTMENT OF THE INTERIOR
NATIONAL PARK SERVICE
NATIONAL REGISTER OF HISTORIC PLACES
PROPERTY PHOTOGRAPH FORM

(Type all entries - attach to or enclose with photograph)

1. NAME		
COMMON Governor's Mansion	AND/OR HISTORIC	NUMERIC CODE (Assigned by NPS)
2. LOCATION		
STATE Missouri 65101	COUNTY Cole	TOWN Jefferson City
STREET AND NUMBER 100 Madison Street		
3. PHOTO REFERENCE		
PHOTO CREDIT Office of the Governor	DATE October, 1974	NEGATIVE FILED AT Copy Negative, October 1974, Department of Natural Resources, P. O. Box 1 Jefferson City, Mo. 65101
4. IDENTIFICATION		
DESCRIBE VIEW, DIRECTION, ETC.		

Interior view of the mansion showing grand stairway.

SITE FILE COPY



SITE FILE COPY

Jefferson

UNITED STATES DEPARTMENT OF THE INTERIOR
NATIONAL PARK SERVICE
NATIONAL REGISTER OF HISTORIC PLACES
PROPERTY PHOTOGRAPH FORM
(Type all entries - attach to or enclose with photograph)

FORM 10-301 A
(6/72)

1. NAME COMMON		AND/OR HISTORIC	NUMERIC CODE (Assigned by NPS)
Governor's Mansion			
2. LOCATION		COUNTY	TOWN
STATE	Missouri 65101	Cole	Jefferson City
STREET AND NUMBER			
100 Madison Street			
3. PHOTO REFERENCE		DATE	NEGATIVE FILED AT
PHOTO CREDIT	M. Patricia Holmes	April 21, 1970	Dept. of Natural Resources P. O. Box 176 Jefferson City, Mo. 65101
4. IDENTIFICATION		DESCRIBE VIEW, DIRECTION, ETC.	

View from the south-southeast, looking north-northwest, showing the primary south-east facade. The architectural design features a mansard roof, ornamental cresting, neo-classic dormers and window treatment, and polished granite portico columns matching the red brick in color--an effect which was lost while the house was painted white.



S E M I N S T R U C T I O N S

PROPERTY PHOTOGRAPH FORM

		FOR NPS USE ONLY	
		ENTRY NUMBER	DATE
(Type all entries - attach to or enclose with photograph)			
1. NAME			
COMMON: Governor's Mansion			
AND/OR HISTORIC:			
2. LOCATION			
STREET AND NUMBER: 100 Madison Street			
CITY OR TOWN: Jefferson City			
STATE: Missouri		CODE: 24	COUNTY: Cole
3. PHOTO REFERENCE		CODE: 051	
PHOTO CREDIT: M. Patricia Holmes, State Historical Survey, Missouri State Park Board			
DATE OF PHOTO: 19 August 1968			
NEGATIVE FILED AT: Missouri State Park Board, P. O. Box 176			
1201 Jefferson Building, Jefferson City, Missouri 65101			
4. IDENTIFICATION			
DESCRIBE VIEW, DIRECTION, ETC.			
Looking northwest at southeast face of building. Note mansard roof and red granite columns.			

