

**MERAMEC RIVER SOUTH , PAGE 1**  
**COMPOSITE MAP SERIES**

26

27

28

29

SCALE  
1" = 800'

30

# MERAMEC RIVER SOUTH , PAGE 2

THE REPRODUCTION OR COPYING OF THIS MAP OR ANY PART THEREOF BY ANY PROCESS IS PROHIBITED WITHOUT WRITTEN PERMISSION OF THE DIRECTOR OF THE ST. LOUIS COUNTY DEPARTMENT OF REVENUE.

THIS MAP UPDATED:  
3-26-93

ST. LOUIS COUNTY  
REVENUE TECHNICAL SERVICES  
DIVISION OF MAPPING

26-29-O-R



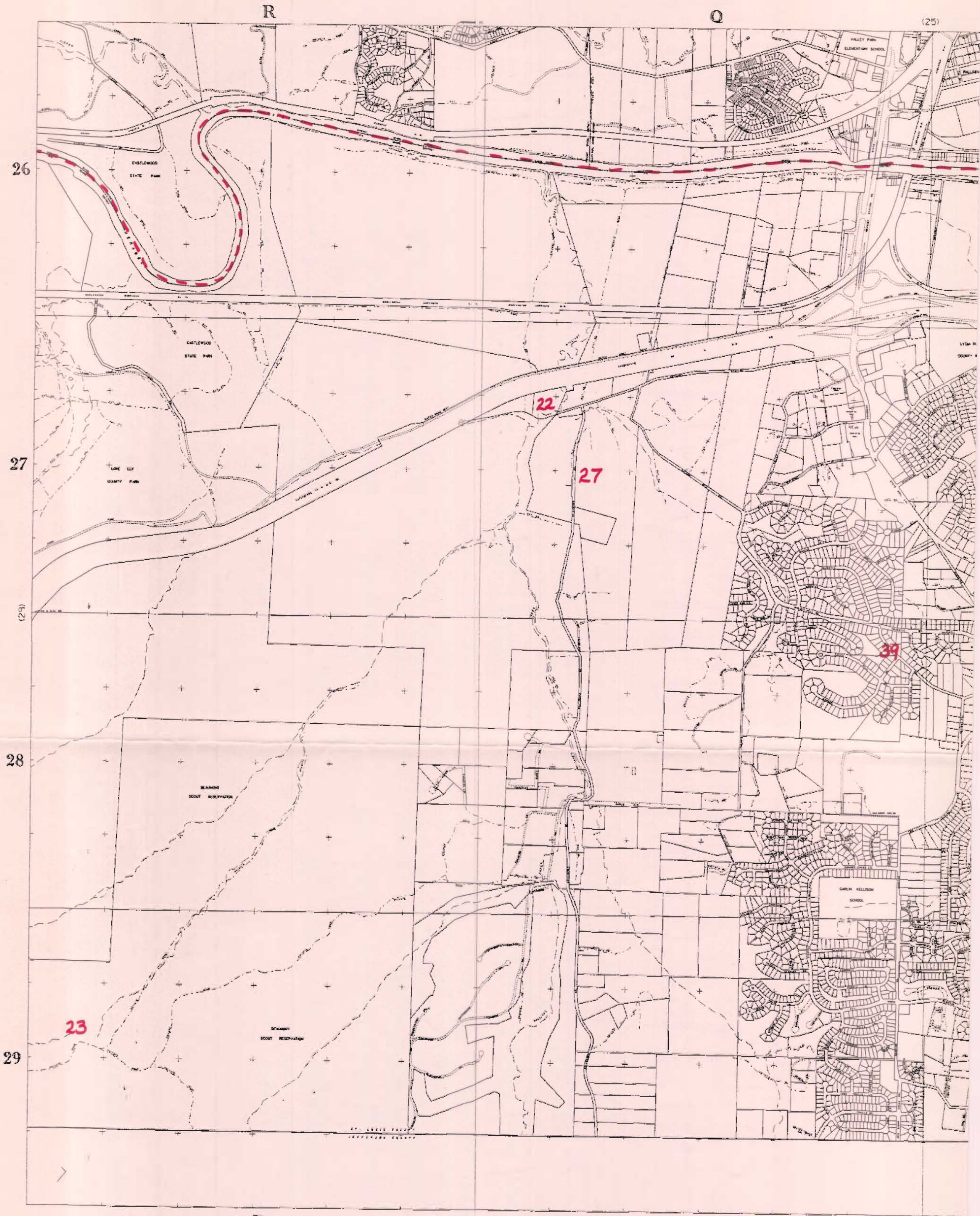

R Q  
MERAMEC RIVER SOUTH, PAGE 3  
COMPOSITE MAP SERIES  
R Q

(24)

T

S

26

27

(30)

28

29



SCALE  
1" = 800'

(34)

T

S

26-29-S-V

# MERAMEC RIVER SOUTH, PAGE 4

THE REPRODUCTION OR COPYING OF THIS MAP OR ANY PART THEREOF BY ANY PROCESS IS PROHIBITED WITHOUT WRITTEN PERMISSION OF THE DIRECTOR OF THE ST. LOUIS COUNTY DEPARTMENT OF REVENUE.

THIS MAP UPDATED:  
3-26-93

ST. LOUIS COUNTY  
REVENUE TECHNICAL SERVICES  
DIVISION OF MAPPING

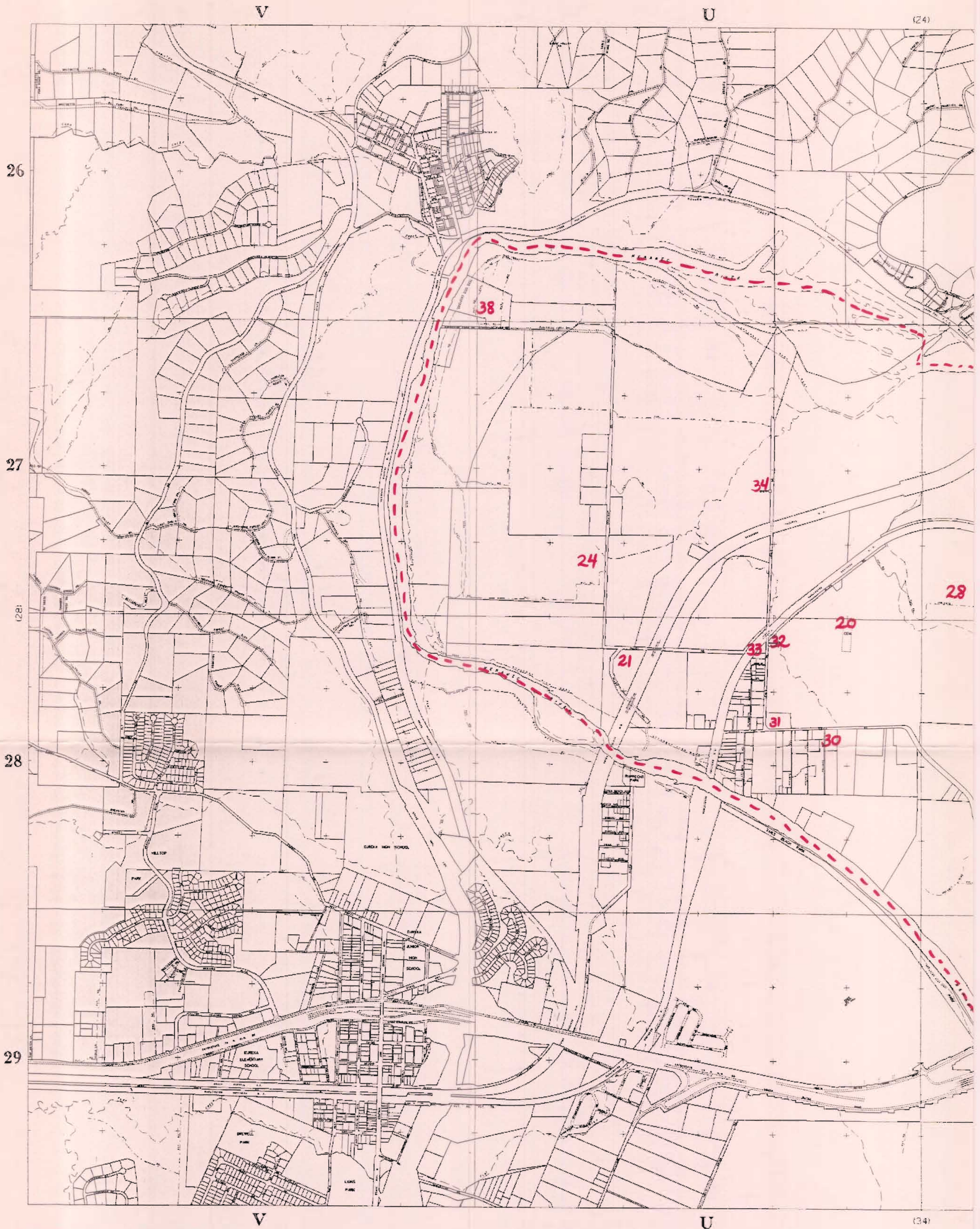

MERAMEC RIVER SOUTH, PAGE 5  
COMPOSITE MAP SERIES

977.5  
128-01

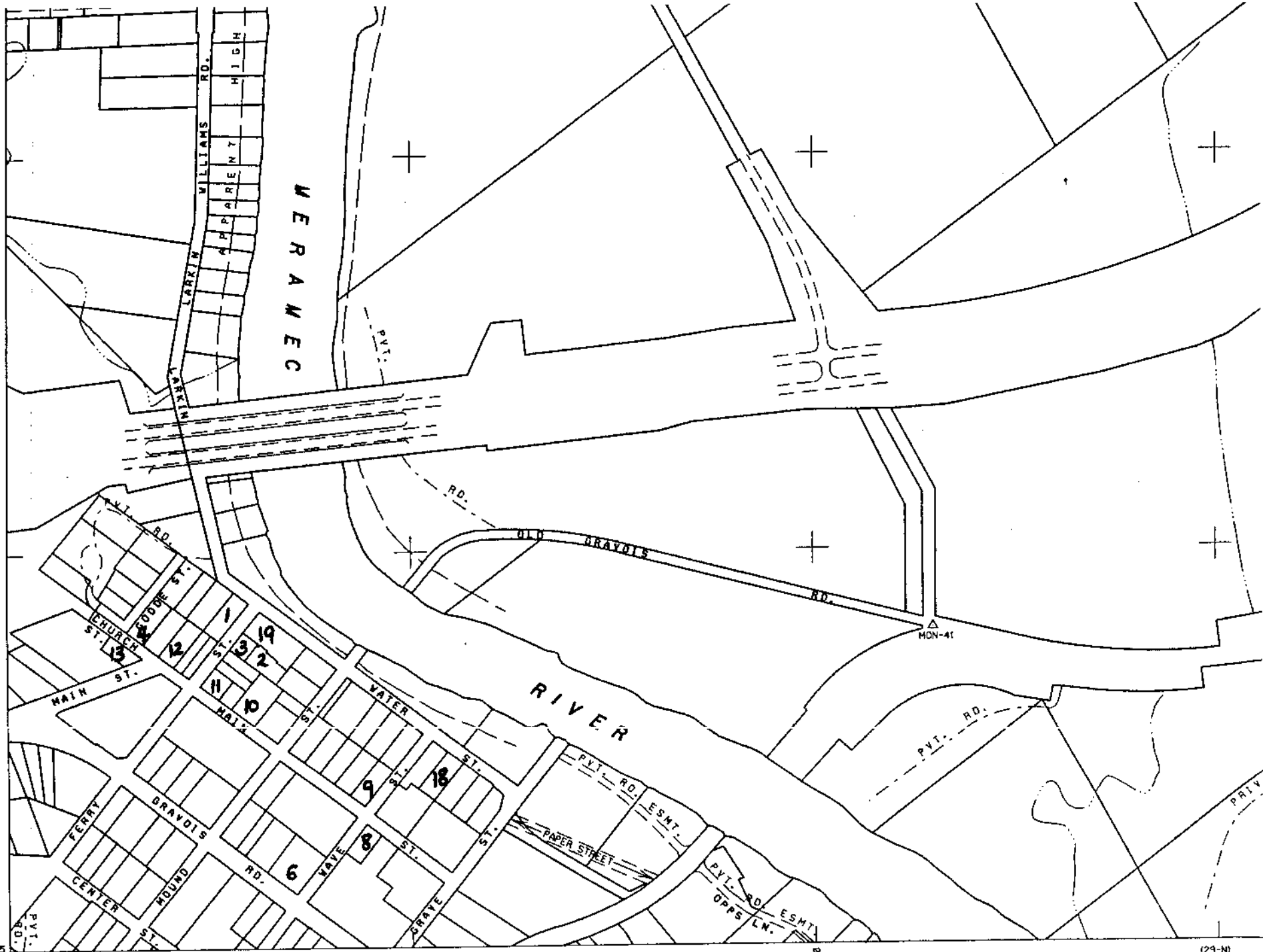

# MERAMEC RIVER SOUTH , PAGE 6

MISSOURI COORDINATE SYSTEM, EAST ZONE  
(VALUES IN THOUSANDS OF FEET)

THE REPRODUCTION  
BY ANY PROCESS  
THE DIRECTOR OF

(29-N)

PT. OF 17 SEC. 30

CRESCENT

40W.

ROAD

KENNETH  
ETAL  
3.49 AC  
(EXCL. RD)

42

3.25'

290'

1498.28' 1378.28'

1688.28'

1112.76'

762.96'

B  
FRAM  
59'8"

60'  
Dairy  
Barn  
1932-1940



PT. 28443-0058

LATT, NANCY L.

8932-1096

PT 80.48 ACRES

2718' SCALE