

United States Department of the Interior  
National Park Service

National Register of Historic Places  
Registration Form

This form is for use in nominating or requesting determinations for individual properties and districts. See instructions in *How to Complete the National Register of Historic Places Registration Form* (National Register Bulletin 16A). Complete each item by marking "X" in the appropriate box or by entering the information requested. If an item does not apply to the property being documented, enter "N/A" for "not applicable." For functions, architectural classification, materials, and areas of significance, enter only categories and subcategories from the instructions. Place additional entries and narrative items on continuation sheets (NPS Form 10-900a). Use a typewriter, word processor, or computer, to complete all items.

1. Name of Property

historic name Greenlawn Methodist Church and Cemetery

other name/site number Scobee Chapel; Greenlawn Memorial Chapel

2. Location

street & number Northeast corner of State Route J and County Road D N/A not for publication

city or town Perry X vicinity

state Missouri code MO county Ralls code 173 zip code 63462

3. State/Federal Agency Certification

As the designated authority under the National Historic Preservation Act, as amended, I hereby certify that this  nomination  request for determination of eligibility meets the documentation standards for registering properties in the National Register of Historic Places and meets the procedural and professional requirements set forth in 36 CFR Part 60. In my opinion, the property  meets  does not meet the National Register criteria. I recommend that this property be considered significant  nationally  statewide  locally. (  See continuation sheet for additional comments.)

Mark A. Miles MAY 5, 2007  
Signature of certifying official/Title Mark A. Miles/Deputy SHPO Date

Missouri Department of Natural Resources  
State or Federal agency and bureau

In my opinion, the property  meets  does not meet the National Register criteria. (  See continuation sheet for additional comments.)

\_\_\_\_\_  
Signature of certifying official/Title Date

\_\_\_\_\_  
State or Federal agency and bureau

4. National Park Service Certification

I hereby certify that the property is:

<input type="checkbox"/> entered in the National Register. <input type="checkbox"/> See continuation sheet.	Signature of the Keeper	Date of Action
<input type="checkbox"/> determined eligible for the National Register <input type="checkbox"/> See continuation sheet.	_____	_____
<input type="checkbox"/> determined not eligible for the National Register.	_____	_____
<input type="checkbox"/> removed from the National Register.	_____	_____
<input type="checkbox"/> other, (explain): _____	_____	_____

Greenlawn Methodist Church and Cemetery  
Name of Property

Ralls County, MO  
County and State

**5. Classification**

**Ownership of Property**  
(check as many boxes as apply)

**Category of Property**  
(check only one box)

**Number of Resources within Property**  
(Do not include previously listed resources in the count.)

- private
- public-local
- public-State
- public-Federal

- building(s)
- district
- site
- structure
- object

Contributing	Noncontributing	
1	1	buildings
1		sites
		structures
		objects
2	1	Total

**Name of related multiple property listing**  
(Enter "N/A" if property is not part of a multiple property listing.)

**Number of contributing resources previously listed in the National Register**

N/A

0

**6. Function or Use**

**Historic Function**  
(Enter categories from instructions)

Religion: religious facility

Funerary/Cemetery

---

---

---

---

---

---

---

---

**Current Function**  
(Enter categories from instructions)

Religion: religious facility

Funerary/Cemetery

---

---

---

---

---

---

---

---

**7. Description**

**Architectural Classification**  
(Enter categories from instructions)

Other: Gable end church building

---

---

---

---

**Materials**  
(Enter categories from instructions)

foundation STONE

walls WOOD: weatherboard

roof METAL

other \_\_\_\_\_

**Narrative Description**

(Describe the historic and current condition of the property on one or more continuation sheets.)

See continuation sheet(s) for Section No. 7

Greenlawn Methodist Church and Cemetery  
Name of Property

Ralls County, MO  
County and State

### 8. Statement of Significance

#### Applicable National Register Criteria

(Mark "x" in one or more boxes for the criteria qualifying the property for National Register listing.)

- A** Property is associated with events that have made a significant contribution to the broad patterns of our history.
- B** Property is associated with the lives of persons significant in our past.
- C** Property embodies the distinctive characteristics of a type, period, or method of construction or represents the work of a master, or possesses high artistic values, or represents a significant and distinguishable entity whose components lack individual distinction.
- D** Property has yielded, or is likely to yield, information important in prehistory or history.

#### Criteria Considerations

(Mark "x" in all the boxes that apply.)

Property is:

- A** owned by a religious institution or used for religious purposes.
- B** removed from its original location.
- C** a birthplace or grave.
- D** a cemetery.
- E** a reconstructed building, object, or structure.
- F** a commemorative property.
- G** less than 50 years of age or achieved significance within the past 50 years.

#### Narrative Statement of Significance

(Explain the significance of the property on one or more continuation sheets.)

See continuation sheet(s) for Section No. 8

### 9. Major Bibliographical References

#### Bibliography

(Cite the books, articles, and other sources used in preparing this form on one or more continuation sheets.)

#### Previous documentation on file (NPS):

- preliminary determination of individual listing (36 CFR 67) has been requested
- previously listed in the National Register
- previously determined eligible by the National Register
- designated a National Historic Landmark
- recorded by Historic American Buildings Survey # \_\_\_\_\_
- recorded by Historic American Engineering Record # \_\_\_\_\_

#### Areas of Significance

(enter categories from instructions)

ARCHITECTURE

SOCIAL HISTORY

#### Period of Significance

c. 1885-1920

#### Significant Dates

N/A

#### Significant Persons

(Complete if Criterion B is marked above)

N/A

#### Cultural Affiliation

N/A

#### Architect/Builder

Unknown

#### Primary location of additional data:

- State Historic Preservation Office
- Other State agency
- Federal agency
- Local government
- University
- Other Name of repository: \_\_\_\_\_

See continuation sheet(s) for Section No. 9

Greenlawn Methodist Church and Cemetery  
Name of Property

Ralls County, MO  
County and State

**10. Geographical Data**

**Acreeage of Property** 1 acre

**UTM References**  
(Place additional boundaries of the property on a continuation sheet.)

1 <u>1/5</u> <u>6/1/3/0/1/0</u> <u>4/3/7/0/6/2/5</u> Zone    Easting    Northing	2 <u>/</u> <u>/ / / / /</u> <u>/ / / / /</u> Zone    Easting    Northing
3 <u>/</u> <u>/ / / / /</u> <u>/ / / / /</u> Zone    Easting    Northing	4 <u>/</u> <u>/ / / / /</u> <u>/ / / / /</u> Zone    Easting    Northing

**Verbal Boundary Description**  
(Describe the boundaries of the property.)

Property Tax No.

**Boundary Justification**  
(Explain why the boundaries were selected.)

See continuation sheet(s) for Section No. 10

**11. Form Prepared By**

name/title Marsha Norris Knudsen (also see continuation sheet)  
organization Chair, Greenlawn Chapel Restoration Project      date August 11, 2006  
street & number 7750 N. Wade School Road      telephone 573-443-1672  
city or town Columbia      state MO    zip code 65202

**Additional Documentation**

Submit the following items with the completed form:

- Continuation Sheets**
- Maps** A USGS map (7.5 or 15 minute series) indicating the property's location.  
A **Sketch map** for historic districts and properties having large acreage or numerous resources.
- Photographs:** Representative **black and white photographs** of the property.
- Additional items:** (Check with the SHPO or FPO for any additional items)

**Property Owner**

name/title Greenlawn Cemetery Board, Paul Dean Wasson, President  
street & number 1242 East Main Street      telephone \_\_\_\_\_  
city or town Perry      state MO    zip code 63462

**Paperwork Reduction Act Statement:** This information is being collected for applications to the National Register of Historic Places to nominate properties for listing or determine eligibility for listing, to list properties, and to amend existing listings. Response to this request is required to obtain a benefit in accordance with the National Historic Preservation Act, as amended (16 U.S.C. 470 et seq.).

**Estimated Burden Statement:** Public reporting burden for this form is estimated to average 18.1 hours per response including time for reviewing instructions, gathering and maintaining data, and completing and reviewing the form. Direct comments regarding this burden estimate or any aspect of this form to the Chief, Administrative Services Division, National Park Service, P.O. Box 37127, Washington, DC 20013-7127; and the Office of Management and Budget, Paperwork Reductions Projects (1024-0018), Washington, DC 20503.

United States Department of the Interior  
National Park Service

## National Register of Historic Places Continuation Sheet

Section number 7 Page 1

Greenlawn Methodist Church and Cemetery  
Ralls County, Missouri

---

### Summary:

The Greenlawn Methodist Church and Cemetery are located on the northeast corner of the intersection of State Route J and County Road D, approximately 3 miles northwest of Perry, Ralls County, Missouri. Built c. 1883, this gable front church sits on stone piers. The rectangular frame building retains its original clapboard siding and 2/2 wood sash windows. An associated cemetery surrounds the church on the front and sides. The cemetery contains 196 graves with stones dating from 1883 to the present. The building and cemetery are well maintained and retain a high degree of integrity.

### Setting:

The church and cemetery were once part of a small settlement community containing small businesses, a one-room schoolhouse and several residential properties. The school and remnants of a general store building were still intact in the early 1980s, however, the school has since been demolished. Though there are scattered farmhouses nearby, the church and cemetery are the last remaining public or institutional properties representing the history of the Greenlawn community. Agricultural land containing scattered trees and vegetation now surrounds the church and cemetery.

### Building (Exterior):

Constructed by local builders c.1883, the church is representative of the vernacular rural architecture of the 1880s and has little exterior decoration. Simple pedimented hoods with plain surrounds highlight the doors and windows. The building is a single-story frame, gable front church with a rectangular footprint measuring 26 1/2' by 40 1/2'. Native timber sills on 8-inch stone piers support the building. The frame church retains its original clapboard siding on all sides. The siding is in good condition and has recently been repainted.

Though the building has been reroofed with asphalt shingles, original wood shingles are still in place under the new layer. A brick chimney for a wood stove straddles the roof peak near the center of the building.

The primary (west) façade has little architectural detail. The original horizontally laid siding extends to the peak of the medium pitched gable roof. The corner boards protecting the ends of the siding are flat topped with stylized Doric capitals. The roof has a box cornice and plain fascia. A double door is centered in the façade. The doors are not original, but the opening retains its original surround and two-light transom. A concrete step with broad stoop leads to the entrance. A gooseneck electric light fixture is centered several feet above the door.

United States Department of the Interior  
National Park Service

## National Register of Historic Places Continuation Sheet

Section number 7 Page 2

Greenlawn Methodist Church and Cemetery  
Ralls County, Missouri

---

The north and south elevations (see photos #5 and #7) are nearly identical. Each has three evenly spaced windows for natural light and ventilation. All windows are original 2/2 double hung sashes with pediment hoods and plain surrounds. The foundation under the north wall was stabilized in 2005 to prevent additional settling.

The east (rear) façade has no fenestration. White-painted clapboards cover the wall from foundation to the peak of the gable.

### Interior:

Like the exterior, the chapel's sanctuary has seen little change since the construction of the building c. 1883. The interior consists of a single room with high arched ceiling of tongue and groove pine boards. The walls are twelve-foot high with a 40-inch wainscoting along the bottom and plaster above. The floor is original and constructed of 6-inch pine boards. On the east wall there is a semi-circular stage approximately 8 1/2 feet long and 6-feet deep at its widest point. It is approximately 8-inches higher than the surrounding floor. The original oak bible-stand and two oak lamp stands are located on the stage.

In the main portion of the sanctuary, the original slat-backed pews are still in place. One pew is natural wood and sets on the stage behind the bible stand. Two sets of nine pews flank the center aisle and two additional pews are located on either side of the stage. These twenty-two original pews are painted white and have diamond-shaped, beveled wood decorations applied on the center and end of the high arms. Bare bulbs on wires hang from the ceiling for lighting.

### Outbuilding:

The church is still served by outdoor plumbing. The original privy has been replaced by a more modern structure. The roofed privy is 5' X 5' and is covered with vertical siding. The privy is non-contributing to the site.

### Alterations:

The church has changed very little since its construction. The original wooden shingle roof is still on the church but has been covered with a new 29-gauge strong panel painted steel roof installed in the fall of 2006. The sill on the north side has been stabilized by positioning concrete pads under the rock foundation to prevent settling. The wooden front steps have also been replaced with a concrete stoop. The building was original heated with two cast iron box stoves that have since been removed. In the 1940s's the original kerosene lamps that hung on the walls were replaced by electric lights hanging from the center of the ceiling. Overall the changes to the original structure are minimal and have not impacted the overall integrity of this rural frame church building.

United States Department of the Interior  
National Park Service

## National Register of Historic Places Continuation Sheet

Section number 7 Page 3

Greenlawn Methodist Church and Cemetery  
Ralls County, Missouri

---

The building recently underwent a major maintenance campaign. The building has been painted inside and out and the north foundation stabilized. The original pews have been repaired and repainted. The community has also developed a maintenance schedule for continued monitoring and maintenance of the chapel. Future plans include the replacement of the non-original front doors, roof repair, better electrical service and the replacement of the lost kerosene lamps and stoves. The plan is to use the building for community meetings, memorial services, and school visits.

### **Cemetery:**

The one-acre contributing cemetery surrounds the church on the north, south, and east sides. The cemetery contains 196 graves, most of which are marked by granite stones, though others have metal or limestone markers. Graves are laid out in parallel rows and most markers face west. The earliest grave marker dates from 1883, soon after the church was organized and the land donated for church construction. Though not necessarily characteristic of rural churchyards, cemeteries are commonly associated with the property type and the Greenlawn Cemetery contributes to the overall character and integrity of the church. A wire and chain-link fence with gate encompasses the cemetery. Though the current fence is new, the property has been fenced since c. 1900.

United States Department of the Interior  
National Park Service

# National Register of Historic Places Continuation Sheet

Section number 7 Page 4

Greenlawn Methodist Church and Cemetery  
Ralls County, Missouri

Figure 1: Greenlawn Methodist Church and Cemetery Site Plan  
Drawn by Marsha Knudsen  
Not to scale

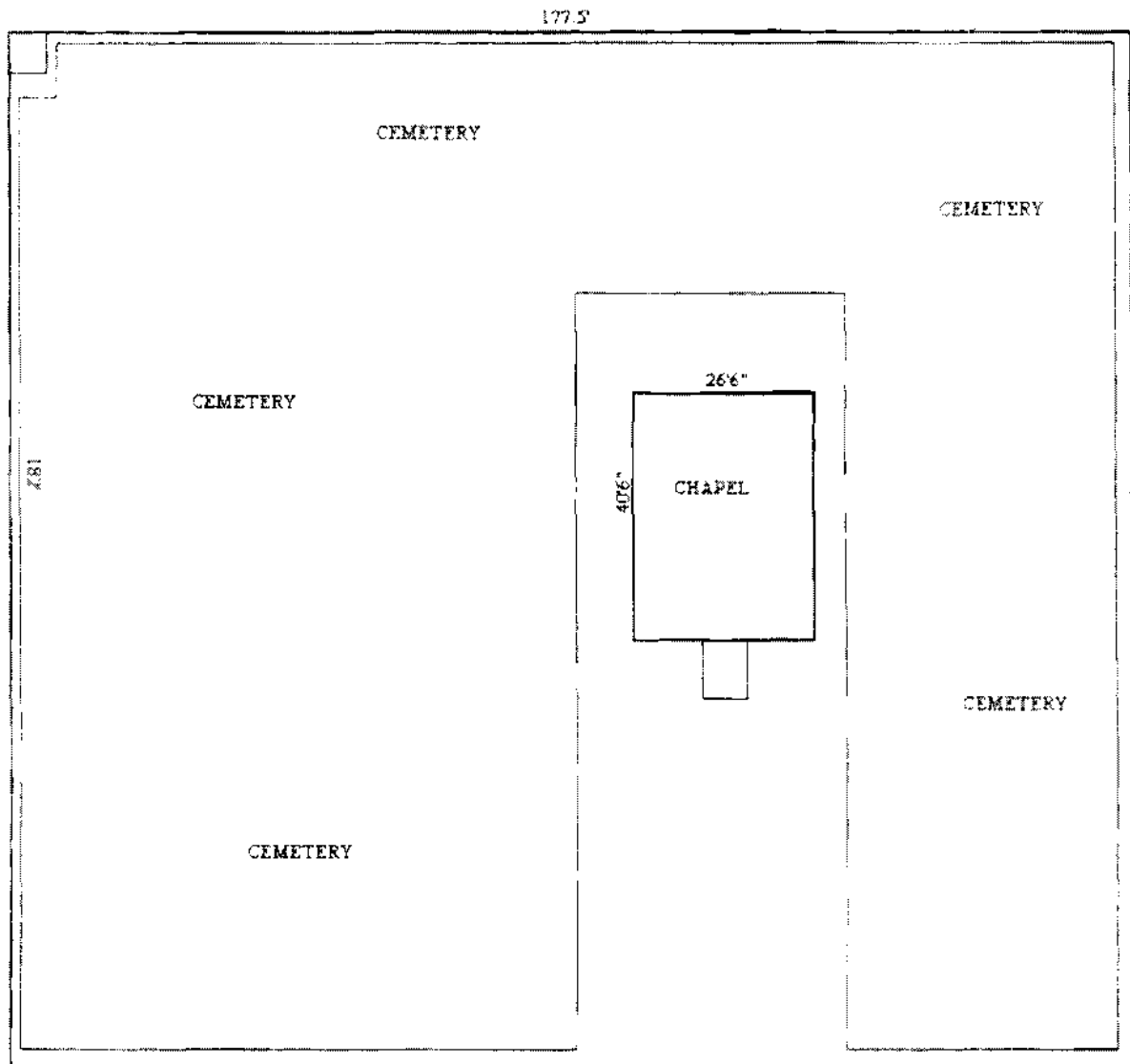

United States Department of the Interior  
National Park Service

# National Register of Historic Places Continuation Sheet

Section number 7 Page 5

Greenlawn Methodist Church and Cemetery  
Ralls County, Missouri

Figure 2: Greenlawn Methodist Church and Cemetery Floor Plan  
Drawn by Marsha Knudsen  
Not to scale

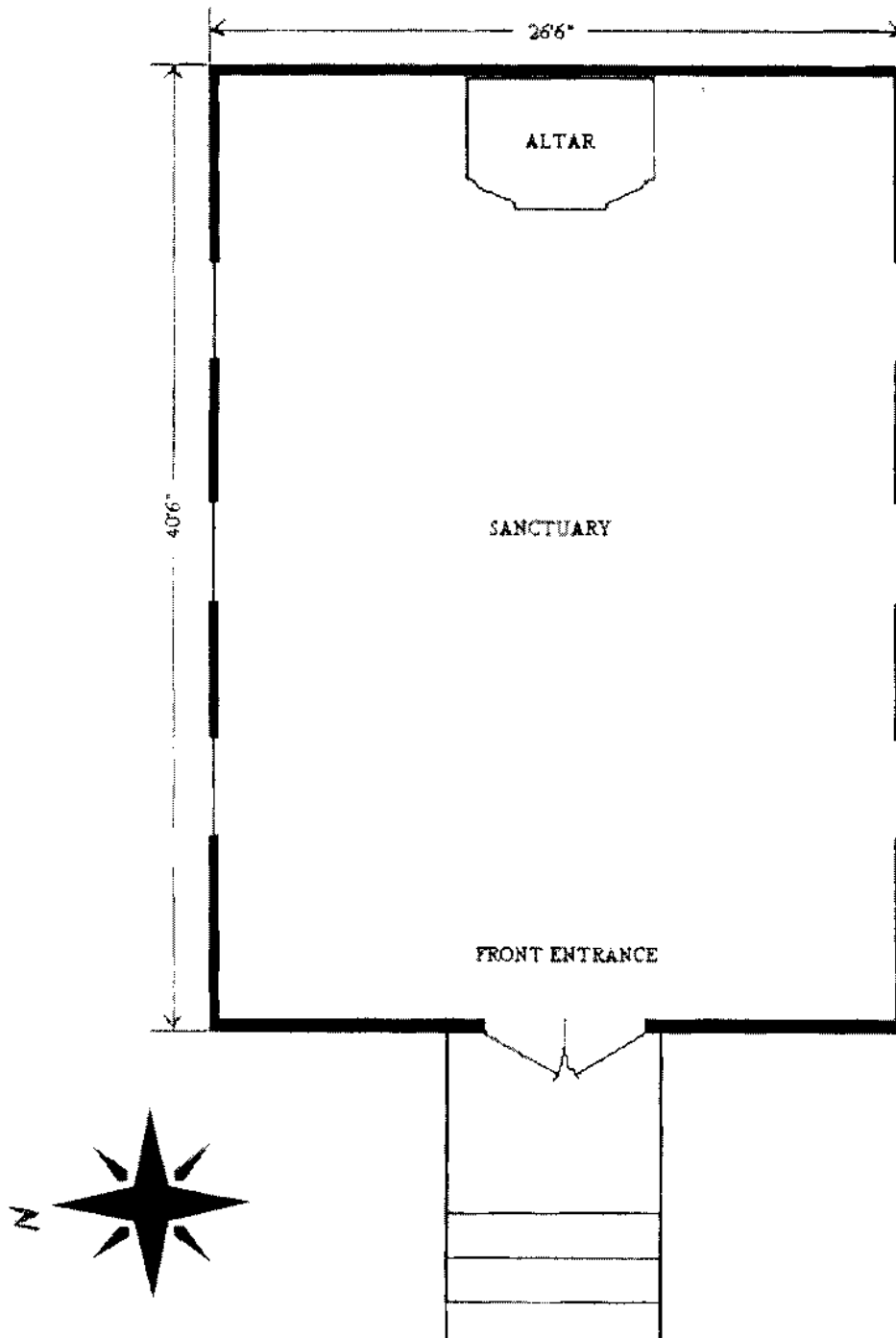

United States Department of the Interior  
National Park Service

## National Register of Historic Places Continuation Sheet

Section number 8 Page 6

Greenlawn Methodist Church and Cemetery  
Ralls County, Missouri

---

### Summary:

The Greenlawn Methodist Church and Cemetery, located at the northeast corner of the intersection of Route J and CR D, in Ralls County, is locally significant under National Register Criteria A and C in the areas of Social History and Architecture. The building meets the requirements of criterion consideration A because it takes its primary significance from its architecture and historic social associations rather than its religious history. Constructed in c. 1885, the Greenlawn Methodist Church became the center of social activity for the small community of Greenlawn, hosting community social gatherings in addition to weekly religious services. As a free burial ground open to all who request burial there, it is also the final resting place of many of the citizens of Greenlawn and the surrounding agricultural community. The modest church is a representative example of the frame gable-end church type commonly associated with rural churches. Unlike other examples of the property type which have been expanded or extensively modified, the Greenlawn Methodist Church remains virtually unaltered from its period of significance. Today it stands as the oldest frame church building in Ralls County and one of only 2 intact historic frame gable-end church buildings in the county. The period of significance is c. 1885 to 1920, the date of construction to the year the church end full time Methodist services in the building.

### History and Background:

Ralls County was organized in 1820 and was carved out of Pike County. After this date, homesteading began in earnest as cheap land gave people from Virginia and Kentucky the incentive to travel up the Mississippi River and settle in Ralls County.<sup>1</sup>

Ann Carter first purchased the land on which the Greenlawn Methodist Church stands from the US Government on January 1, 1830. The next year (on July 6, 1831), Ann deeded the property to her son Robert "in consideration of her love and affection form him."<sup>2</sup> On May 1, 1856, Robert Carter sold the property to John Henry Shepherd and his wife Sarah. Carter, a Union sympathizer, was shot and killed by Confederates in his own dooryard just four years later.<sup>3</sup>

The Shepherds added the Carter property to their homestead and dwelt there for several decades. Mr. Shepard was an early settler in Ralls County and was prominent in the affairs of the county and township. Soon after settling in the county, Shepard became the constable of Township 54 and boasted that he knew every man within its limits. On January 20, 1862, Mr. Shepard enlisted in the Union army as a private in Company E, Second Regiment of Missouri Calvary. He received an honorable discharge on May 12, 1865.<sup>4</sup>

---

<sup>1</sup> Golenda Howard. *Ralls County, Missouri*. Walsworth: Marceline, MO, 1980, 196.

<sup>2</sup> Book of the original Entries on file in the office of the Recorder of Deeds, Ralls County Courthouse, new London, Missouri.

<sup>3</sup> "Church will Celebrate 100 Years," *Twainland Enterprise*, September 22, 1983, p. 1.

<sup>4</sup> *Ibid.*

United States Department of the Interior  
National Park Service

## National Register of Historic Places Continuation Sheet

Section number 8 Page 7

Greenlawn Methodist Church and Cemetery  
Ralls County, Missouri

Mr. and Mrs. Shepard had no children of their own, but adopted several "to whom they stood in the light of parents."<sup>5</sup> John was a member of the Christian church and Sarah was a Methodist. Both took great interest in the religious affairs of the area. When the community felt the need for a local church John and Sarah deeded one acre of their farm as a "gift for church purposes." On August 10, 1882, title to the property was transferred from John and Sarah Shepard to the "Trustees of Methodist Episcopal Church South at Scobees Chappel [sic]."<sup>6</sup> A local committee met at the Norton School and organized the church. Members of the committee that organized the chapel were Henry Utterback, John W. Scobee, Mary Scobee, John Pruett, America Crawford, William Austin Utterback, Frances Utterback and Amanda Scobee.<sup>7</sup>

The new church building was dedicated in 1885 under the name "Greenlawn Methodist Church."<sup>8</sup> Though not the earliest Methodist congregation in the county, this early dedication date makes the Greenlawn Methodist Church the oldest extant Methodist church building in Ralls County.

Since its organization in 1883, numerous pastors have served the church. The first recorded pastor was Reverend J.P. Godboy who came to the church in 1885. Other ministers in the early 1900's included Brother Maughs, and the reverends Roberts, Davis and Borden. The Rev. Paul K. Holland was the last Methodist minister to serve the church. His term began in 1918 and ended in 1920. In 1941, the Works Projects Administration surveyed Ralls County and wrote that:

The church had regular Sunday School and was very active for several years, but about the year 1920 ceased to exist, and the building was turned over to the Christian Denomination and Reverend John W. Golden, of Hannibal, preaches there once a month. The Methodist members reserving the right to hold meetings or social affairs at any time.<sup>9</sup>

The church later became a Union church and several denominations held services there.<sup>10</sup> For several years the church was part of the pastoral circuit and many ministers of several denominations held services in the building.

Title to the church property was vested with the Methodist Church at their annual conference. Even though the church changed denominations from Methodist to Christian to Union, ownership of the property stayed with the Methodist Church until November 19, 1971. At the

<sup>5</sup> Ibid.

<sup>6</sup> Deedbook 37, p. 525, Ralls County Courthouse, New London, Missouri.

<sup>7</sup> "Survey of State and Local Historical Records." Works Projects Administration (WPA). Western Historical Manuscript Collection: Columbia, Missouri, August 27, 1941, Vol. 1, p. 7561.

<sup>8</sup> Dee Paul West. *The End of a Way of Life*. Herald Publishing Company: ?, Missouri, [1965], p. 44.

<sup>9</sup> WPA, p. 7561.

<sup>10</sup> Howard, 171.

United States Department of the Interior  
National Park Service

## National Register of Historic Places Continuation Sheet

Section number 8 Page 8

Greenlawn Methodist Church and Cemetery  
Ralls County, Missouri

time, the following motion was made at the United Methodist Church Annual meeting: "Motion was made by Damon Cox that the Greenlawn Church Property, Route #2, Perry, Mo. be deeded to Greenlawn Cemetery Association."<sup>11</sup> The Greenlawn Cemetery Association has maintained ownership since that time.

### Social History:

The early history of the settlement of the Greenlawn Community is sketchy. There was sufficient population in the area to establish a post office in Greenlawn (then Green Lawn) in 1863. The post office closed in April 1865 and remained defunct for several years. It reopened in 1888 and served the area until 1904.<sup>12</sup>

The 1878 atlas of Ralls County shows little in the area of Greenlawn other than farms and scattered housing.<sup>13</sup> The 1880s marked a period of prosperity and development for the small Greenlawn community. In addition to the reopening of the post office, the community gained two institutional buildings: the Greenlawn School (c. 1880) and the Greenlawn Methodist Church (c. 1885). Both the church and school were small rectangular frame buildings with front facing gables. Built directly across from one another, the buildings marked the crossroads of the small community and were part of a cluster of residential and commercial buildings that served a larger agricultural community.

The early 1900s were the busiest years for the Greenlawn community. By 1905, Greenlawn had a population of 18 and boasted 10 institutions/businesses: a blacksmith shop, drygoods store, general store, millinery, post office, saw mill, school, storehouse, wagon wheel factory, and church.<sup>14</sup> The school, church and business can be seen as a cluster of buildings on the 1904 Ralls County atlas (see Figure 3, below).

The area newspaper, the *Perry Enterprise*, recognized the significance of the small settlement. Beginning in 1900, the *Perry Enterprise* published "Greenlawn Items," a column containing news and announcements about the Greenlawn community. The columnist was boastful of the quality of the community, writing that

Our town is represented with good polite merchants. We have a good blacksmith, fine preacher, a good schoolteacher. Good neighbors, too. Why not live in Green Lawn and be happy all the time!<sup>15</sup>

<sup>11</sup> Letter from George Heslar to Neal Yancy, November 29, 1971. On file with Marsha Knudsen.

<sup>12</sup> Dee Paul West. *The End of a Way of Life*. Herald Publishing Co.: Shelbyville, MO, [1965], p. 27.

<sup>13</sup> *An Illustrated Historical Atlas of Ralls County, Missouri 1878*. Reprinted by Wilham and Corbin Books: Shelbyville, MO, 1985.

<sup>14</sup> *Twainland Enterprise*.

<sup>15</sup> "Greenlawn Items," *Perry Enterprise*, 1906.

United States Department of the Interior  
National Park Service

## National Register of Historic Places Continuation Sheet

Section number 8 Page 9

Greenlawn Methodist Church and Cemetery  
Ralls County, Missouri

In addition to general community news, these columns often highlighted church events and denote the importance of the church in the small community.

Figure 3: Greenlawn, 1904.<sup>16</sup>

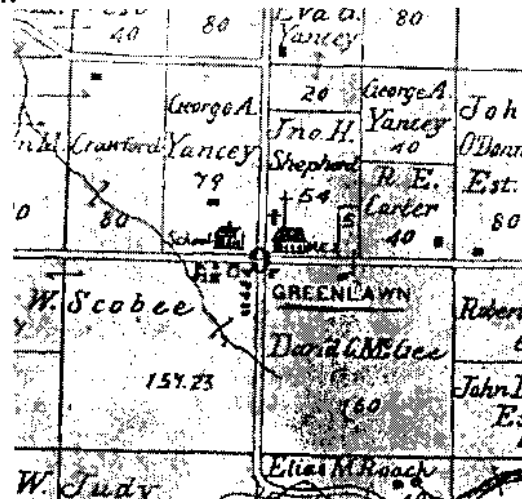

In addition to invitations to Sunday services, such as Brother Maugh's invitation to 11 o'clock services in 1900, the Perry Enterprise "Greenlawn Items" column also announced and reported on special events. In 1900 the column included the announcement of a "Singing and Sunday School" at which 43 people were in attendance. Ice cream suppers were also common events at the church and announcements for such events were provided in 1900 and again in 1902. In 1902, an "ice cream and fresh oyster supper" was held was for the "benefit of the church." A later a box supper netted \$10.75 to purchase blinds for the windows of the church. Though the events at the church were generally to raise funds for improvements, all were invited to attend. In 1902, for example, the column announced a box supper and requested that "Everybody come and bring well filled boxes." More private events and celebrations also occurred in the building, such as the 61<sup>st</sup> birthday part hosted by the family of Mrs. W.A. Utteback of "near GL [Greenlawn]." "Her children and relatives surprised her at the church with an excellent surprise dinner" in 1902.<sup>17</sup>

The Greenlawn Cemetery was also a focal point of community activity and a significant local site. Established in 1883, the cemetery was not just for those who attended the Greenlawn Methodist Church. Instead, the churchyard was open, free of charge, to anyone who requested to be buried there. However, members of the church and the family of those buried there were expected to help maintain the cemetery grounds. In a "Greenlawn Items" column of 1900, Rev. Borden announced "that on Friday, [they] would meet for the purposes of cleaning off the graves

<sup>16</sup> *An Illustrated Historical Atlas of Ralls County, Missouri 1904*. Republished by Wilham and Corbin: Shelbyville, MO, 1986.

<sup>17</sup> "Greenlawn Items," *Perry Enterprise*, 1902.

United States Department of the Interior  
National Park Service

## National Register of Historic Places Continuation Sheet

Section number 8 Page 10

Greenlawn Methodist Church and Cemetery  
Ralls County, Missouri

in the cemetery. All those who have relatives buried there will be expected to attend." In addition to natural vegetation and weather, the church and cemetery had to contend with more unique maintenance issues. In 1901, JM Crawford put a wire fence around the church and cemetery "as livestock keeps getting in there every week."<sup>18</sup>

Burials of community members were also times to gather together as a community. The first burial in the cemetery was the wife of Henry Utterback. Mr. Utterback was one of the charter members of the Scobee Chapel/Greenlawn Methodist Church. The "Greenlawn Items" column also announced the burial of several important community members in the Greenlawn cemetery. In 1902, "a large crowd gathered Friday at GL cemetery to prepare a resting place for R.J. Nelson, a close and dear friend." In 1906, "everybody in this community that was able attended Uncle John Shepherd's funeral." Mr. Shepherd donated the land on which the cemetery and church are located.

The community of Greenlawn went into decline after c. 1920. Improved roads and the automobile made it easier to travel to Perry (approximately 3 miles to the south). The Greenlawn Methodist Church closed its doors to full time services in that year. After 1920, services conducted by a Christian (denomination) minister were held in the chapel about once a month, and these ceased by the 1970s. The neighboring district school closed in the 1950s and by this time most of the businesses had closed and the buildings were torn down. The school building was torn down in the 1990s, leaving the Greenlawn Church and Cemetery as the last remaining building representing the once thriving Greenlawn settlement.

### Church Architecture in Ralls County

At this time, there is no extensive survey of Ralls County architecture. References on Ralls County history, however, provide some information on the county's churches and church buildings. Golenda Howard, for example, noted that over 80 congregations have served the county.<sup>19</sup> Her book provides a brief description of over 70 of these congregations and their associated church buildings. Several of the churches or congregations described by Howard were defunct and no longer had extant associated buildings at the time of the publication of her book in 1980. She references the 1941 WPA survey of churches that identified 54 churches with active congregations or extant buildings.<sup>20</sup> Several of these have since closed and their buildings have been converted to other uses, abandoned or razed.

Based on Howard's descriptions of churches (few if any are photographed), several of Ralls County's congregations went through a succession of buildings. The congregation of St. Paul Catholic Church, for example, began meeting in private residences in 1826. In 1834 the congregation constructed a log building to house services and a large limestone building was

<sup>18</sup> "Greenlawn Items," *Perry Enterprise*, 1901.

<sup>19</sup> Golenda Roland Howard. *Ralls County, Missouri*. Walsworth: Marceline, MO, 1980, 162.

<sup>20</sup> *Ibid.*

United States Department of the Interior  
National Park Service

## National Register of Historic Places Continuation Sheet

Section number 8 Page 11

Greenlawn Methodist Church and Cemetery  
Ralls County, Missouri

constructed in 1860.<sup>21</sup> Its sister church, St. Peter's (c. 1862) followed a similar development pattern. These two churches are constructed of limestone and are the earliest extant church buildings in the county. Both are listed on the National Register of Historic Places. Other churches have followed a similar development pattern, starting in private homes or school buildings before constructing log, frame or masonry buildings to house services. Before constructing the Greenlawn Methodist Church, members organized at the Norton School building located approximately 2 miles north of the present location of the church building.

Some churches built a succession of church buildings to house growing congregations. The Bethel Baptist Church in Spencer Township, for example, is known to have had three separate church buildings in at least two locations.<sup>22</sup> Howard identified 21 churches constructed in the 20<sup>th</sup> Century, most of which had earlier, 19<sup>th</sup> Century church, buildings.<sup>23</sup> Also common was expansion of or alterations to existing 19<sup>th</sup> Century church buildings. St. Peter's and St. Paul Catholic churches both received additions in the late 19<sup>th</sup> or early 20<sup>th</sup> Centuries.<sup>24</sup> Union Chapel Christian Church, constructed in 1899, had alterations or additions made in 1927, 1958, and 1961.<sup>25</sup> Similar examples of modified 19<sup>th</sup> Century church buildings can be found throughout the county. As of 2002, there were roughly 18 extant (or possibly extant) 19<sup>th</sup> Century churches in Ralls County. At least 10 of these are known to have been modified by new additions or changes to exterior wall cladding. Greenlawn Methodist Church is one of the few unmodified 19<sup>th</sup> Century church buildings in the county.

In addition to being highly intact and unmodified, Greenlawn Methodist Church is also a representative example of the gable-end church property type in the county. It should be noted that the gable-end church type was and continues to be a common church building type. According to Jennings and Gottfried, "The *gable-end* church is a widely diffused building, especially in rural areas; its simple gable roof and end wall have been suitable for many denominations."<sup>26</sup> Gable-end churches are generally frame and clad in clapboards, shingles or board and batten siding, although examples in brick and stone are also common.<sup>27</sup> In Ralls County, extant examples of the property type date from as early as 1860 (St. Paul Catholic Church, a limestone example) into the 1950s (New London Baptist Church, a brick example).

Variations of the gable-end church type abound, but the Greenlawn Methodist Church is an

<sup>21</sup> Judy Couch and Noelle Soren. "St. Paul Catholic Church." National Register of Historic Places Nomination Form, 1979.

<sup>22</sup> Ron Leake. "Ralls County Missouri Churches Listing," 7/2002. Accessed 12/20/06 at <http://www.rootsweb.com/~morchs/churches.htm>.

<sup>23</sup> Howard, multiple pages.

<sup>24</sup> Couch and Soren.

<sup>25</sup> Howard.

<sup>26</sup> Jan Jennings and Herbert Gottfried. *American Vernacular Design, 1870-1940*. New York: Van Nostrand Reinhold Co., 1985, p. 393.

<sup>27</sup> Ibid.

United States Department of the Interior  
National Park Service

## National Register of Historic Places Continuation Sheet

Section number 8 Page 12

Greenlawn Methodist Church and Cemetery  
Ralls County, Missouri

increasingly rare unaltered 19<sup>th</sup> century frame example of the church type. Gottfried and Jennings characterized the property type as a clapboard-clad building with gable roof. Many examples of the church have short steeples, but steepleless versions such as Greenlawn are also typical of the type. Additionally, gable-end churches have pointed or peaked window heads and paired front doors.<sup>28</sup>

Greenlawn is a modest example of the gable-end church type. Its simple design likely reflects the carpentry ability of the congregation unaided by architect or master builder. The building is of frame construction with original wood clapboard siding. The windows on the north and south elevations have simple pedimented hoods reflective of the peaked heads that characterize the gable-end church property type. Though the front doors are modern, they are still double leaf as is common of gable-end churches. That the church has remained intact with only minor alterations is uncommon for churches of its age in Ralls County. The building retains integrity to its period of significance and represents both the community of Greenlawn and rural church architecture in the county.

### **Current Status of the building:**

Changing times have affected the use and condition of the Greenlawn Methodist Church. The last regular church service was held in the building in the 1940s and the last wedding was conducted there in 1976. The building was repainted during the 1976 Bi-Centennial celebration and its 100<sup>th</sup> Anniversary was celebrated in 1983. Since 1983, the building and cemetery have only been used for burials that occurred each year in the adjacent, contributing, cemetery. The lack of use caused the building to deteriorate to the extent that in November of 2003, the Cemetery Board voted to tear down the building. The demolition plan came to the attention of some of the descendants of the Greenlawn community, and at the November 2004 board meeting they asked permission to restore the chapel. The board allowed one year for fund-raising and repair.

Organizing as the "Friends of Greenlawn Chapel," a group of people raised \$6500 from 49 private donations. Over 400 hours of work by 20 volunteers stretched these funds. Work completed includes painting of the exterior and interior of the building and stabilization of the foundation to prevent further settling. The building was rededicated on Memorial Weekend in May 2006.

---

<sup>28</sup> Herbert Gottfried & Jan Jennings. *American Vernacular Design, 1870-1940*. Iowa State UP: Ames, IA, 1988, 250.

United States Department of the Interior  
National Park Service

## National Register of Historic Places Continuation Sheet

Section number 9 Page 13

Greenlawn Methodist Church and Cemetery  
Ralls County, Missouri

---

### Bibliography

*An Illustrated Historical Atlas of Ralls County, Missouri 1878.* Reprinted by Wilham and Corbin Books: Shelbyville, MO, 1985.

*An Illustrated Historical Atlas of Ralls County, Missouri 1904.* Republished by Wilham and Corbin: Shelbyville, MO, 1986.

"Church will Celebrate 100 Years," *Twainland Enterprise*, September 22, 1983, p. 1

Couch, Judy and Noelle Soren. "St. Paul Catholic Church." National Register of Historic Places Nomination Form, 1979.

Deedbook 37, Recorder of Deeds, Ralls County Courthouse, New London, Missouri.

Gottfried, Herbert & Jan Jennings. *American Vernacular Design, 1870-1940.* Iowa State UP: Ames, IA, 1988, 250.

"Greenlawn Cemetery Records," *Ralls County Cemetery Records.*

"Greenlawn Items," *Perry Enterprise*, 1900-1906.

Howard, Golenda Roland. *Ralls County, Missouri.* Walsworth: Marceline, MO, 1980.

Jennings, Jan and Herbert Gottfried. *American Vernacular Design, 1870-1940.* New York: Van Nostrand Reinhold Co., 1985.

Leake, Ron. "Ralls County Missouri Churches Listing," 7/2002. Accessed 12/20/06 at <http://www.rootsweb.com/~morchs/churches.htm>.

Letter from George Heslar to Neal Yancy, November 29, 1971. On file with Marsha Knudsen.

"Survey of State and Local Historical Records." Works Projects Administration (WPA). Western Historical Manuscript Collection: Columbia, Missouri, August 27, 1941, Vol. 1, p. 7561.

West, Dee Paul. *The End of a Way of Life.* Herald Publishing Company: Shelbyville, Missouri, [1965].

United States Department of the Interior  
National Park Service

## National Register of Historic Places Continuation Sheet

Section number 10/11photo log Page 14 Greenlawn Methodist Church and Cemetery  
Ralls County, Missouri

---

### Verbal Boundary Description:

All of one acre of land in a square taken from the southwest corner of the north east quarter of Section 9, Township 54, Range 7 West, Ralls County, Missouri. Also described as: beginning at the south east corner of the intersection of Rt. J and CR D, move north 177.5 feet. Thence turn east, moving 182 feet. From this point, turn south 177.5 feet and thence west 182 feet to the point of beginning.

### Boundary Justification:

The boundary includes all the land initially donated by the Shepherds for the construction of the Greenlawn Methodist Church. It includes the church building and associated cemetery.

### Section 11: Form prepared by:

Revisions, additions and editing by:

Tiffany Patterson, State Historic Preservation Office, P.O. Box 176, Jefferson City, MO 65109

### Photo Log:

The following is true for all photographs unless otherwise indicated:

Greenlawn Methodist church and Cemetery

Ralls County, Missouri

Photographer: Ronald Knudsen

Date: Photo #1 taken 1/2005. Photos 2-4 taken 8/2006.

1. West façade and south elevation, facing northeast. Before restoration
2. West façade and south elevation, facing northeast. After restoration
3. West façade, south elevation, and cemetery, facing northeast.
4. West façade, facing east.
5. South elevation, facing north.
6. East elevation, facing west.
7. North elevation, facing south.
8. Interior, east wall, facing west.
9. Interior east wall/ceiling, facing east.
10. Interior, southwest corner, facing southwest.
11. Interior, west wall and door, facing west.
12. Interior, northwest corner, facing northwest.
13. Interior, north floor, facing north.
14. Exterior, northeast view of cemetery, camera facing northeast.

7663 II SE  
(STOUTSVILLE)

UNITED STATES  
DEPARTMENT OF THE INTERIOR  
GEOLOGICAL SURVEY

STATE OF MISSOURI  
DEPARTMENT OF NATURAL RESOURCES  
WALLACE B. HOWE, STATE GEOLOGIST

91° 45' 39' 30" 608000m E. R. 8 W. R. 7 W. 10,172000 FEET (CENTRAL) 42' 30" 912 7663 II SW (JOANNA) 13 MI. TO U.S. 24 & 36 40' 915

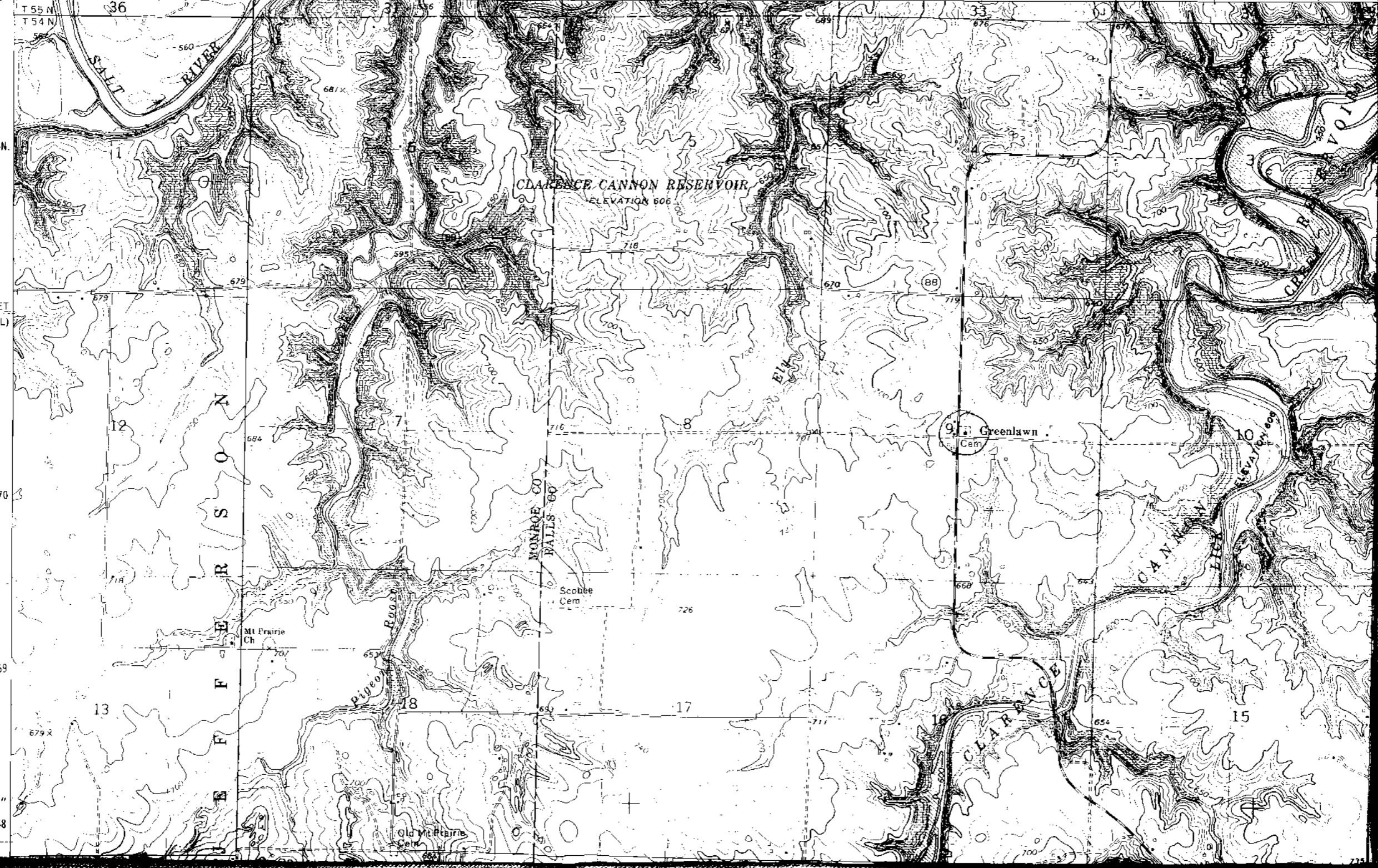

1330000 FEET  
(CENTRAL)  
Catholic Memorial Church  
& Cemetery  
Old Mt. Prairie  
1413010/4230625  
1776



CHAPEL



CHAPEL

ROSENSTENG





Gospel Memorial  
**CHAPEL**  
ESTABLISHED 1900



















WILLY D. WEST  
MAY 21, 1848  
JULY 1, 1921

ESTHER WEST  
JULY 1, 1852  
JULY 1, 1921

GOODS

**WEST**  
ANNA VIOLA WEST  
DEC. 10, 1874  
MAY 5, 1917

THE ABOVE BEEN WILLS - GENERAL  
DONOR OF FUNDS FOR THE SUPPORT  
OF ALL CHRISTIANITY IN TN AND

DANIEL W. WEST  
APR. 7, 1888  
FEB. 28, 1942

WILSON

YANCEY

**MADDUX**

ALTA F.  
FEB. 23, 1898  
APR. 13, 1977

RAY  
SEPT. 18, 1891  
JAN. 22, 1959