

GILLHAM/MAIN NEIGHBORHOOD

1. 100 E. 43rd St.
2. 112-114, 116-118, 120-122 E. 43rd St.
3. 200-02, 204-06 E. 43rd St.
4. 210, 212, 214 E. 43rd St.
5. 300 E. 43rd St.
6. 302 E. 43rd St.
7. 304 E. 43rd St.
8. 306-324 E. 43rd St.
9. 400-03, 404-06 E. 43rd St.
10. Parking lot between E. 44th and E. 45th St.
11. Kansas City Art Institute: lawn and tennis courts
12. 14 E. 46th St.
13. 116 E. 46th St.
14. 127-129 E. 46th St.
15. 131-133 E. 46th St.
16. 200 E. 46th St.
17. 209-211 E. 46th St.
18. 214-217 E. 46th St.
19. 219-221 E. 46th St.
20. 223-225 E. 46th St.
21. 227-229 E. 46th St.
22. 231-233, 235-237 E. 46th St.
23. 101 Brush Creek Blvd.
24. 210-212 Brush Creek Blvd.
25. Parking lot west of 210-212 Brush Creek Blvd.

GILLHAM/MAIN NEIGHBORHOOD (CONT.)

26. 214-216 Brush Creek Blvd.
27. 218-220 Brush Creek Blvd.
28. 222-224 Brush Creek Blvd..
29. 226-228 Brush Creek Blvd.
30. 230-232, 234-236 Brush Creek Blvd.
31. 4525 Oak Street
32. 4415 Warwick Blvd.
33. 4550 Warwick Blvd.
34. 4618 Warwick Blvd.
35. 4328-4330 Warwick Blvd.
36. 4329 Walnut St.
37. 4305-07 Walnut St.
38. 4309 Walnut St.
39. 4313 Walnut St.
40. 4317 Walnut St.
41. 4319 Walnut St.
42. 4320 Walnut St.
43. 4321 Walnut St.
44. 4325 Walnut St.
45. 4327 Walnut St.
46. 4331 Walnut St.
47. 4402 Walnut St.
48. 4404 Walnut St.
49. 4406 Walnut St.
50. 4408 Walnut St.

GILLHAM/MAIN NEIGHBORHOOD (CONT.)

51. 4410 Walnut St.
52. 4414 Walnut St.
53. 4418 Walnut St.
54. 4426 Walnut St.
55. 4627-4641 Walnut St.
56. 4553-4555 Main St.
57. 4601 Main St.

GILLHAM/MAIN HISTORIC INVENTORY

1. 301-303 E. 43rd Street	29. 4314 Warwick Blvd.
2. 305-307 E. 43rd Street	30. 4315 "
3. 311-313 E. 43rd Street	31. 4322 "
4. 315-317 "	32. 4325 "
5. 319-321 "	33. 4326 "
6. 110 E. 445h Street	34. 4331 "
7. 116 "	35. 4338-4340 "
8. 200 "	36. 4400 "
9. 206 "	37. 4408 "
10. 401 "	38. 4410 "
11. 417 "	39. 4420 "
12. 420 "	40. 4500 "
13. 421 "	41. 4526 "
14. 500 "	42. 4538 "
15. 501 "	43. 4300 Mc Gee Street
16. 506 "	44. 4309-11 "
17. 514-516 "	45. 4312 "
18. 320 E. 45th Street	46. 4313-15 "
19. 400 "	47. 4316 "
20. 414 "	48. 4317 "
21. 420 "	49. 4320 "
22. 500 "	50. 4324 "
23. 520 "	51. 4325 "
24. 4509 Walnut Street	52. 4328 "
25. 4300 Warwick Blvd.	53. 4329 "
26. 4306 "	54. 4330 "
27. 4307 "	55. 4331 "
28. 4310 "	56. 4334 "

57. 4335 Mc Gee Street	85. 4320 Rockhill Road
58. 4302-04 Oak Street	86. 4322 "
59. 4306;4306s; 4308; 4308s Oak Street	87. 4326 "
60. 4310-12 Oak Street	88. 4330 "
61. 4314-16 "	89. 4332 "
62. 4315-17 "	90. 4338 "
63. 4317-4319 "	91. 4340 "
64. 4320 "	92. 4342-44 "
65. 4333-35 "	93. 4346-48 "
66. 4340 "	94. 4350-52 "
67. 4343 "	95. 4401 "
68. 4347 "	96. 4405 "
69. 4326 Locust Street	97. 4409 "
70. 4334 "	
71. 4336 "	
72. 4338 "	
73. 4339 "	
74. 4340 "	
75. 4341 "	
76. 4343 "	
77. 4344 "	
78. 4345 "	
79. 4346 "	
80. 4348 "	
81. 4311 Rockhill Road.	
82. 4314-16 "	
83. 4315 "	
84. 4318 "	

GILLHAM MAIN

STREET ADDRESSES

1979

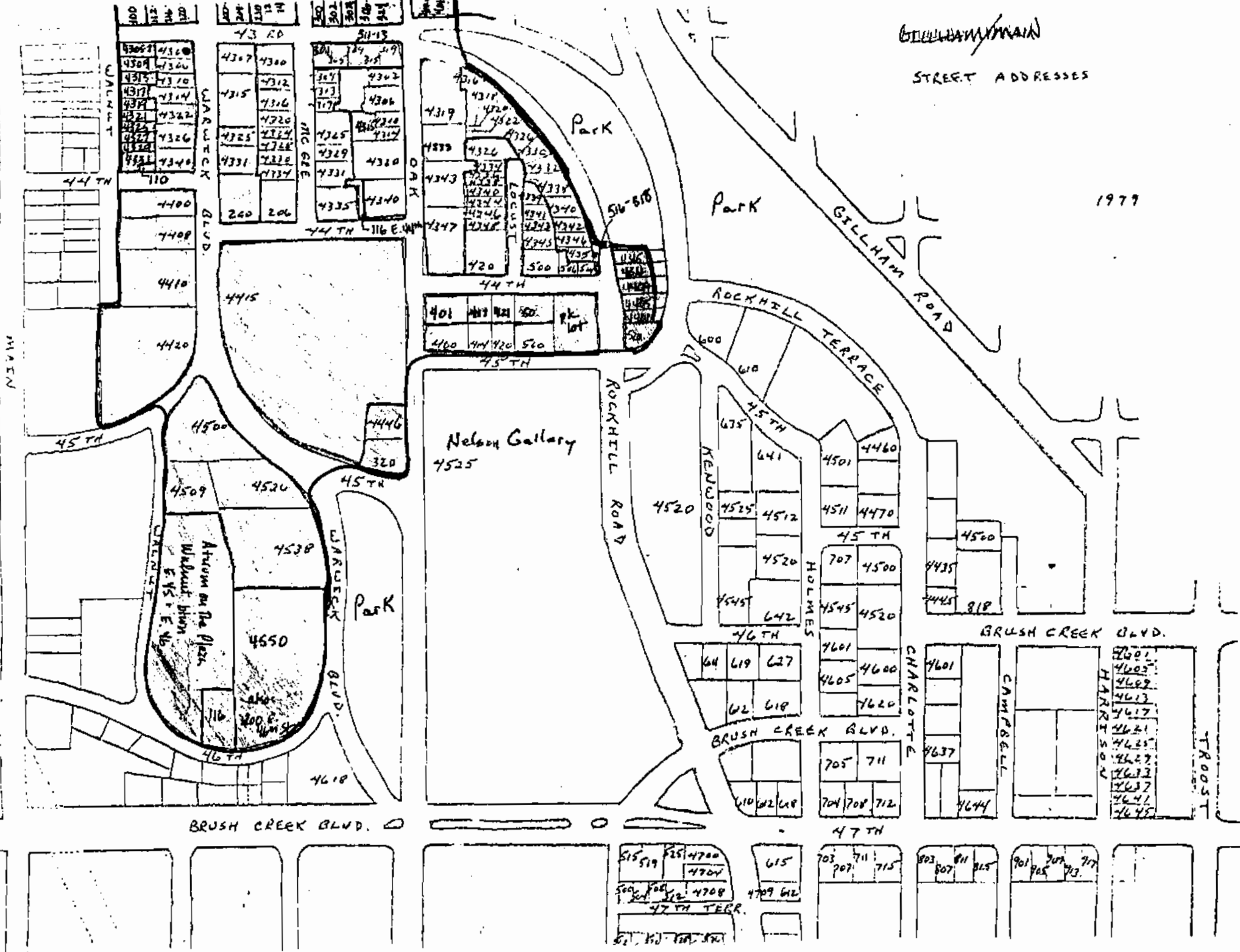

BRUSH CREEK BLVD.

515 519 525 4700  
4700  
500 504 512 4708  
47 TH TERR.

47 TH

803 807 811 815

901 905 909 913

TRUST

GILLHAM MAIN

STREET ADDRESSES

1977

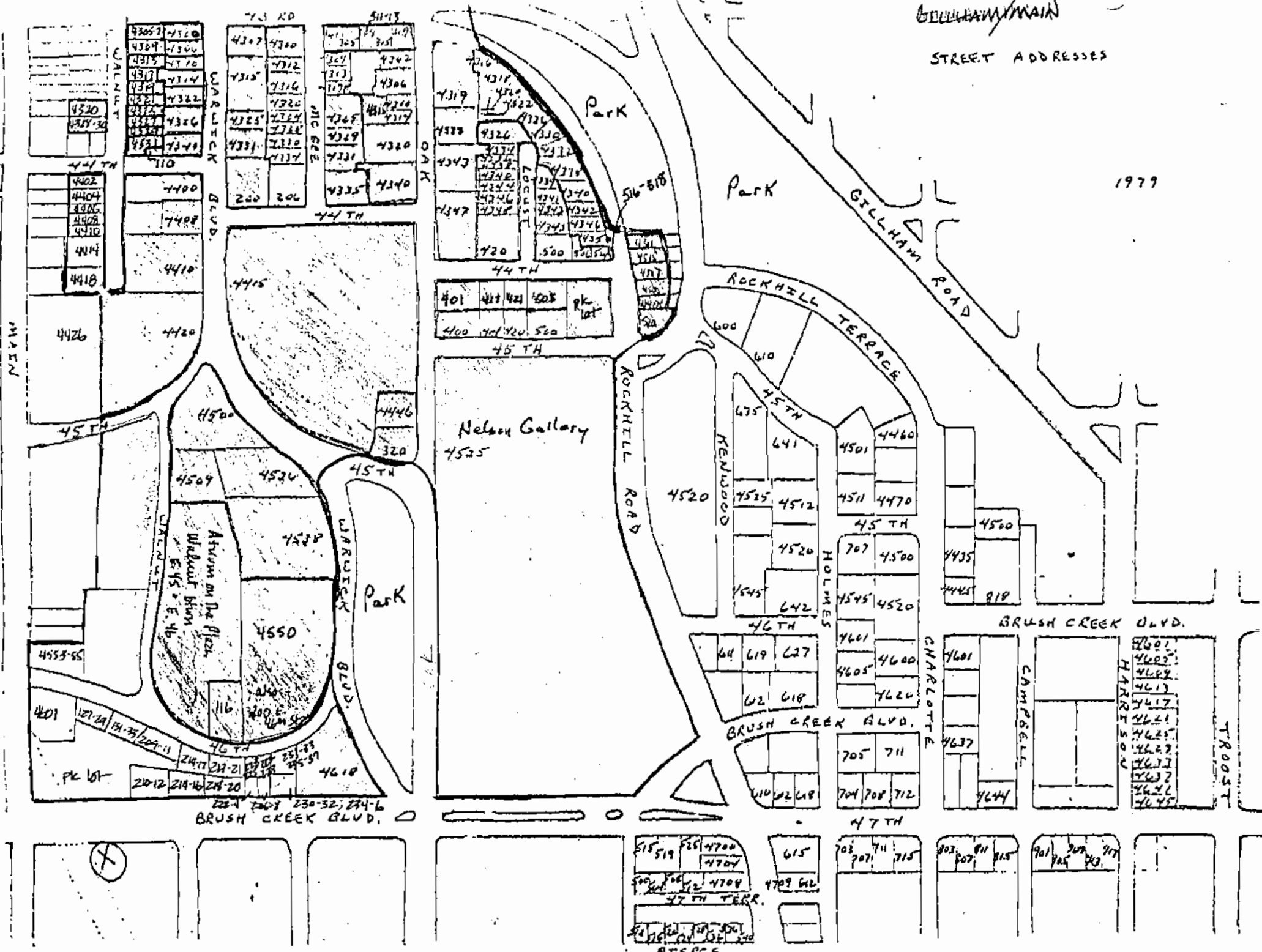

Nelson Gallery  
4525

Atrium on the Plaza  
Wildcat Blown  
5-15 E. 16

515 519 525 4700  
4707  
500 506 512 4704  
4709 612  
47TH TERR.  
PIERCE

BRUSH CREEK BLVD.

BRUSH CREEK BLVD.

BRUSH CREEK BLVD.

ROCKHILL ROAD

GILLHAM ROAD

ROCKHILL TERRACE

CHARLOTTE

CAMPBELL

TROOST

MAIN

CAVENDISH

MARBLECK BLVD.

MIC GEE

MIC GEE

MARBLECK BLVD.

ORR

ORR

ORR

LOVELL

LOVELL

LOVELL

LOVELL

LOVELL

LOVELL

LOVELL

LOVELL

LOVELL

LOVELL

LOVELL

LOVELL

LOVELL

LOVELL

LOVELL

LOVELL

LOVELL

LOVELL

LOVELL

LOVELL

LOVELL

LOVELL

LOVELL

LOVELL

LOVELL

LOVELL

LOVELL

LOVELL

LOVELL

LOVELL

LOVELL

LOVELL

LOVELL

LOVELL

LOVELL

LOVELL

LOVELL

LOVELL

LOVELL

LOVELL

LOVELL

LOVELL

LOVELL

LOVELL

LOVELL

LOVELL

LOVELL

LOVELL

LOVELL

LOVELL

LOVELL

LOVELL

LOVELL

LOVELL

LOVELL

LOVELL

LOVELL

LOVELL

LOVELL

LOVELL

LOVELL

LOVELL

LOVELL

LOVELL

LOVELL

LOVELL

LOVELL

LOVELL

LOVELL

LOVELL

LOVELL

LOVELL

LOVELL

LOVELL

LOVELL

LOVELL

LOVELL

LOVELL

LOVELL

LOVELL

LOVELL

LOVELL

LOVELL

LOVELL

LOVELL

LOVELL

LOVELL

LOVELL

LOVELL

LOVELL

LOVELL

LOVELL

LOVELL

LOVELL

LOVELL

LOVELL

LOVELL

LOVELL

LOVELL

LOVELL

LOVELL

LOVELL

LOVELL

LOVELL

LOVELL

LOVELL

LOVELL

LOVELL

LOVELL

LOVELL

LOVELL

LOVELL

LOVELL

LOVELL

LOVELL

LOVELL

LOVELL

LOVELL

LOVELL

LOVELL

LOVELL

LOVELL

LOVELL

LOVELL

LOVELL

LOVELL

LOVELL

LOVELL

LOVELL

LOVELL

LOVELL

LOVELL

LOVELL

LOVELL

LOVELL

LOVELL

LOVELL

LOVELL

LOVELL

LOVELL

LOVELL

LOVELL

LOVELL

LOVELL

LOVELL

LOVELL

LOVELL

LOVELL

LOVELL

LOVELL

LOVELL

LOVELL

LOVELL

LOVELL

LOVELL

LOVELL

LOVELL

LOVELL

LOVELL

LOVELL

LOVELL

LOVELL

LOVELL

LOVELL

LOVELL

LOVELL

LOVELL

LOVELL

LOVELL

LOVELL

LOVELL

LOVELL

LOVELL

LOVELL

LOVELL

LOVELL

LOVELL

LOVELL

LOVELL

LOVELL

LOVELL

LOVELL

LOVELL

LOVELL

LOVELL

LOVELL

LOVELL

LOVELL

LOVELL

LOVELL

LOVELL

LOVELL

LOVELL

LOVELL

LOVELL

LOVELL

LOVELL

LOVELL

LOVELL

LOVELL

LOVELL

LOVELL

LOVELL

LOVELL

LOVELL

LOVELL