

United States Department of the Interior
National Park Service

National Register of Historic Places Registration Form

This form is for use in nominating or requesting determinations for individual properties and districts. See instructions in National Register Bulletin, *How to Complete the National Register of Historic Places Registration Form*. If any item does not apply to the property being documented, enter "N/A" for "not applicable." For functions, architectural classification, materials, and areas of significance, enter only categories and subcategories from the instructions. Place additional certification comments, entries, and narrative items on continuation sheets if needed (NPS Form 10-900a).

1. Name of Property

Historic name Cuba Lodge No. 312 A. F. & A. M.

Other names/site number N/A

Name of related Multiple Property Listing Historical and Architectural Resources of the City of Cuba, Missouri, 1821-1963

2. Location

Street & number 201 North Smith Street

N/A	not for publication
-----	---------------------

City or town Cuba

N/A	vicinity
-----	----------

State Missouri Code MO County Crawford Code 055 Zip code 65453

3. State/Federal Agency Certification

As the designated authority under the National Historic Preservation Act, as amended,

I hereby certify that this nomination request for determination of eligibility meets the documentation standards for registering properties in the National Register of Historic Places and meets the procedural and professional requirements set forth in 36 CFR Part 60.

In my opinion, the property meets does not meet the National Register Criteria. I recommend that this property be considered significant at the following level(s) of significance:

national statewide local

Applicable National Register Criteria: A B C D

Signature of certifying official/Title Mark A. Miles, Deputy SHPO

Date Sept 5, 2014

Missouri Department of Natural Resources
State or Federal agency/bureau or Tribal Government

In my opinion, the property meets does not meet the National Register criteria.

Signature of commenting official _____ Date _____

Title _____ State or Federal agency/bureau or Tribal Government

4. National Park Service Certification

I hereby certify that this property is:

entered in the National Register determined eligible for the National Register

determined not eligible for the National Register removed from the National Register

other (explain:) _____

Signature of the Keeper _____ Date of Action _____

Cuba Lodge No. 312 A. F. & A. M.
Name of Property

Crawford County, Missouri
County and State

5. Classification

Ownership of Property
(Check as many boxes as apply.)

Category of Property
(Check only **one** box.)

Number of Resources within Property
(Do not include previously listed resources in the count.)

<input checked="" type="checkbox"/>	private
<input type="checkbox"/>	public - Local
<input type="checkbox"/>	public - State
<input type="checkbox"/>	public - Federal

<input checked="" type="checkbox"/>	building(s)
<input type="checkbox"/>	district
<input type="checkbox"/>	site
<input type="checkbox"/>	structure
<input type="checkbox"/>	object

Contributing	Noncontributing	
1		buildings
		sites
		structures
		objects
1		Total

Number of contributing resources previously listed in the National Register

0

6. Function or Use

Historic Functions

(Enter categories from instructions.)

SOCIAL/Meeting Hall/Masonic

Current Functions

(Enter categories from instructions.)

SOCIAL/Meeting Hall/Masonic

7. Description

Architectural Classification

(Enter categories from instructions.)

OTHER/Gable Front

Materials

(Enter categories from instructions.)

foundation: Limestone

walls: Sandstone

roof: Asphalt

other: Wood

Glass

NARRATIVE DESCRIPTION ON CONTINUATION PAGES

Cuba Lodge No. 312 A. F. & A. M.
Name of Property

Crawford County, Missouri
County and State

8. Statement of Significance

Applicable National Register Criteria

(Mark "x" in one or more boxes for the criteria qualifying the property for National Register listing.)

- A Property is associated with events that have made a significant contribution to the broad patterns of our history.
- B Property is associated with the lives of persons significant in our past.
- C Property embodies the distinctive characteristics of a type, period, or method of construction or represents the work of a master, or possesses high artistic values, or represents a significant and distinguishable entity whose components lack individual distinction.
- D Property has yielded, or is likely to yield, information important in prehistory or history.

Areas of Significance

SOCIAL HISTORY

Period of Significance

1940-1964

Significant Dates

1940

Criteria Considerations

(Mark "x" in all the boxes that apply.)

Property is:

- A Owned by a religious institution or used for religious purposes.
- B removed from its original location.
- C a birthplace or grave.
- D a cemetery.
- E a reconstructed building, object, or structure.
- F a commemorative property.
- G less than 50 years old or achieving significance within the past 50 years.

Significant Person

(Complete only if Criterion B is marked above.)

N/A

Cultural Affiliation

N/A

Architect/Builder

Eversen, Tom /Engineer

Sharp, David R. /Mason

Stumpf, Albert /Mason

STATEMENT OF SIGNIFICANCE ON CONTINUATION PAGES

9. Major Bibliographical References

Bibliography (Cite the books, articles, and other sources used in preparing this form.)

Previous documentation on file (NPS):

- preliminary determination of individual listing (36 CFR 67 has been requested)
- previously listed in the National Register
- previously determined eligible by the National Register
- designated a National Historic Landmark
- recorded by Historic American Buildings Survey # _____
- recorded by Historic American Engineering Record # _____
- recorded by Historic American Landscape Survey # _____

Primary location of additional data:

- State Historic Preservation Office
- Other State agency
- Federal agency
- Local government
- University
- Other

Name of repository: Cuba Historical Society

Historic Resources Survey Number (if assigned): _____

10. Geographical Data

Cuba Lodge No. 312 A. F. & A. M.
Name of Property

Crawford County, Missouri
County and State

Acreage of Property Under 1 acre

Latitude/Longitude Coordinates

Datum if other than WGS84: _____
(enter coordinates to 6 decimal places)

1 38.062929 -91.407151 3 _____
Latitude: Longitude: Latitude: Longitude:

2 _____ 4 _____
Latitude: Longitude: Latitude: Longitude:

UTM References

(Place additional UTM references on a continuation sheet.)
_____ NAD 1927 or _____ NAD 1983

1 _____ 3 _____
Zone Easting Northing

3 _____ 4 _____
Zone Easting Northing

2 _____
Zone Easting Northing

4 _____
Zone Easting Northing

Verbal Boundary Description (On continuation sheet)

Boundary Justification (On continuation sheet)

11. Form Prepared By

name/title Matt Bivens/Historic Preservation Director
organization Lafser & Associates, Inc. date 1-30-2014; Final 8.15.2014
street & number 1215 Fern Ridge Pkwy., Suite 110 telephone 314-560-9903
city or town St. Louis state MO zip code 63141
e-mail msbivens@lafser.com

Additional Documentation

Submit the following items with the completed form:

- **Maps:**
 - A **USGS map** (7.5 or 15 minute series) indicating the property's location.
 - A **Sketch map** for historic districts and properties having large acreage or numerous resources. Key all photographs to this map.
- **Continuation Sheets**
- **Photographs**
- **Owner Name and Contact Information**
- **Additional items:** (Check with the SHPO or FPO for any additional items.)

Paperwork Reduction Act Statement: This information is being collected for applications to the National Register of Historic Places to nominate properties for listing or determine eligibility for listing, to list properties, and to amend existing listings. Response to this request is required to obtain a benefit in accordance with the National Historic Preservation Act, as amended (16 U.S.C.460 et seq.).

Estimated Burden Statement: Public reporting burden for this form is estimated to average 18 hours per response including time for reviewing instructions, gathering and maintaining data, and completing and reviewing the form. Direct comments regarding this burden estimate or any aspect of this form to the Office of Planning and Performance Management, U.S. Dept. of the Interior, 1849 C. Street, NW, Washington, DC.

Cuba Lodge No. 312 A. F. & A. M.
Name of Property

Crawford County, Missouri
County and State

Photographs

Submit clear and descriptive photographs. The size of each image must be 1600x1200 pixels (minimum), 3000x2000 preferred, at 300 ppi (pixels per inch) or larger. Key all photographs to the sketch map. Each photograph must be numbered and that number must correspond to the photograph number on the photo log. For simplicity, the name of the photographer, photo date, etc. may be listed once on the photograph log and doesn't need to be labeled on every photograph.

Photo Log:

Name of Property: Cuba Lodge No. 312, A. F. & A. M.

City or Vicinity: Cuba

County: Crawford State: Missouri

Photographer: Matt Bivens

Date
Photographed: 10-1-2013

Description of Photograph(s) and number, include description of view indicating direction of camera:

- 1 of 16: Primary elevation; camera facing east
- 2 of 16: Primary elevation detail; camera facing east
- 3 of 16: Primary elevation cornerstone; camera facing east
- 4 of 16: Primary elevation porch; camera facing northeast
- 5 of 16: Primary elevation wood door; camera facing east
- 6 of 16: Primary elevation (left) and south wall (right); camera facing northeast
- 7 of 16: south wall (left) and rear (right); camera facing northwest
- 8 of 16: Rear elevation detail; camera facing northwest
- 9 of 16: Primary elevation (right) and north wall (left); camera facing southeast
- 10 of 16: South elevation masonry detail; camera facing north
- 11 of 16: Historic photo post card c 1945 of primary elevation; camera facing east
- 12 of 16: Interior basement level; camera west
- 13 of 16: Interior stair to main floor; camera north
- 14 of 16: Interior main floor; camera south
- 15 of 16: Interior main floor Masonic hall; camera east
- 16 of 16: Interior stair detail; camera east

Figure Log:

Include figures on continuation pages at the end of the nomination.

Figure 1 (page 8): First and Basement Floor Plans. Source: Lafser site visit.

Figure 2 (page 11): Original City Plat with 1940 Lodge site circled. Source: Cuba Historical Society.

Figure 3 (page 12): Early postcard, circa 1945. Source: Cuba Historical Society collection.

National Register of Historic Places
Continuation Sheet

Section number 7 Page 6

Cuba Lodge No. 312 A. F. & A. M.

Name of Property

Crawford County, Missouri

County and State

Historical and Architectural Resources of the City of Cuba,
Missouri, 1821-1963

Name of multiple listing (if applicable)

ARCHITECTURAL DESCRIPTION

Summary

The Cuba Lodge Number 312 A. F. & A. M. building 201 North Smith Street in Cuba, Crawford County, Missouri, is a one-story, front gabled-hip roof, rectangular-shaped building constructed of dressed, random ashlar, native sandstone and completed in 1940. The primary entrance is situated under a projecting front gable roof porch on stone piers; both roofs are clad in asbestos shingles. A high basement with concrete foundation is penetrated by multi-light windows as is the upper portions of the first floor. The rear elevation contains a below-grade entrance that is reached by concrete steps and is sheltered under a front gable roof porch with curved underside. The interior is comprised of an open basement level serving as meeting space with smaller rooms containing storage, kitchen, and restrooms. The main floor is accessed via a wood stair located at the west wall; an entry foyer is adjacent the primary entrance. Up another stair which features an ornamental rail, newels, and balusters are offices. The entry to the main room of the lodge is beyond and is a wide open space with cove ceiling. The building faces west at North Smith Street and is surrounded by a grassy lot; evergreen trees are at either side of a concrete walkway leading to the primary entrance. The building has integrity of location, design, setting, materials, workmanship, feeling and association.

Site

The Cuba Lodge occupies the southwest corner of an irregular-shaped city block at the intersection of North Smith Street and West Spencer Avenue. A pair of mature evergreen trees closer to the main sidewalk flanks a concrete walk to the building primary elevation. The lot surrounding the property is grass but otherwise not landscaped. Residential, institutional and commercial properties occupy the block.

Exterior

The Cuba Lodge's primary elevation faces west and is symmetrical (photo 1). The façade is divided into three bays with a double entrance at the center. Reached by concrete steps with rounded sides, a pair of massive stone piers supports a stone gable above. Embedded under the apex of the roof gable is a white stone disc—likely marble—which contains the traditional square and compass symbol of Freemasonry (photo 2). The front gable roof above has return eaves and is clad in asbestos shingles. A double-door entrance (photo 5 detail) is contained within a partly projecting bay which extends to the outside width of the piers. Beyond a newer metal storm door is a pair of original wood near-full-height light, single panel doors. Above, the underside of the ceiling is board and batten with an original pendant light fixture. At either side of

National Register of Historic Places
Continuation Sheet

Section number 7 Page 7

Cuba Lodge No. 312 A. F. & A. M.

Name of Property

Crawford County, Missouri

County and State

Historical and Architectural Resources of the City of Cuba,
Missouri, 1821-1963

Name of multiple listing (if applicable)

the entry bay is a four-light sash window cut in the basement wall; above is a double-hung, four-over-one-light sash with a six-sided, grey granite keystone set within the sandstone coursing. Four primary elevation windows are recessed back in the wall, have metal lintels, and are set on stone sills. The outermost portion of the elevation edges project slightly and contain return eaves from the main roof. At the southeast corner of the building is a polished grey granite cornerstone which contains the inscription: "CUBA LODGE, NO. 312 A. F. & A. M., 1887, 1940" again with the square and compass symbol—this time in between the dates (photo 3); this is not typical for masonic structures where the cornerstone is located at the northwest building edge. Under the apex of the main roof is a vertical vent with louvers (photo 4).

The south-facing elevation is an expanse of smooth-cut, random ashlar, native sandstone; portions of the faces are either smoothed or rock-faced and few have visible chisel marks. At the basement level are four recessed window openings with stone sills and metal lintels; windows are three-over-three light sash. In line with the lower windows are four double-hung, six-over-one-light sash with similar sills and lintels set under the roofline. A band above—potentially painted wood—acts as a cornice under the roof overhang. A white gutter continues at the lower edge of the roof and terminates in two downspouts near the front and the center of the elevation (photos 6-7).

The rear, east-facing elevation has identical stonework but with no window penetrations. Nearer the north side of the building but at the rear is a below-grade, single panel, entrance door reached by concrete steps and flanked by underground stone kneewalls. A front gable portico with rounded ceiling set on a pair of wood posts and pilasters mounted to the wall shelter the entry. The roof overhangs above, with gutter installation and end wall downspouts. Above, the roofline is hipped. The concrete foundation is visible (photos 7-8).

The north elevation is identical to the south but contains one basement window that is infilled with stone (photo 9). Mechanical equipment towards the front of the building is tucked at the wall. Again the roof overhangs and the guttering/downspouts continue. Visible at the roof is a ridge coping. The concrete foundation is visible. Portions of all walls contain stone which is coursed and also that which is random. A closer study might reveal a specific pattern design intent (photo 10). Photo 11 shows a historic view of the building.

National Register of Historic Places
Continuation Sheet

Section number 7 Page 8

Cuba Lodge No. 312 A. F. & A. M.
Name of Property
Crawford County, Missouri
County and State
Historical and Architectural Resources of the City of Cuba, Missouri, 1821-1963
Name of multiple listing (if applicable)

Interior

The Cuba Lodge's interior contains an open meeting area complete with tables and chairs intended for meetings and community affairs in the basement level (photo 12); storage closets, a mechanical room, and a kitchen are situated along the western basement wall. Up a wooden stair in the southwest corner of the building, an entry hall with access to the primary elevation entrance is met by a second stair which leads up to the main floor (photo 12). A balcony is framed by an original and elaborate rail with newel posts and balusters of richly-carved wood (photo 14 and 16). Within this space are offices and an entrance to the main room where Masonic meetings and relative ceremonies are conducted (photo 15); there is a cove ceiling above with original plaster finish. The interior retains original floor plans and room divisions as well as materials; wood and concrete floors are covered with carpet. (See Figure 1 floor plan).

Figure 1: First and Basement Floor Plans. Source: Lafser site visit.

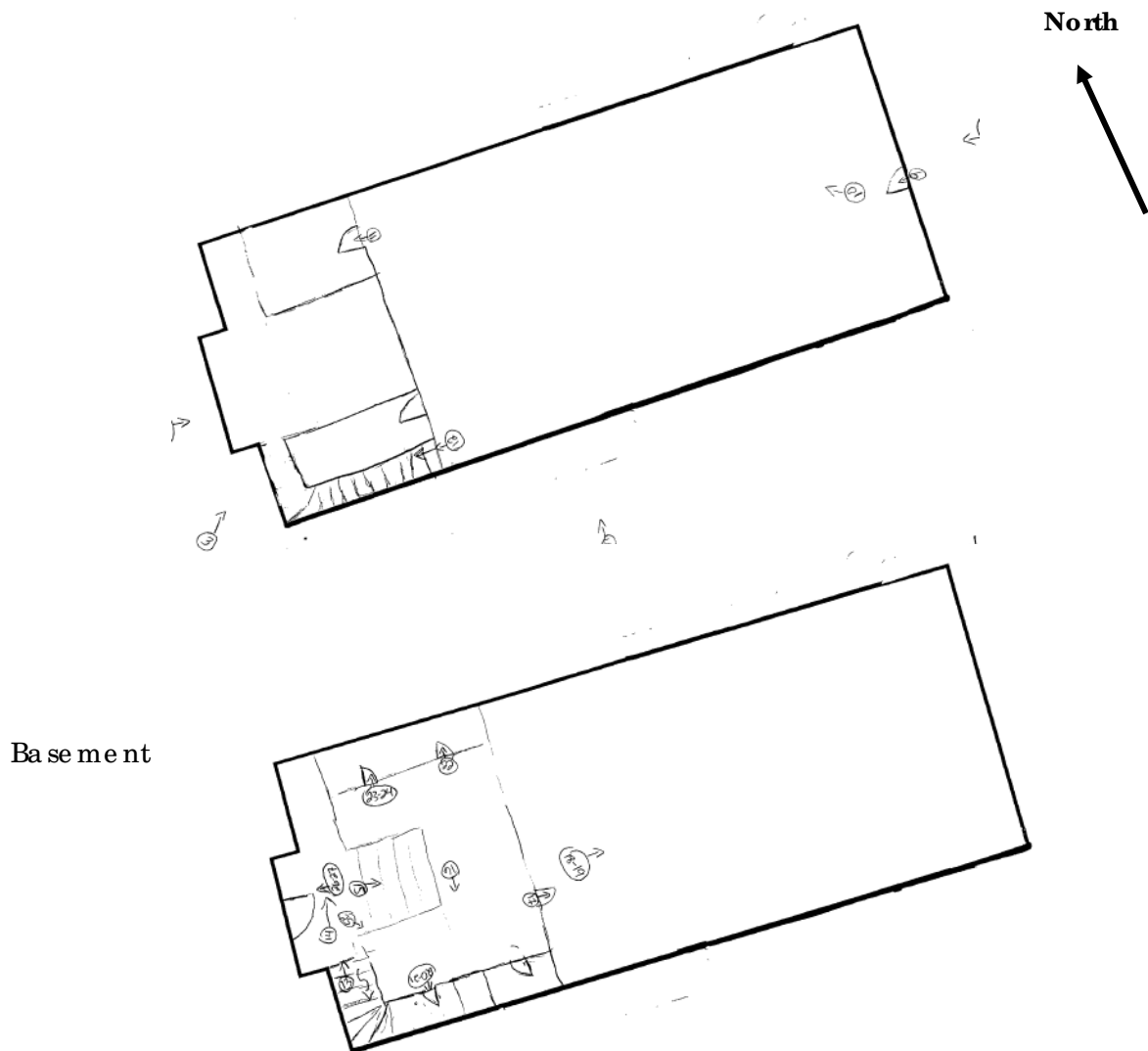

National Register of Historic Places
Continuation Sheet

Section number 8 Page 9

Cuba Lodge No. 312 A. F. & A. M. Name of Property
Crawford County, Missouri County and State
Historical and Architectural Resources of the City of Cuba, Missouri, 1821-1963 Name of multiple listing (if applicable)

STATEMENT OF SIGNIFICANCE

Summary

The Cuba Lodge No. 312 A. F. & A. M. Building located at 201 North Smith Street in Cuba, Crawford County, Missouri, is eligible for local listing in the National Register of Historic Places (NRHP) under Criterion A in SOCIAL HISTORY. Completed in 1940 and built entirely of local stone, this fraternal hall was constructed as the first permanent and ultimately the final home of the Ancient Free and Accepted Masons of Cuba. Comprised of both coursed and random ashlar stonework, the masonry is attributed to local man David R. Sharp; additional sources indicate that another rare mason named Albert C. Stumpf may have also worked on the structure. The building housed an important local Masonic organization whom constructed the building for its sole use as a meeting place as well as an edifice from which they could provide other organizational uses. The interior reflects its original design including floor plans, materials, and an elaborate wood railing. The period of significance begins with the construction date of 1940 and it extends to the arbitrary 50-year cut-off for National Register significance in 1964; the building continues to serve the same purpose as originally intended and thus there is no specific end date. The building retains integrity and meets the registration requirements set forth in the multiple property documentation form entitled "Historic and Architectural Resources of the City of Cuba, Missouri, 1821-1963" and the associated historic context "Route 66 and the Great Depression, 1926-1945." The property type is characterized as "II-C Secular Institutional Architecture" as a fraternal and social meeting hall.

Background - Fraternal Organizations of Cuba, Missouri

Providing sustenance to the social life of Cuba's residents, a number of fraternal organizations were founded early on. Such groups including the Cuba Lodge Number 270 International Order of Odd Fellows (I.O.O.F) was perhaps the earliest and it was chartered in 1872.¹ A little over a decade later the Star of the West Lodge Number 282 Ancient Order of United Workmen (A.O.U.W.) was chartered in 1883. Also in the latter half of the 1880s, the Cuba Post Number 263 Grand Army of the Republic (G.A.R.) was organized in 1885, and the Ivanhoe Encampment Number 202 International Order of Odd Fellows (I.O.O.F) was organized with twenty-eight members in 1887.² The year

¹ James Ira Breuer. Unpublished history, 1973, no page number. Collection of the City of Cuba Historical Society; Breuer Archives.

² Ibid. Some sources indicate that the number was 101 rather than 202.

National Register of Historic Places
Continuation Sheet

Section number 8 Page 10

Cuba Lodge No. 312 A. F. & A. M.

Name of Property

Crawford County, Missouri

County and State

Historical and Architectural Resources of the City of Cuba,
Missouri, 1821-1963

Name of multiple listing (if applicable)

1887 also marked the arrival of the newly-chartered Cuba Lodge Number 312 Ancient Free and Accepted Masons (A. F. & A. M.) in October of that year.³

Typically meeting early on in personal residences of lodge members, then later on the upper floors of Cuba's commercial buildings, the latter organization in particular had first met upstairs in the original People's Bank Building at 600 West Washington (NR listed in Uptown Cuba Historic District) and then met in a rented hall on the second floor of Newman & Jones's General Store (location unknown) for over fifty years.⁴ Number 312 A. F. & A. M. was founded by Grand Master William M. Williams⁵ and was originally comprised of just twenty-four members.

The early history of the lodge is currently unknown except that regular meetings were held by the masons and that few of its members were actual stone masons in Cuba (David Sharp and Albert Stumpf). Ultimately the temporary meeting place above the general store was destroyed by fire twice and the A. F. & A. M. decided to proceed with building its own building in 1940. Prior to the decision to build the new structure and permanent home, a vote to merge the A. F. & A. M. with Cuba's Redbird Lodge Number 584 was made in 1936.

Elaboration-A New Lodge is Built

Cuba Lodge Number 312 Ancient Free and Accepted Masons (A. F. & A. M.) sought ownership of a sizable corner lot at the northeast corner of Smith and Spencer Streets in 1940, just north of the original town plat (Figure 2). In proximity to the business district, the Lodge would also be adjacent the recently completed combination City Hall and Fire Station built in 1934 by local masons using local stone. Masons responsible for the building included Works Administration Program-trained David Sharp & Albert Stumpf—two masons that also belonged to the Number 312 A. F. & A. M. lodge in Cuba.

³ Steven E. and Mary Aue Mitchell. "Cuba, Crawford County, Architectural/Historical Survey." February 2007, HPF grant# 29-06-21528-612. page 12.

⁴ Goodspeed Publishing Company. *History of Franklin, Jefferson, Washington, Crawford, and Gasconade Counties, Missouri*. (Chicago, 1888), pages 595-597.

⁵ Cuba Sesquicentennial Book Committee. "Celebrating 150 Years: A History of Cuba, Missouri- 1857-2007." (Cuba, MO: 2008). Page 64.

National Register of Historic Places
 Continuation Sheet

Section number 8 Page 11

Cuba Lodge No. 312 A. F. & A. M.
Name of Property
Crawford County, Missouri
County and State
Historical and Architectural Resources of the City of Cuba, Missouri, 1821-1963
Name of multiple listing (if applicable)

Figure 2: Original City Plat with 1940 Lodge site circled. Source: Cuba Historical Society.



The impact of the New Deal and of the Works Administration Programs (CWA, PWA, WPA) in Cuba has been assessed in both the Mitchell's Survey and Taylor's MPDF documentation and of interest is the discussion of these two local masons.⁶ The sources both indicate that the men were likely responsible for leading the original construction of the nominated building. Local records indicate that a mason David R. Sharp was indeed responsible for the exterior sandstone.⁷ Sharp is known for his work on the nearby First Baptist Church at 606 W. Myrtle (1950) and recently attributed structures including a residence at 310 Myrtle (1940), John Eads House at 416 North Park (1940), and a house at 412 North Park (1940) are impressive stone edifices built by Sharp.⁸ A second mason by the name of Albert C. Stumpf had been working earlier than Sharp and completed the stone work on the Holy Cross Catholic Church (1937), a monument in native stone, just to the north of the lodge.⁹ Either way, it is very likely that both men were involved and that the building was constructed using local labor and local stone.

Unfortunately there is not a lot of information available to elaborate in great detail about the nominated building, however what remains clear and distinct is that the building began as the first, permanent home of Cuba Lodge Number 312 A. F. & A. M.

⁶ Steven E and Mary Aue Mitchell pages 22-23, and 25. And David Taylor. "Historical and Architectural Resources of the City of Cuba, Missouri, 1821-1963." Multiple Property Documentation Form. 2012, section E, pages 23-24.
⁷ James Ira Breuer. Unpublished history, 1973, no page number. Collection of the City of Cuba Historical Society; Breuer Archives.
⁸ David Taylor. 2012, section E, page 24.
⁹ Ibid.

National Register of Historic Places
Continuation Sheet

Section number 8 Page 12

Cuba Lodge No. 312 A. F. & A. M.

Name of Property

Crawford County, Missouri

County and State

Historical and Architectural Resources of the City of Cuba,
Missouri, 1821-1963

Name of multiple listing (if applicable)

in 1940 and that it continues to serve in that capacity today. In September of 2006 there were 124 members; other local lodges including the Order of the Eastern Star Charter Number 398 have met in the building at the courtesy of the A. F. & A. M.¹⁰ The Cuba Lodge's importance to the local masonic order and to the community is unmatched in any other secular institutional buildings within Cuba as it is the first and the only fraternal building constructed in the city for the sole purpose of the use as a Masonic lodge. The building retains excellent integrity and its purpose is clearly recognizable today. Begun and completed in 1940, the building appears today unchanged on the exterior (Figure 3).

Figure 3: Early postcard, circa 1945. Source: Cuba Historical Society collection.



Cuba Survey

The "Cuba, Crawford County, Architectural/Historical Survey" conducted by Steven E. and Mary Aue Mitchell in February of 2007 explains that the Cuba Lodge 312 A. F. & A. M. is the only institutional building built solely for the use of one of Cuba's fraternal organizations.¹¹ Completed in 1940 and constructed entirely of locally-available stone,

¹⁰ Cuba Sesquicentennial Book Committee. Page 64.

¹¹ Steven E. and Mary Aue Mitchell. page 40.

National Register of Historic Places
Continuation Sheet

Section number 8 Page 13

Cuba Lodge No. 312 A. F. & A. M.

Name of Property

Crawford County, Missouri

County and State

Historical and Architectural Resources of the City of Cuba,
Missouri, 1821-1963

Name of multiple listing (if applicable)

this structure retains integrity. Significance of this structure is under Criterion A for Social History; a comparison of it to other native stone buildings may also prove that the building has additional significance under Criterion C in Architecture.

Relative to social history, research conducted for the Mitchell's survey report explained that "in late 19th century rural Missouri towns, fraternal organizations (as well as social groups and philanthropic societies) played a vital role" in the community.¹² Eligible buildings in this category also include religious buildings, government buildings and school buildings and all four types are considered "among the most significant buildings in a community, serving as the social, political, and educational foci of the town."¹³ The nominated building stands as the only fraternal building in Cuba eligible for listing in the National Register because it is the only example of its type as explained below in context of the MPDF.

The MPDF and Associated Historic Context

The Cuba Lodge Number 312 A. F. & A. M. was constructed during the period "Route 66 and the Great Depression, 1926-1945" and is a representative example of the "Property Type II: Institutional Architecture."¹⁴ Being the sole example of the sub-type "II-C: Secular Institutional Architecture" the building was erected for the exclusive purpose as a fraternal and social meeting hall and is distinct in its design (local stone formed to create a specific type of structure), composition, fenestration, and level of embellishment—all of which are original.¹⁵ This historic period was marked with the first municipal lighting system being installed and the start of Federally-assisted programs in rural communities;¹⁶ such programs helped to rebuild Cuba and along with it came hope for the future.

During these programs the combination City Hall and Fire Department, an underpass beneath Route 66, the Frisco underpass, and a public school were completed.¹⁷ Also significant was the training of local men in the mason trades—training of such men as Sharp and Stumpf. As a result, Cuba's masons would erect a number of excellent stone buildings made from sandstone and some of Ozark fieldstone throughout the community.

¹² *Ibid.*

¹³ *Ibid.* page 39.

¹⁴ David Taylor. "Historical and Architectural Resources of the City of Cuba, Missouri, 1821-1963." Multiple Property Documentation Form. 2012. Section F, page 4.

¹⁵ *Ibid.*, pages 4-5.

¹⁶ Cuba Sesquicentennial Book Committee. Page 127.

¹⁷ *Ibid.*

National Register of Historic Places
Continuation Sheet

Section number 8 Page 14

Cuba Lodge No. 312 A. F. & A. M.

Name of Property

Crawford County, Missouri

County and State

Historical and Architectural Resources of the City of Cuba,
Missouri, 1821-1963

Name of multiple listing (if applicable)

The nominated building was constructed as the A. F. & A. M.'s first permanent meeting hall and remains the lodge's home today. The Cuba Lodge's role within the growth of the social life of Cuba and its direct connection to the secular history of the town are clearly representative in the building which stands today as the building continues to serve its original function and retains visible integrity which illustrates its purpose. The interior of the building features the original footprint and division of rooms, a large open meeting area in the basement, a formal Masonic meeting room on the upper floor, original wood railings, stairs, and plaster cove ceiling.

In meeting the registration requirements of the MPDF, the nominated building is an excellent example of the property type (fraternal meeting hall) and it retains integrity of location, design, setting, materials, workmanship, feeling and association.¹⁸ From visual inspection, the only modifications appear to be the addition of storm windows and the metal storm doors which protect the original wood entry and some interior decoration. However, by 1940 such metal storm doors and windows were used and they may be original. In context of the MPDF, to be listed individually in the National Register, the Cuba Lodge retains its original doors and windows, fenestration, roof form and materials, its original exterior materials, its exterior symbols and cornerstone, retains a mostly original or early interior, and thus has recognizable physical characteristics representative of its purpose. The building reflects its period of significance between 1940 to 1964 through exterior materials and interior footprint; no new additions have been constructed and no major interior modifications completed. More modern interior decoration changes such as paint, carpeting, or replacement ceilings do not adversely impact the integrity of the building.

The building retains integrity and meets the registration requirements set forth in the MPDF entitled "Historic and Architectural Resources of the City of Cuba, Missouri, 1821-1963" and the associated historic context "Route 66 and the Great Depression, 1926-1945."¹⁹ The property type is characterized as "II-C Secular Institutional Architecture" as a fraternal and social meeting hall and it remains Cuba's sole example eligible for listing in the National Register.

¹⁸ David Taylor. Section F, page 5.

¹⁹ Ibid.

National Register of Historic Places
Continuation Sheet

Section number 9 Page 15

Cuba Lodge No. 312 A. F. & A. M.
Name of Property
Crawford County, Missouri
County and State
Historical and Architectural Resources of the City of Cuba, Missouri, 1821-1963
Name of multiple listing (if applicable)

Bibliography

Boyd, Gregory A. "Family Maps of Crawford County, Missouri." (Arphax Publishing Company, 2006).

Breuer, James Ira. "Crawford County and Cuba, Missouri, with a Supplement, Oak Grove School" (Cape Girardeau, MO: Ramfire Press, 1972).

_____. "History of Cuba's Founding Fathers," Crawford Mirror, January 3, 1974, in Breuer Scrapbooks: Newspapers, 1976—1982, Misc. Articles, located in Crawford County Historical Society, Cuba, Missouri.

Carley, Rachel. "Visual Dictionary of American Domestic Architecture." (New York: Henry Holt and Company, 1997).

City of Cuba Government. Various public records, property data.

Collier, James E. "Geographic Regions of Missouri." In *Annals of the Association of American Geographers*. Volume 45 (December 1955).

Crawford County, Missouri Assessor. Various public records, property data.

"Cuba Centennial: 100 Years of Growth & Progress- 1857-1957." (Cuba, MO: 1957).

Cuba Sesquicentennial Book Committee. "Celebrating 150 Years: A History of Cuba, Missouri- 1857-2007." (Cuba, MO: 2008).

"Gazetteer and Business Directory of the New Southwest." (St. Louis, MO: United States Directory Publishing Company, 1881).

Harvey, Thomas. "Railroad Towns: Urban Form of the Prairie." In *Landscape*. Volume 27, 1983.

Hentzel, David R. "Apples and Shoes: The Economics of a Small Town." (Rolla, MO: The author, 1988).

History of Franklin, Jefferson, Washington, Crawford and Gasconade Counties, Missouri. Chicago: Goodspeed Publishing Company, 1888.

National Register of Historic Places
Continuation Sheet

Section number 9 Page 16

Cuba Lodge No. 312 A. F. & A. M.
Name of Property
Crawford County, Missouri
County and State
Historical and Architectural Resources of the City of Cuba, Missouri, 1821-1963
Name of multiple listing (if applicable)

Ke rste n, Ea rl W., Jr. "Ch a ngi ng Ec o no my a nd La ndsc a pe i n A Mi sso uri O zarks A re a." I n *Annals of the Association of American Geographers*. Vo l u me 48 (1958).

Me r a me c Re gi o na l P la n ni ng Co m mi ssi o n. "Hi s t o r y o f C r a w f o r d Co u n t y—Hi s t o r i c P r e s e r v a t i o n P r o g r a m, P h a s e I V: H i s t o r i c I n v e n t o r y o f C r a w f o r d Co u n t y." P r o j e c t N u m b e r 29-83-7517. N o v e m b e r 1, 1982—S e p t e m b e r 30, 1984.

Mi t c h e l l, S t e v e n E a n d M a r y A u e. "C u b a, C r a w f o r d Co u n t y, A r c h i t e c t u r a l / H i s t o r i c a l S u r v e y." F e b r u a r y 2007, H P F g r a n t # 29-06-21528-612.

M u n r o, A. M a n s o n. "H i s t o r y o f C u b a." P r e p a r e d f o r t h e C e n t e n n i a l, 1957. n.d.

S a n b o m M a p C o m p a n y. "S a n b o m F i r e I n s u r a n c e M a p o f C u b a, M i s s o u r i." (N e w Y o r k: S a n b o m M a p C o m p a n y, 1924 a n d 1933).

S n i d e r, B e c k y L, a n d D e b b i e S h e a l s. "R o u t e 66 i n M i s s o u r i S u r v e y a n d N a t i o n a l R e g i s t e r P r o j e c t, P r o j e c t N o . S7215MSFACG: S u r v e y R e p o r t." J a n u a r y 14, 2003.
<http://www.c.r.nps.gov/rt66/HistSig/MissouriContext.htm>. A c c e s s e d D e c e m b e r 20, 2013.

T a y l o r, D a v i d. "H i s t o r i c a l a n d A r c h i t e c t u r a l R e s o u r c e s o f t h e C i t y o f C u b a, M i s s o u r i, 1821-1963." M u l t i p l e P r o p e r t y D o c u m e n t a t i o n F o r m. 2012.

National Register of Historic Places
Continuation Sheet

Section number 10 Page 17

Cuba Lodge No. 312 A. F. & A. M.
Name of Property
Crawford County, Missouri
County and State
Historical and Architectural Resources of the City of Cuba, Missouri, 1821-1963
Name of multiple listing (if applicable)

Verbal Boundary Description

The Cuba Lodge No. 312 at 201 North Smith Street in Cuba, Crawford County, Missouri, is associated with tax code 21NR-S2-R1-AN and is identified as parcel number 06-9.0-31-1-13-008.000. An outline on the accompanying map entitled "Cuba Lodge No. 312 Boundary Map" indicates the boundary of the nominated property.

Boundary Justification

The nominated property includes the building and the site that is historically associated with the Cuba Lodge.

"Cuba Lodge No. 312 Boundary Map"



1" : 64'

National Register of Historic Places
Continuation Sheet

Section number 10 Page 18

Cuba Lodge No. 312 A. F. & A. M.
Name of Property
Crawford County, Missouri
County and State
Historical and Architectural Resources of the City of Cuba, Missouri, 1821-1963
Name of multiple listing (if applicable)

Photo Key and First Floor Plan



Basement plan

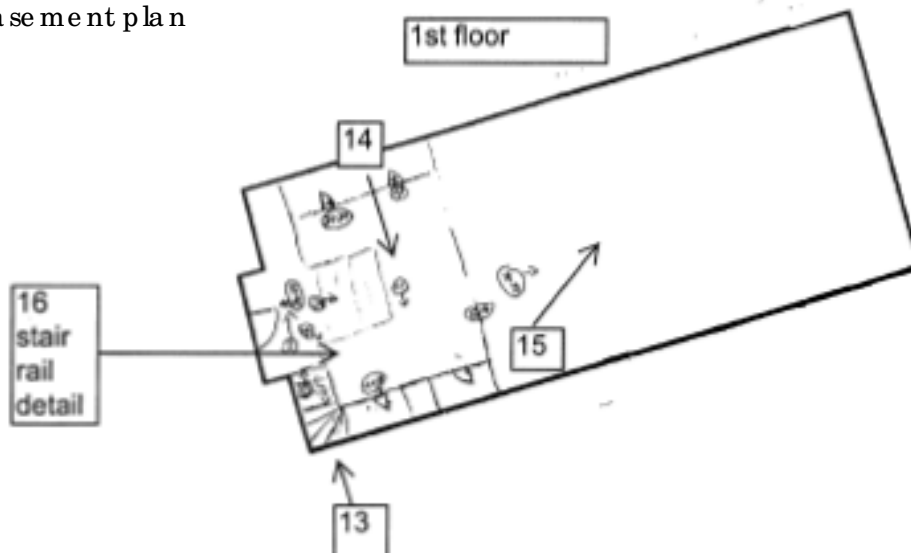





CUBA LODGE

NO. 312 A. F. & A. M.

1887



1940



CUBA LODGE
NO. 312 A.F. & A.M.
1887 1940















32528

MASONIC TEMPLE
CUBA, MO.







