

#1

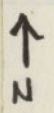

- Hall Street Hist. Dist.
- Proposed Cathedral Hill Hist. Dist.
- Cathedral Hill Survey I
- Cathedral Hill Survey II
- Frederick Ave. Survey

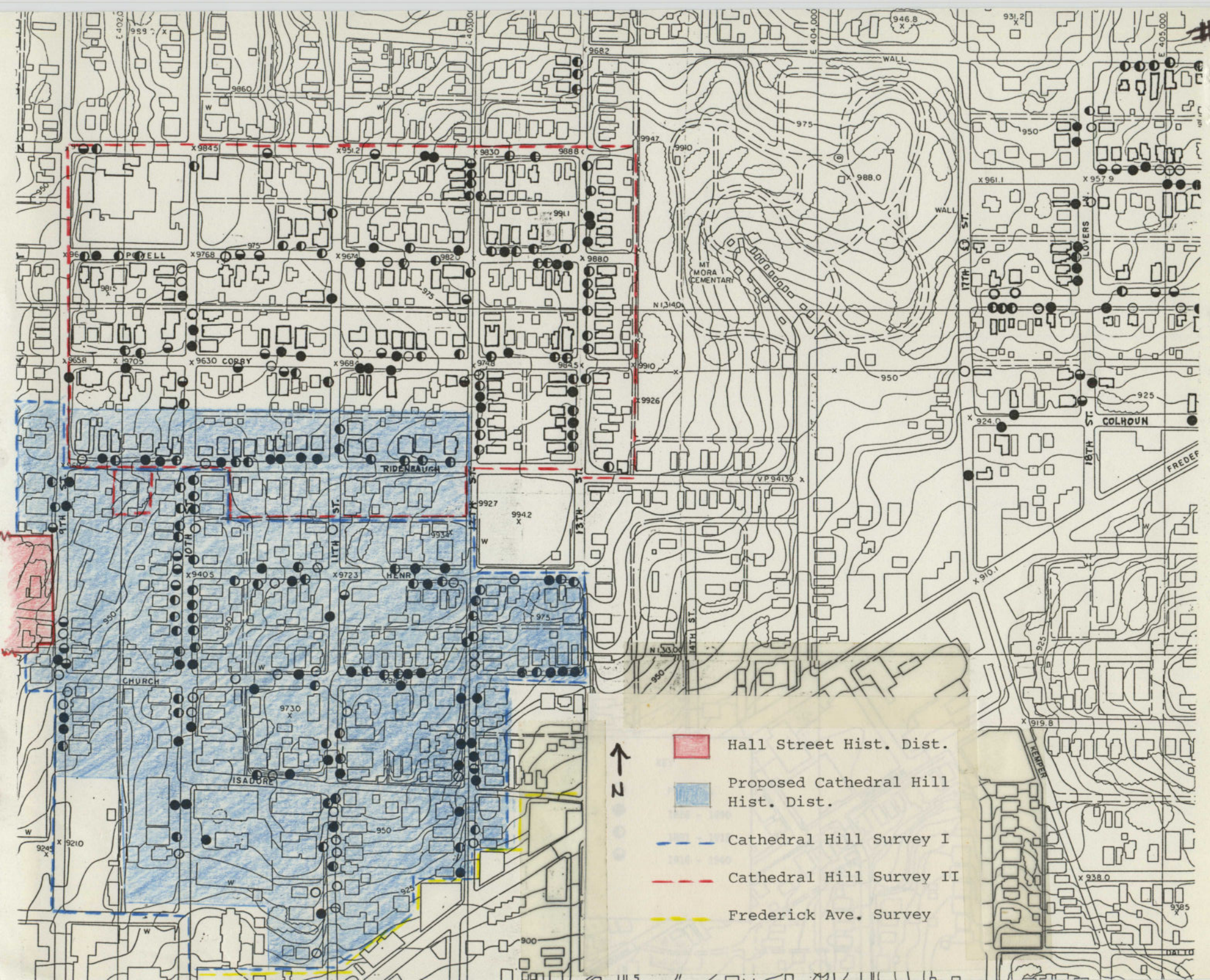
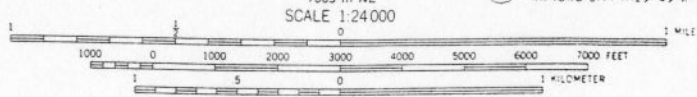
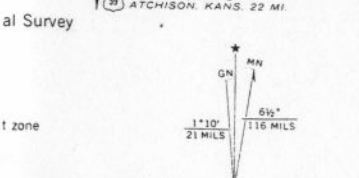

CONTOUR INTERVAL 20 FEET
 DOTTED LINES REPRESENT 5-FOOT CONTOURS
 NATIONAL GEODETIC VERTICAL DATUM OF 1929

THIS MAP COMPLIES WITH NATIONAL MAP ACCURACY STANDARDS
 FOR SALE BY U. S. GEOLOGICAL SURVEY, DENVER, COLORADO 80225, OR RESTON, VIRGINIA 22092
 AND THE DIVISION OF RESEARCH AND TECHNICAL INFORMATION
 MISSOURI DEPARTMENT OF NATURAL RESOURCES, ROLLA, MISSOURI 65401
 AND STATE GEOLOGICAL SURVEY, LAWRENCE, KANSAS 66044
 A FOLDER DESCRIBING TOPOGRAPHIC MAPS AND SYMBOLS IS AVAILABLE ON REQUEST



ROAD CLASSIFICATION

Primary highway, hard surface	Light-duty road, hard or improved surface
Secondary highway, hard surface	Unimproved road
Interstate Route	U. S. Route
	State Route

ST. JOSEPH NORTH, MO.—KANS.

N3945—W9445/7.5
 1971
 PHOTOREVISED 1978
 AMS 7063 IV SE—SERIES V879

al Survey
 3.5 MI. TO HY. U. ATCHISON, KANS. 22 MI.
 (ST. JOSEPH SOUTH) 7063 III NE
 SCALE 1:24 000
 12 MI. TO MO. 31 KANSAS CITY (I-29) 49 MI.
 FAUCETT INTERCHANGE 10 MI. 348 000 E
 28 MI. TO INTERSTATE 35
 INTERIOR—GEOLOGICAL SURVEY, RESTON, VIRGINIA—1978
 2 910 000 FEET (KANS.)
 39° 45'

