

SITE FILE COPY
NATIONAL REGISTER OF HISTORIC PLACES
INVENTORY - NOMINATION FORM
FOR FEDERAL PROPERTIES
(Type all entries - complete applicable sections)

STATE: Missouri
COUNTY: Clay
FOR NPS USE ONLY
ENTRY DATE

1. NAME

COMMON:
Aker Cemetery

AND/OR HISTORIC:

2. LOCATION

STREET AND NUMBER:
NW1/4, NW1/4, NW1/4, Sec. 18, T. 54 N., R. 32 W.

CITY OR TOWN:
Smithville

CONGRESSIONAL DISTRICT:
6th

STATE: **Missouri** CODE: **29** COUNTY: **Clay** CODE: **047**

3. CLASSIFICATION

CATEGORY (Check One)	OWNERSHIP	STATUS	ACCESSIBLE TO THE PUBLIC
<input type="checkbox"/> District <input checked="" type="checkbox"/> Site <input type="checkbox"/> Object <input type="checkbox"/> Building <input type="checkbox"/> Structure 	<input checked="" type="checkbox"/> Public <input type="checkbox"/> Private <input type="checkbox"/> Both 	Public Acquisition: <input type="checkbox"/> In Process <input type="checkbox"/> Being Considered <input type="checkbox"/> Occupied <input checked="" type="checkbox"/> Unoccupied <input type="checkbox"/> Preservation work in progress	Yes: <input type="checkbox"/> Restricted <input checked="" type="checkbox"/> Unrestricted <input type="checkbox"/> No

PRESENT USE (Check One or More as Appropriate)

<input type="checkbox"/> Agricultural	<input type="checkbox"/> Government	<input type="checkbox"/> Park	<input type="checkbox"/> Transportation	<input type="checkbox"/> Comments
<input type="checkbox"/> Commercial	<input type="checkbox"/> Industrial	<input type="checkbox"/> Private Residence	<input type="checkbox"/> Other (Specify)	
<input type="checkbox"/> Educational	<input type="checkbox"/> Military	<input type="checkbox"/> Religious	Pasture	
<input type="checkbox"/> Entertainment	<input type="checkbox"/> Museum	<input type="checkbox"/> Scientific		

4. AGENCY

U.S. Army Corps of Engineers

REGIONAL HEADQUARTERS: (If applicable)
Kansas City District

CITY OR TOWN:
Kansas City

STREET AND NUMBER:
601 East 12th Street

STATE: **Missouri** CODE: **29**

5. LOCATION OF LEGAL DESCRIPTION

COURTHOUSE, REGISTRY OF DEEDS, ETC.:
Clay Court, Registry of Deeds

STREET AND NUMBER:

CITY OR TOWN:
Liberty

STATE: **Missouri** CODE: **29**

6. REPRESENTATION IN EXISTING SURVEYS

TITLE OF SURVEY:
No published survey of this area concerning historical sites and cemeteries

DATE OF SURVEY: Federal State County Local

DEPOSITORY FOR SURVEY RECORDS:

STREET AND NUMBER:

CITY OR TOWN: STATE: CODE:

STATE:

COUNTY:

FOR NPS USE ONLY

ENTRY NUMBER

DATE

SEE INSTRUCTIONS

Incl 1

7. DESCRIPTION

CONDITION	(Check One)					
	<input type="checkbox"/> Excellent	<input type="checkbox"/> Good	<input type="checkbox"/> Fair	<input checked="" type="checkbox"/> Deteriorated	<input type="checkbox"/> Ruins	<input type="checkbox"/> Unexposed
	(Check One)			(Check One)		
	<input type="checkbox"/> Altered	<input checked="" type="checkbox"/> Unaltered		<input type="checkbox"/> Moved	<input checked="" type="checkbox"/> Original Site	

DESCRIBE THE PRESENT AND ORIGINAL (if known) PHYSICAL APPEARANCE

The Aker Cemetery is located about 3 miles northeast of the city of Smithville, Clay County, Missouri, in NW $\frac{1}{4}$, NW $\frac{1}{4}$, NW $\frac{1}{4}$ Sec. 18, T-54-N, R-32-W.

The Cemetery is in a deteriorated condition with the stones lying on the ground. The site is within a wooded area with very little undergrowth present because of heavy shade from the large trees. The area is grassed and several large limbs are scattered around the area.

At the site, there are 10 markers of commercial variety with the following information:

John Aker	d. August 21, 1835
Mary Aker	d. April 4, 1881
Charlotta McMillan	d. December 20, 1870
Infant son of R&C McMillan	no date
Susan Fry	d. December 11, 1863
Sarah Fry	d. December 17, 1863
Mahuldah Poteet	d. July 27, 1871
Archie Cavender	d. January 20, 1882
Novellah Aker	Born 1862 d. No date
George Cavender	d. September 18, 1881
Rosanna McMillan	d. October 7, 1855

In addition to the commercial markers, there are fieldstones that have been set to mark graves. Depressions in the ground also indicated graves. It is estimated that there are 25 graves counting the commercial stones, fieldstones, and depressions.

The original physical appearance is not known.

SEE INSTRUCTIONS

8. SIGNIFICANCE

PERIOD (Check One or More as Appropriate)

- | | | | |
|--|---------------------------------------|--|---------------------------------------|
| <input type="checkbox"/> Pre-Columbian | <input type="checkbox"/> 16th Century | <input type="checkbox"/> 18th Century | <input type="checkbox"/> 20th Century |
| <input type="checkbox"/> 15th Century | <input type="checkbox"/> 17th Century | <input checked="" type="checkbox"/> 19th Century | |

SPECIFIC DATE(S) (If Applicable and Known)

established about 1828

AREAS OF SIGNIFICANCE (Check One or More as Appropriate)

- | | | | |
|---|---------------------------------------|---|--|
| <input type="checkbox"/> Aboriginal | <input type="checkbox"/> Education | <input type="checkbox"/> Political | <input type="checkbox"/> Urban Planning |
| <input type="checkbox"/> Prehistoric | <input type="checkbox"/> Engineering | <input type="checkbox"/> Religion/Philosophy | <input type="checkbox"/> Other (Specify) |
| <input type="checkbox"/> Historic | <input type="checkbox"/> Industry | <input type="checkbox"/> Science | _____ |
| <input type="checkbox"/> Agriculture | <input type="checkbox"/> Invention | <input type="checkbox"/> Sculpture | _____ |
| <input type="checkbox"/> Architecture | <input type="checkbox"/> Landscape | <input checked="" type="checkbox"/> Social/Humanitarian | _____ |
| <input type="checkbox"/> Art | <input type="checkbox"/> Architecture | <input type="checkbox"/> Theater | _____ |
| <input type="checkbox"/> Commerce | <input type="checkbox"/> Literature | <input type="checkbox"/> Transportation | _____ |
| <input type="checkbox"/> Communications | <input type="checkbox"/> Military | | |
| <input type="checkbox"/> Conservation | <input type="checkbox"/> Music | | |

STATEMENT OF SIGNIFICANCE

The Aker Cemetery was started as the family burial plot for the first white settlers in the Platte River valley above the present community of Smithville, Missouri. John and Mary Aker accumulated 500 acres of land after first entering land from the Government in 1828. John Aker was born in Pennsylvania in 1785 to German parents. In 1812 he married Mary Sidener also of German decent. John and Mary Aker migrated from Kentucky to Clay County, Missouri, with several small children. The Akers had a total of 12 children. Members of other early families in the area are also buried in the cemetery, some of who had married into the Aker family.

The Aker Cemetery is the only remaining evidence of the initial settlers in the area as the original homestead buildings have been destroyed. The most recent known burial in the cemetery was 92 years ago.

This cemetery was not officially listed as such nor has it been commercially maintained. Its existence and location became known at the acquisition of land for the authorized Smithville Dam and Lake. The cemetery is located on the crest of a wooded hill presently overlooking the Platte River valley. Plans for the Smithville project propose the development of the hill for public recreational use. The cemetery will be above the full pool elevation of the completed Smithville Lake, and not subject to inundation. The wooded area surrounding the cemetery provides a very picturesque setting from which an overview of the completed Smithville Lake will be afforded. The integrity of the cemetery and setting can be maintained without major effort or expenditure of funds.

Local historical groups have become very interested in the cemetery and have done considerable research concerning the decedents of those buried in the Aker cemetery. The local sponsors, that will cooperatively develop the recreation facilities for public use of the Smithville Lake, have expressed an interest in the cemetery. They propose to develop the area with the cemetery being an historic and cultural site as the central theme of the entire proposed public use area. The planned development will assure the maintenance and protection of the cemetery, and also make it available for public visitation, study, and enjoyment.

At this time the local sponsor for the public use area is Clay County.

SEE INSTRUCTIONS

9. MAJOR BIBLIOGRAPHICAL REFERENCES

10. GEOGRAPHICAL DATA

LATITUDE AND LONGITUDE COORDINATES DEFINING A RECTANGLE LOCATING THE PROPERTY			O R	LATITUDE AND LONGITUDE COORDINATES DEFINING THE CENTER POINT OF A PROPERTY OF LESS THAN TEN ACRES		
CORNER	LATITUDE	LONGITUDE		LATITUDE	LONGITUDE	
	Degrees Minutes Seconds	Degrees Minutes Seconds		Degrees Minutes Seconds	Degrees Minutes Seconds	
NW	° ' "	° ' "		39° 22' 10"	94° 32' 27"	
NE	° ' "	° ' "				
SE	° ' "	° ' "				
SW	° ' "	° ' "				

APPROXIMATE ACREAGE OF NOMINATED PROPERTY: **.5**

LIST ALL STATES AND COUNTIES FOR PROPERTIES OVERLAPPING STATE OR COUNTY BOUNDARIES

STATE:	CODE	COUNTY:	CODE

11. FORM PREPARED BY

NAME AND TITLE: **COL W. R. NEEDHAM, District Engineer** DATE: **24 January 1974**

BUSINESS ADDRESS: **Corps of Engineers, Kansas City District**

STREET AND NUMBER: **601 East 12th Street, 700 Federal Building** PHONE: **816-374-3202**

CITY OR TOWN: **Kansas City** STATE: **Missouri** CODE: **29**

12. CERTIFICATION OF NOMINATION

NATIONAL REGISTER VERIFICATION

State Liaison Officer recommendation:

Yes

No

None

State Liaison Officer Signature

In compliance with Executive Order 11593, I hereby nominate this property to the National Register, certifying that the State Liaison Officer has been allowed 90 days in which to present the nomination to the State Review Board and to evaluate its significance. The recommended level of significance is National State Local

Federal Representative Signature

Date

Title

I hereby certify that this property is included in the National Register.

Director, Office of Archeology and Historic Preservation

Date _____

ATTEST:

Keeper of The National Register

Date _____

SEE INSTRUCTIONS

NATIONAL REGISTER OF HISTORIC PLACES
PROPERTY MAP FORM

(Type all entries - attach to or enclose with map)

STATE	
Missouri	
COUNTY	
Clay	
FOR NPS USE ONLY	
ENTRY NUMBER	DATE

SEE INSTRUCTIONS

1. NAME			
COMMON: Aker Cemetery			
AND/OR HISTORIC:			
2. LOCATION			
STREET AND NUMBER:			
NW1/4, NW1/4, NW1/4, Sec 18, T. 54 N., R. 32 W.			
CITY OR TOWN:			
Smithville			
STATE:	CODE	COUNTY.	CODE
Missouri	29	Clay	047
3. MAP REFERENCE			
SOURCE:			
USGS 7.5' Series (N3922.5-W943017.5')			
SCALE: 1:24000			
DATE: 1961			
4. REQUIREMENTS			
TO BE INCLUDED ON ALL MAPS			
1. Property boundaries where required.			
2. North arrow.			
3. Latitude and longitude reference.			

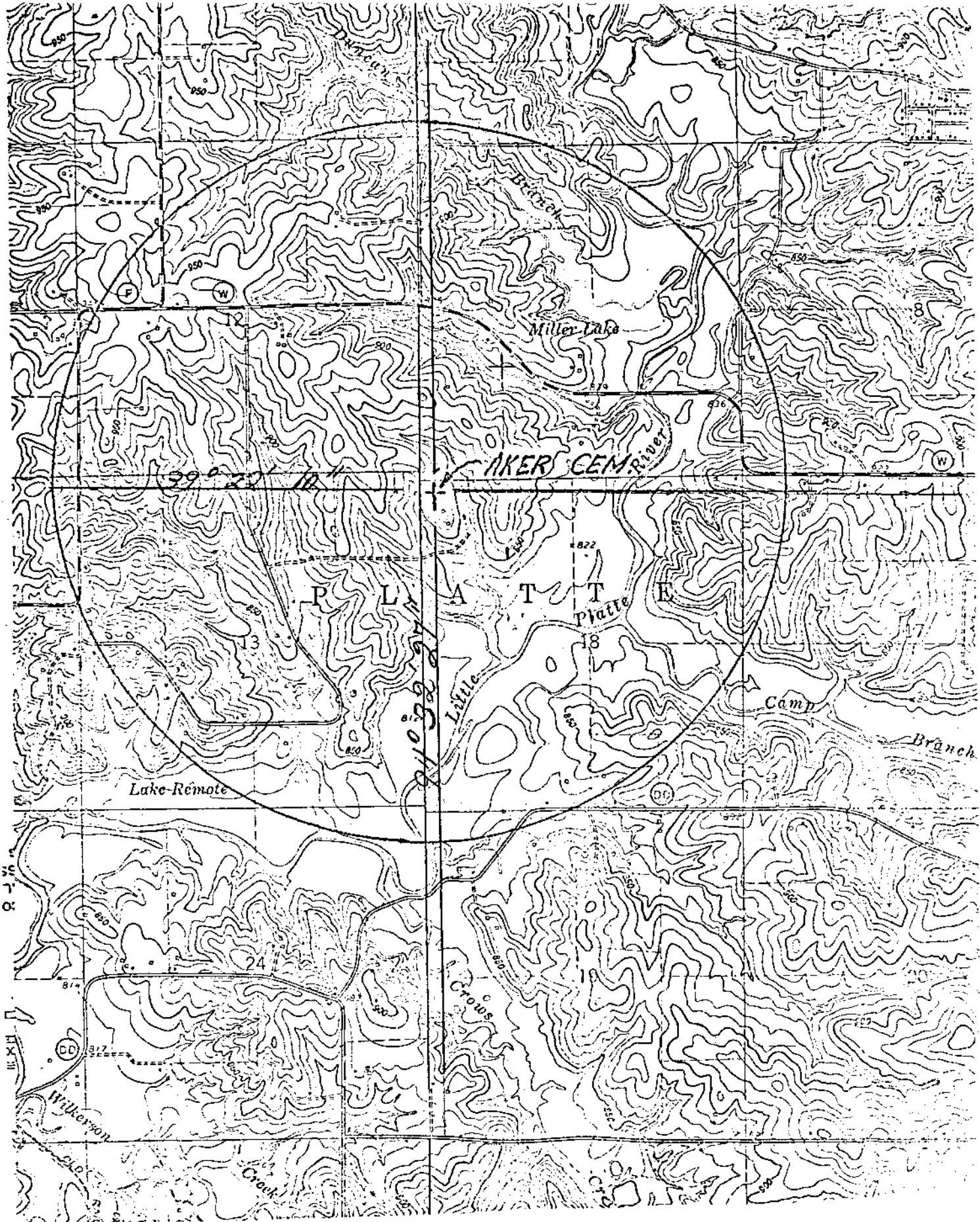

Miller Lake

PLATTE RIVER

P L A T T E

Platte

Camp

Branch

Lake-Remote

Lake

Crows

Wilkerson

Creek

99022

110302

9-1-1

11-11

UNITED STATES DEPARTMENT OF THE INTERIOR
NATIONAL PARK SERVICE

NATIONAL REGISTER OF HISTORIC PLACES
PROPERTY PHOTOGRAPH FORM

(Type all entries - attach to or enclose with photograph)

1. NAME		STATE
COMMON: Aker Cemetery		Missouri
AND/OR HISTORIC:		COUNTY
2. LOCATION		Clay
STREET AND NUMBER: NW1/4, NW1/4, Sec 18, T. 54 N., R. 32 W.		FOR NPS USE ONLY
CITY OR TOWN: Smithville		ENTRY NUMBER
STATE: Missouri		DATE
3. PHOTO REFERENCE		CODE
PHOTO CREDIT: Dean Johnson		29
DATE OF PHOTO: 22 March 1973		COUNTY: Clay
NEGATIVE FILED AT: Corps of Engineers, Kansas City District		CODE
4. IDENTIFICATION		047
DESCRIBE VIEW, DIRECTION, ETC. Looking north. The picture shows the northern portion of cemetery.		

SEE INSTRUCTIONS



#223

AKER CEMETERY

COUNTY: Clay
LOCATION: 3 mi NE of Smithville, Mo.
OWNER: U.S. Army Corps of Engineers, K.C. District
ADDRESS: 601 E. 12th Street, Kansas City, Mo.
DATE OF SHPO APPROVAL: 03-01-74
DATE PLACED ON NATIONAL REGISTER: 11-13-74
DATE AWARDED CERTIFICATE
(AND PRESENTOR): 9-23-76
Orval L. Henderson, Jr.
DATE FILE REVIEWED:

Aker Cemetery is the only remaining evidence of the initial settlers in the area as the original homestead buildings have been destroyed. The most recent known burial in the cemetery was 92 years ago.

UNITED STATES DEPARTMENT OF THE INTERIOR
NATIONAL PARK SERVICE

NATIONAL REGISTER OF HISTORIC PLACES
PROPERTY PHOTOGRAPH FORM

(Type all entries - attach to or enclose with photograph)

STATE	Missouri
COUNTY	Clay
FOR NPS USE ONLY	
ENTRY NUMBER	DATE

1. NAME

COMMON: Aker Cemetery
AND/OR HISTORIC:

2. LOCATION

STREET AND NUMBER:
NW1/4, NW1/4, Sec 18, T. 54 N., R. 32 W.
CITY OR TOWN:
Smithville
STATE:
Missouri

CODE	COUNTY
29	Clay

CODE
047

3. PHOTO REFERENCE

PHOTO CREDIT: Dean Johnson
DATE OF PHOTO: 22 March 1973
NEGATIVE FILED AT:

Corps of Engineers, Kansas City District

4. IDENTIFICATION

DESCRIBE VIEW, DIRECTION, ETC.

Looking north. The picture shows the northern portion of cemetery.

SEE INSTRUCTIONS

