

The Pacific-Sprigg Survey

Part V

William to Themis Street

Cape Girardeau, Missouri

Conducted by
Students of the Historic Preservation Program
Southeast Missouri State University

Spring, 2004

Michael Culler
Julie Elgin
Margaret Harmon
Lacey Illers

Kim Leazenby
Eric McNeal
Pam Watson

Survey Coordinator: Doug Gasek

Assistant Survey Coordinators: Lisa Graham, Sarah
Kliethermes, and Sarah Kate Parker

HP 588: Legal and Economic Principles of Historic Preservation
Dr. Steven J. Hoffman

Pacific-Sprigg Survey

Part V

William to Themis Street

Students in the Legal and Economic Principles of Historic Preservation class (HP 588), under the guidance of Dr. Steven Hoffman, continued the architectural survey of homes in the Pacific-Sprigg Historic District in Cape Girardeau, Missouri. The main purpose of this survey was to construct an inventory of the residential buildings in the neighborhood for the Historic Preservation Commission of Cape Girardeau.

The area surveyed in Part V extends from Lorimier Street on the east, Sprigg Street on the west, Themis Street on the north and William Street on the south, and completes the survey of the Pacific-Sprigg district.

The Pacific-Sprigg historic district is representative of the kinds of neighborhoods built in Cape Girardeau during the late nineteenth and early twentieth centuries. This neighborhood contains many fine examples of dwellings built by Cape's growing middle class during this period, including houses in the Queen Anne, Craftsman Bungalow, and American Four Square styles. The area as a whole has retained its integrity despite a number of houses with significant alteration and the intrusion of several noncontributing properties.

Methodology

At the request of the Cape Girardeau Historic Preservation Commission, in the Spring of 2000, students in HP 588: Legal and Economic Principles of Historic Preservation extended their Historic Resource Survey to include the historic neighborhoods adjacent to the downtown. The Commission asked the class to survey the area bounded by Pacific Street on the West, Sprigg Street on the East, extending from Morgan Oak on the South to Bellevue Street on the North. An additional area included in the survey district is bounded by Fountain Street on the East, William Street on the South, Independence Street on the North and Sprigg Street on the West and the block comprised of Themis Street on the South, Fountain on the West, Independence on the North and Lorimer on the East. Archival research and reconnaissance survey indicate this entire area as having strong potential as a historic district. Due to the limited time available, only a portion of the district can be surveyed in any given semester. Part V the survey of the designated area includes all of the properties north of William Street and west of Lorimer Street not previously surveyed.

Students worked in teams of two each, with each team assigned ten to twenty buildings. Each team distributed flyers to homeowners in the neighborhood to inform them of the survey. The students documented their assigned buildings, including taking photographs, researching the history of the building with the use of property tax records and filling out State of Missouri Historic Resource Survey forms based on observations of the building from the street.

This information was compiled, photocopied, and bound. One copy was presented to the Historic Preservation Commission of Cape Girardeau, one copy deposited in the Regional Archives of Southeast Missouri State University, and one copy retained by the Historic Preservation Program, Department of History, Southeast Missouri State University. Upon completion of the survey of the entire district, the original forms and photographs will be forwarded to the State Office of Historic Preservation, Department of Natural Resources in Jefferson City, MO.

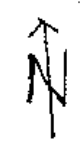
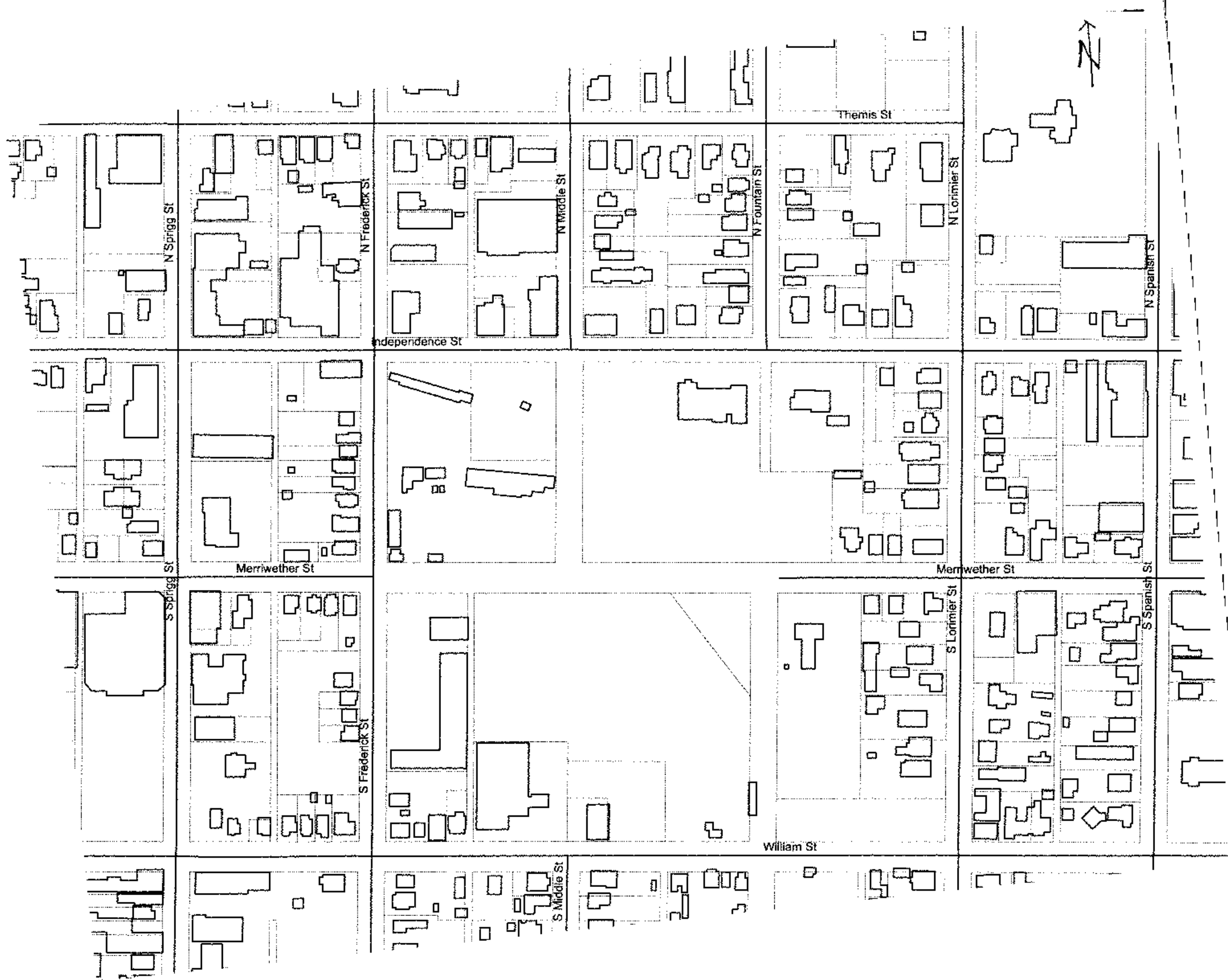

N Sprigg St

N Frederick St

N Middle St

N Fountain St

N Lorimer St

N Spanish St

Independence St

Merriwether St

Merriwether St

S Sprigg St

S Frederick St

S Middle St

S Lorimer St

S Spanish St

William St

Themis St

Acknowledgments

The staff of University Printing and Duplicating for all their help in developing all the photographs included in this survey, and well as duplicating and binding the final report.

Cape Girardeau County Employees: For helping with the Property Tax Records of the many buildings included in this survey.

District Homeowners: For their cooperation and assistance.

Employees of Cape Girardeau City Hall, especially Ms. Brenda Schloss, for providing assistance and maps of the survey area.

Cape Girardeau Historic Preservation Commission: For providing assistance and support for continuing survey work in Cape Girardeau.