

REFERENCE MAP  
ANDREW COUNTY, MISSOURI

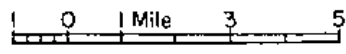

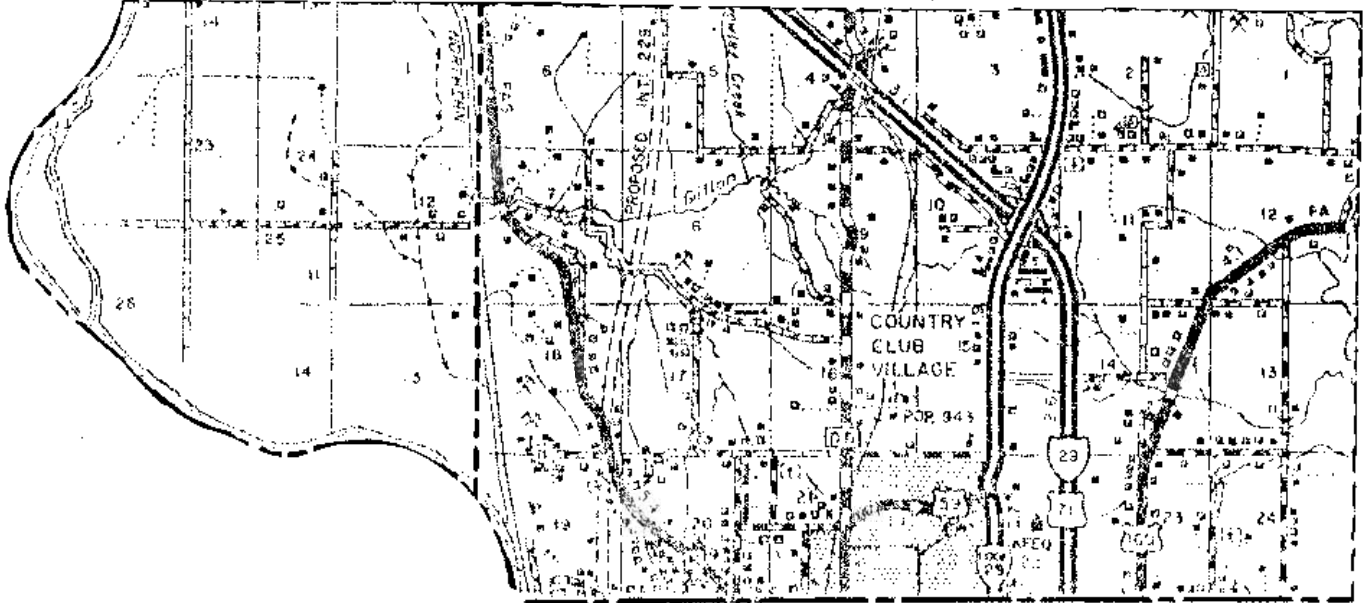

HISTORIC SITES MAP · ANDREW COUNTY, MISSOURI  
 TOWNSHIP 58 N  
 RANGE 35 W, 36 W

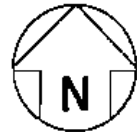
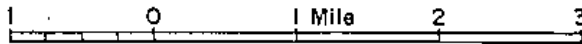

No architectural or historical sites available during this portion of the survey.

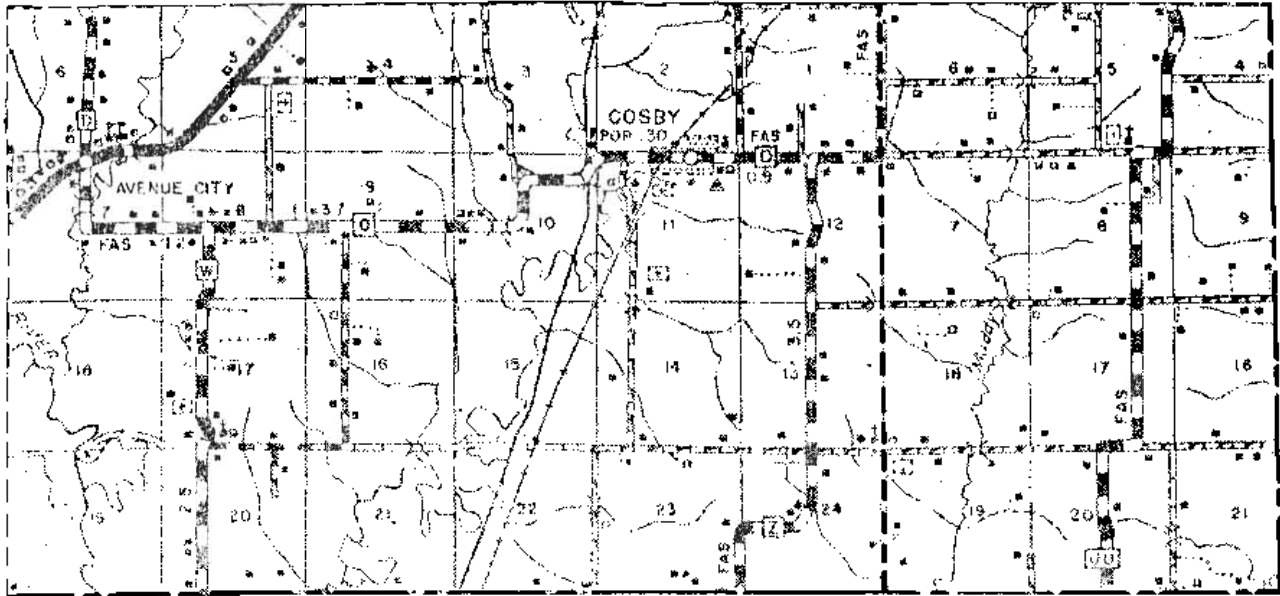

HISTORIC SITES MAP - ANDREW COUNTY, MISSOURI  
TOWNSHIP 58 N  
RANGE 33 W, 34 W

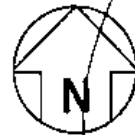
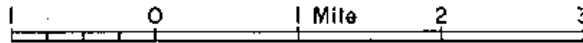

No architectural or historical sites available during this portion of the survey

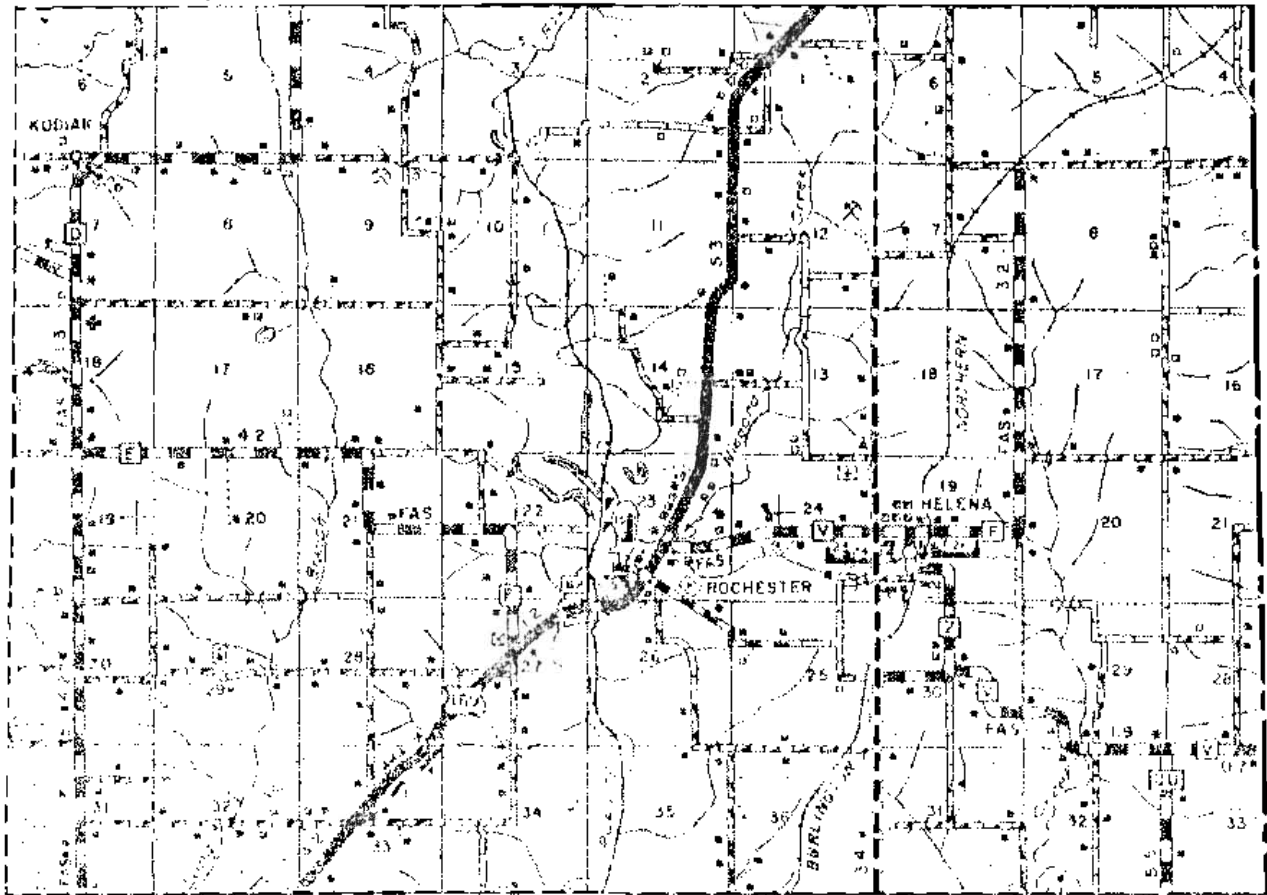

HISTORIC SITES MAP · ANDREW COUNTY, MISSOURI  
 TOWNSHIP 59 N  
 RANGE 33W, 34W

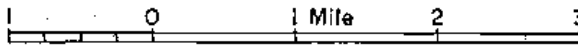

No architectural or historical sites available during this portion of the survey.

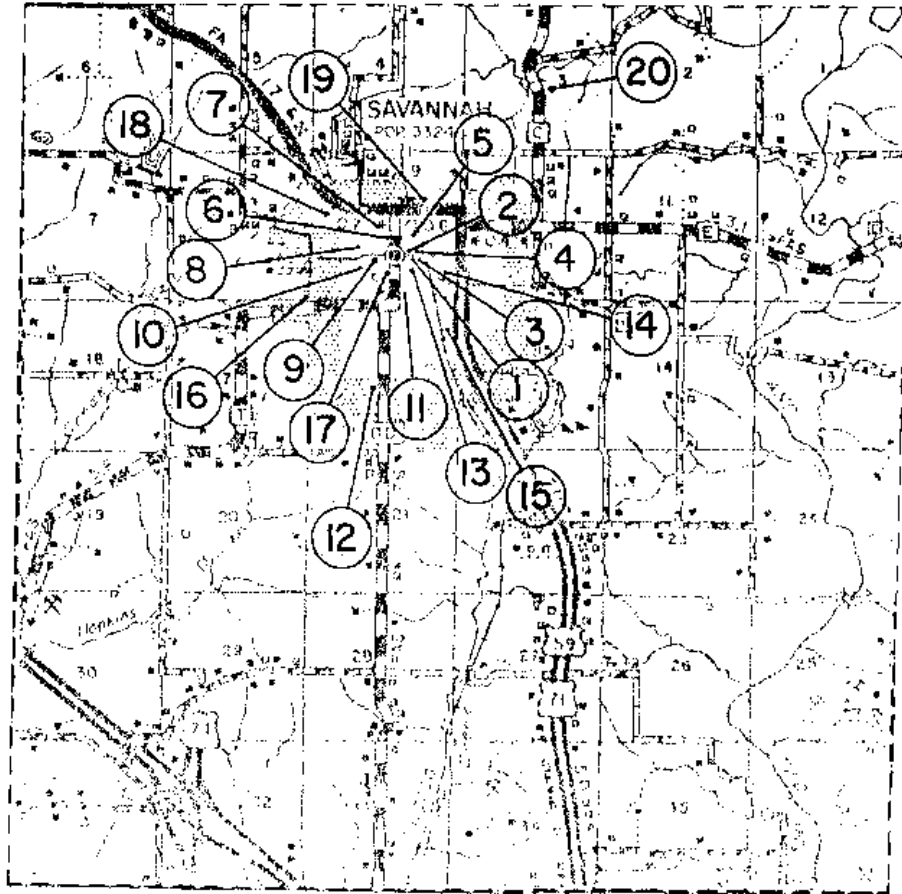

HISTORIC SITES MAP · ANDREW COUNTY, MISSOURI  
 TOWNSHIP 59 N  
 RANGE 35 W

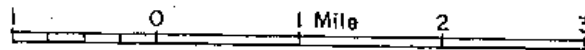

- |                                |                                  |
|--------------------------------|----------------------------------|
| 1- Andrew County Court House   | 11- The Jackson Funeral Home     |
| 2- The Home Bank Building      | 12- H.B. McDonald House          |
| 3- Masonic Hall                | 13- Savannah Reporter Building   |
| 4- The United Methodist Church | 14- Loren Roberts House          |
| 5- St. Mary's Episcopal Church | 15- The Lloyd Davis Home         |
| 6- The Clasbey Home            | 16- The Georgia Whitchurch House |
| 7- Ed. V. Price Public Library | 17- The McKnight House           |
| 8- Julia Young's Home          | 18- The Henderson House          |
| 9- St. John House              | 19- The Sloan Young House        |
| 10- The Grover Callaway House  | 20- The Amos Cobb House          |

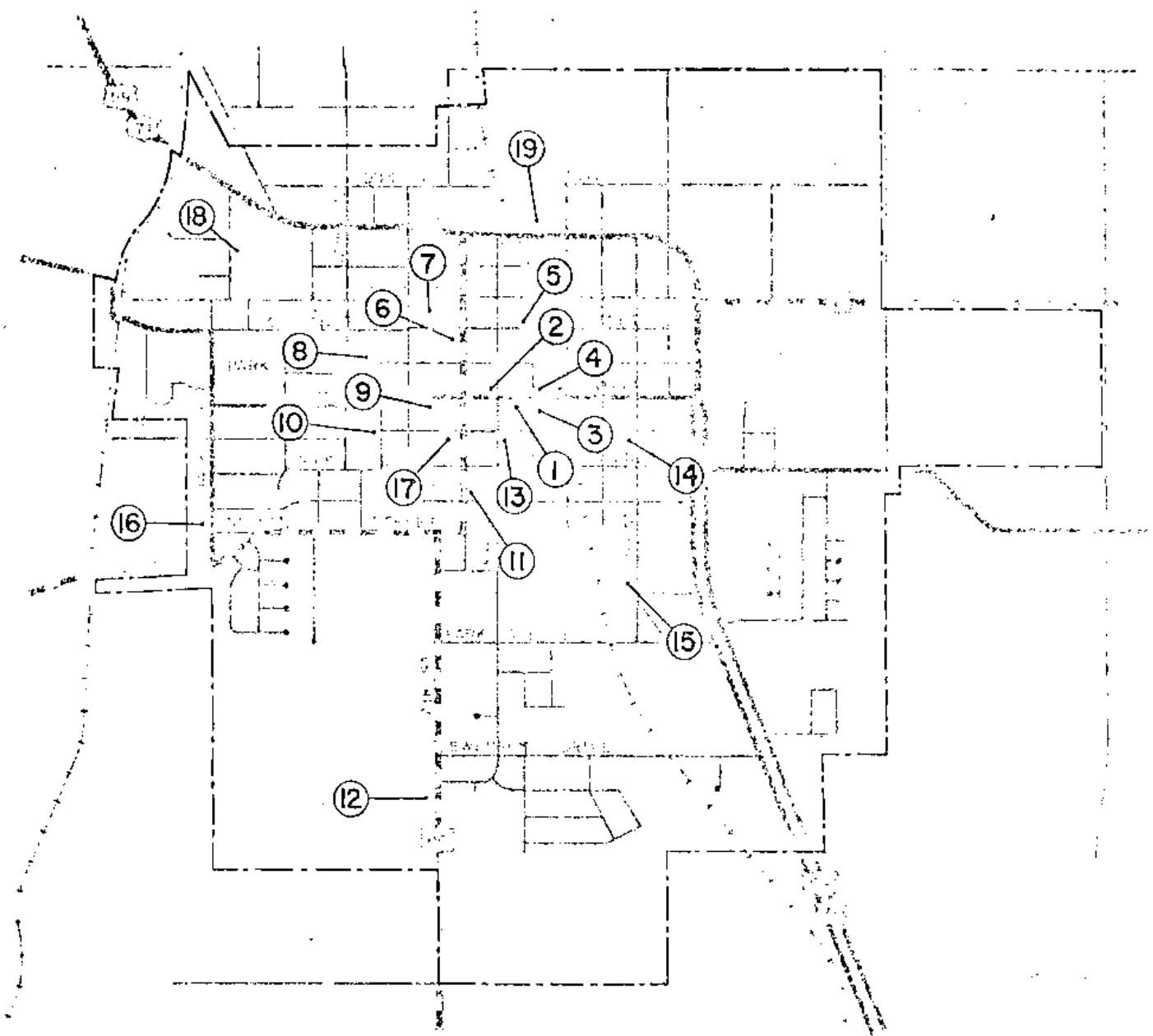

HISTORIC SITES MAP  
SAVANNAH, MISSOURI

1000 0 1000 Feet 3000



- |                                |                                  |
|--------------------------------|----------------------------------|
| 1- Andrew County Court House   | 11- The Jackson Funeral Home     |
| 2- The Home Bank Building      | 12- H.B. McDonald House          |
| 3- Masonic Hall                | 13- Savannah Reporter Building   |
| 4- The United Methodist Church | 14- Loren Roberts House          |
| 5- St. Mary's Episcopal Church | 15- The Lloyd Davis Home         |
| 6- The Clasbey Home            | 16- The Georgia Whitchurch House |
| 7- Ed. V. Price Public Library | 17- The McKnight House           |
| 8- Julia Young's Home          | 18- The Henderson House          |
| 9- St. John House              | 19- The Sloan Young House        |
| 10- The Grover Callaway House  |                                  |

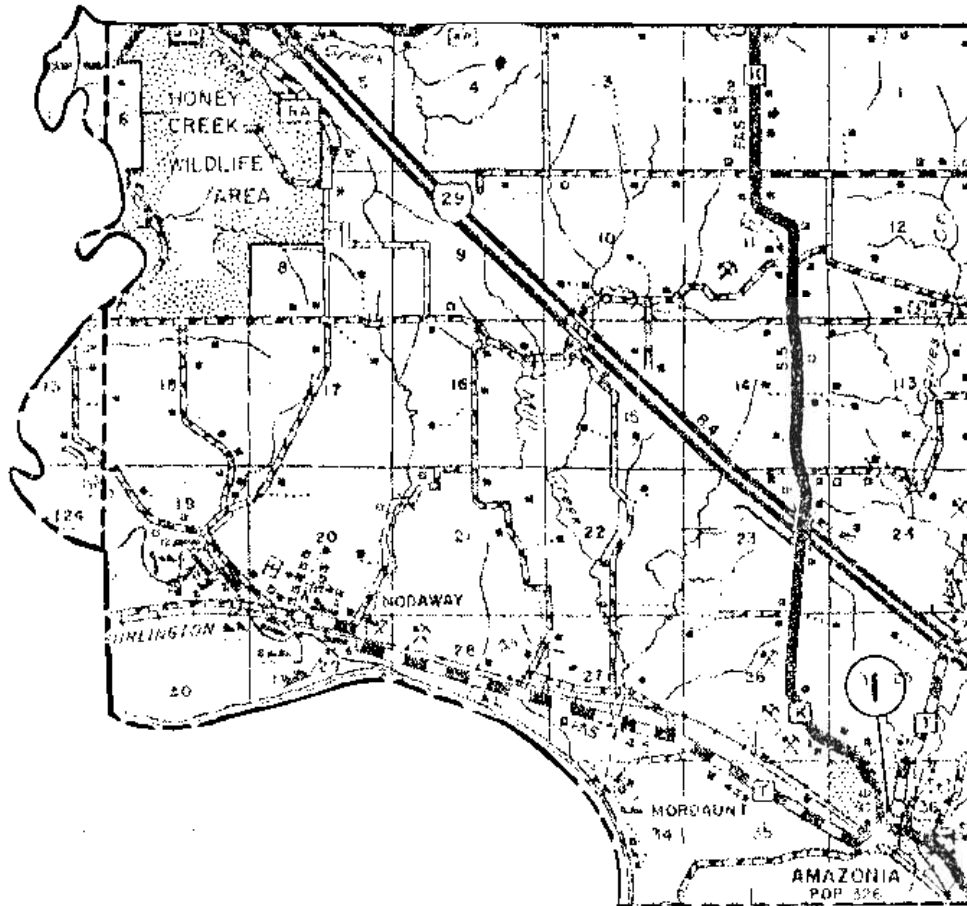

HISTORIC SITES MAP · ANDREW COUNTY, MISSOURI  
 TOWNSHIP 59 N  
 RANGE 36 W, 37 W

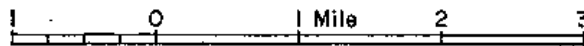

1- Parsonage for St. John's Evangelical and Reform Church

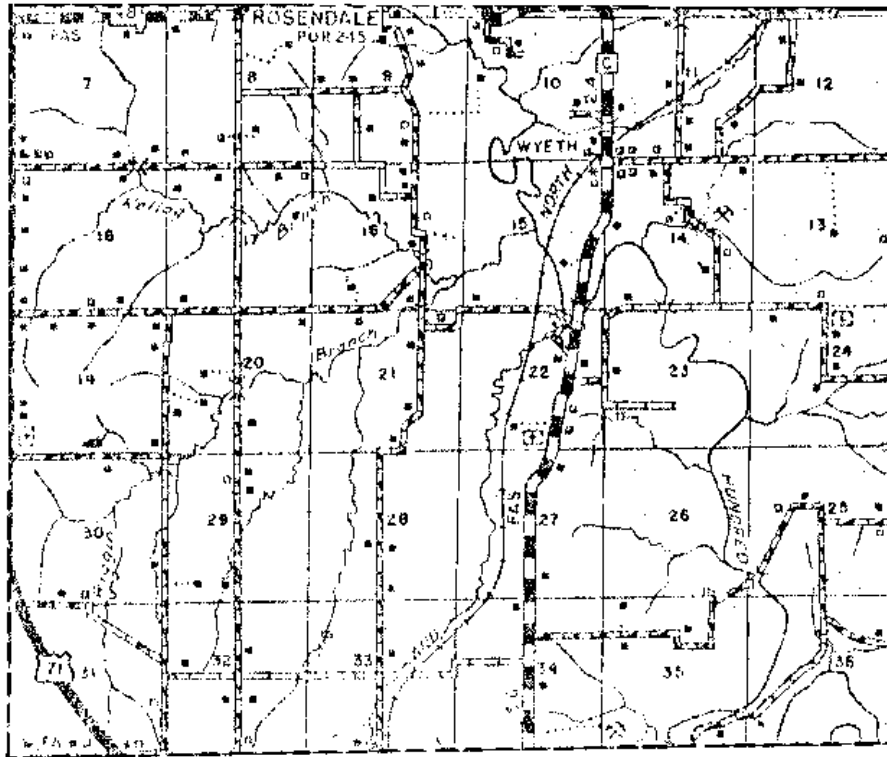

HISTORIC SITES MAP · ANDREW COUNTY, MISSOURI  
 TOWNSHIP 60 N  
 RANGE 35 W

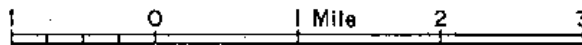

No architectural or historical sites available during this portion of the survey

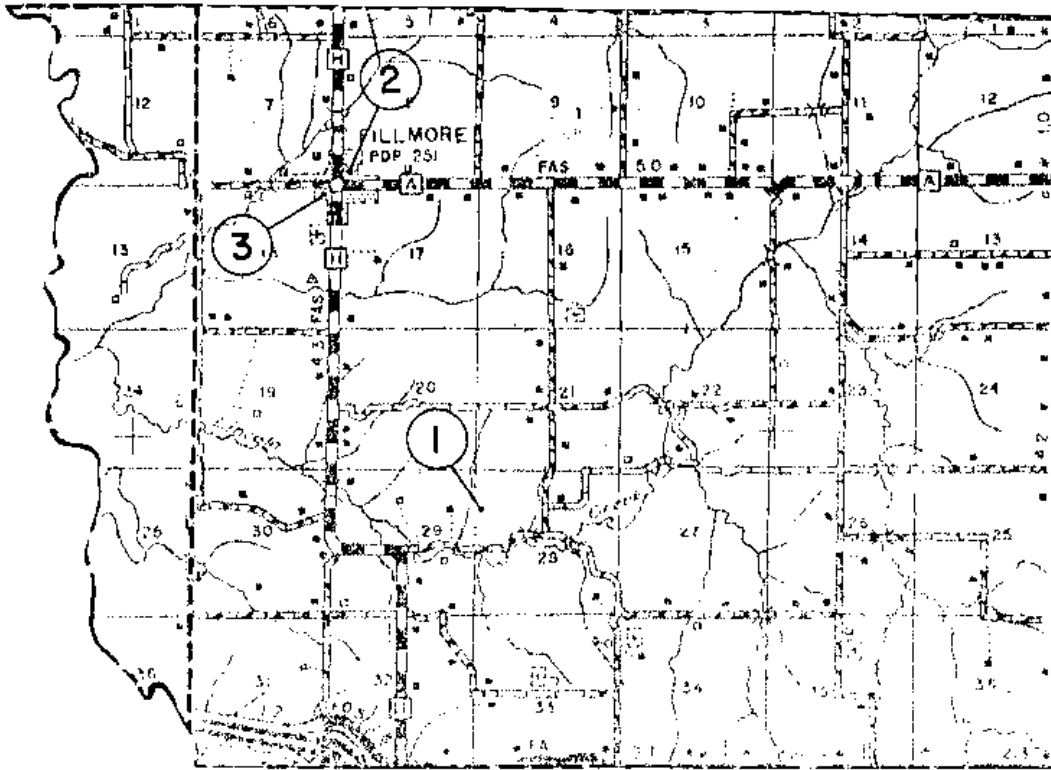

HISTORIC SITES MAP · ANDREW COUNTY, MISSOURI  
 TOWNSHIP 60 N  
 RANGE 36W, 37W

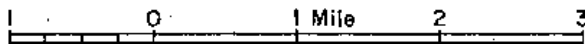

- 1- The Walker House
- 2- Old Hotel Building
- 3- Landmark Ceramics

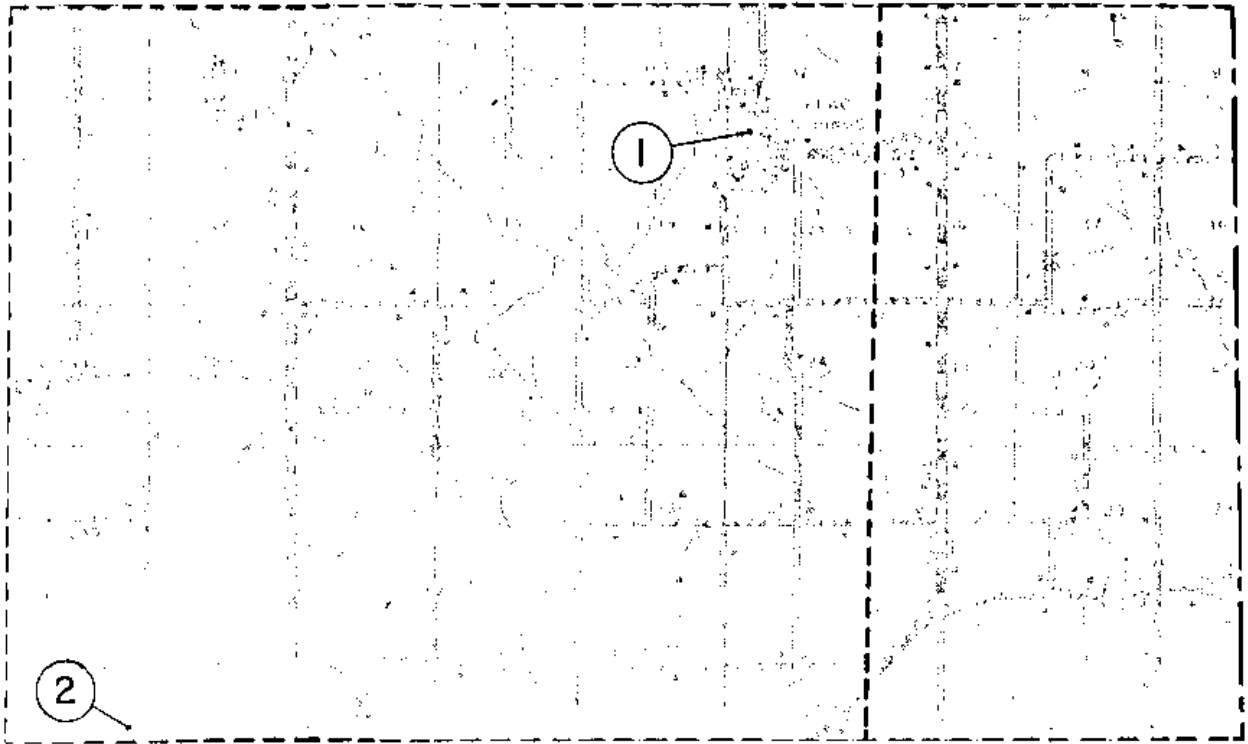

HISTORIC SITES MAP · ANDREW COUNTY, MISSOURI  
TOWNSHIP 60 N  
RANGE 33W, 34W

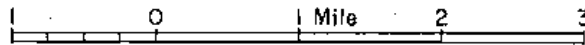

- 1- Flag Springs Distillery
- 2. C.M. Daily House

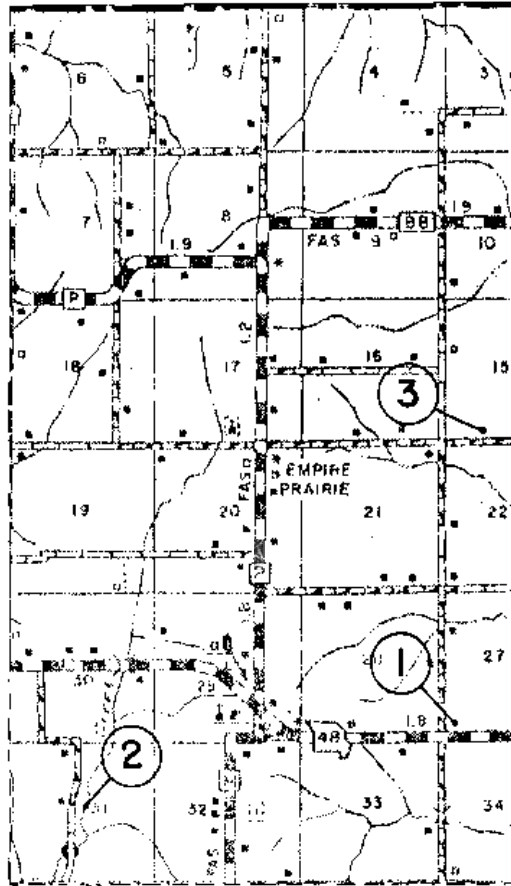

HISTORIC SITES MAP · ANDREW COUNTY, MISSOURI  
 TOWNSHIP 61 N  
 RANGE 33 W

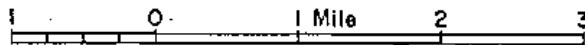

- 1- The William Bulla Home
- 2- The Wilson Huntsman Barn
- 3- The Bennett Home

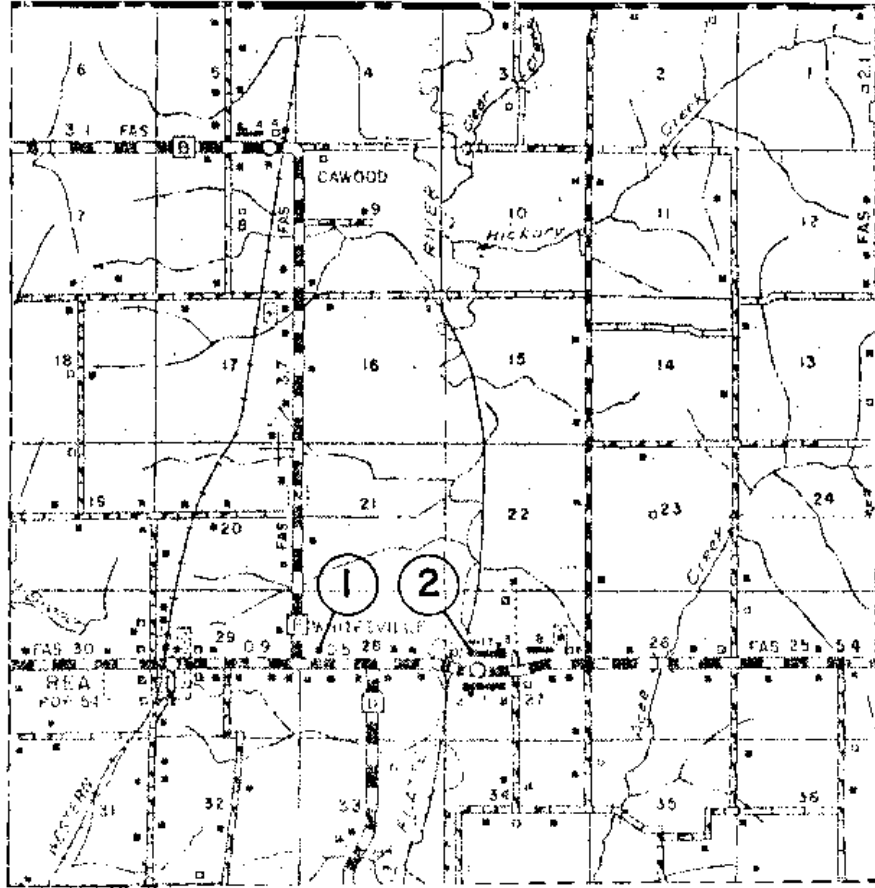

HISTORIC SITES MAP · ANDREW COUNTY, MISSOURI  
 TOWNSHIP 61 N  
 RANGE 34 W

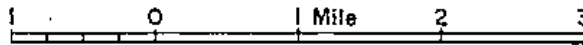

1- Clark Barn

2- Whitesville Lodge No. 162

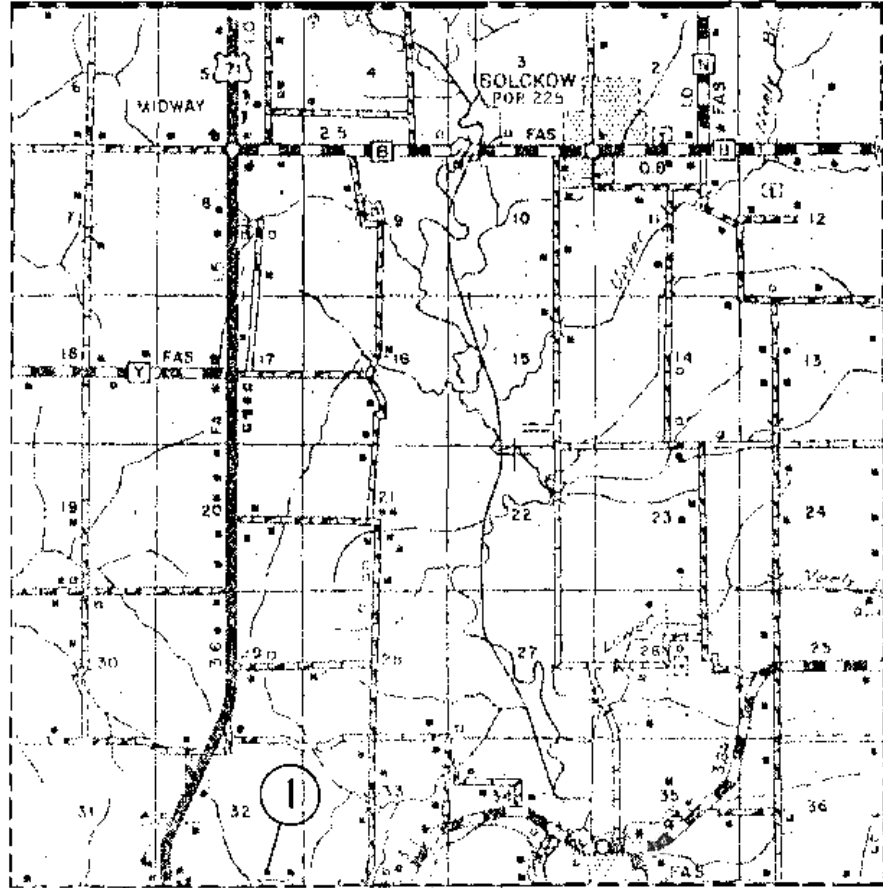

HISTORIC SITES MAP · ANDREW COUNTY, MISSOURI  
 TOWNSHIP 61 N  
 RANGE 35 W

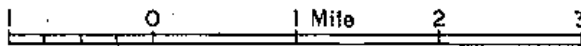

1- Lester Fothergill House

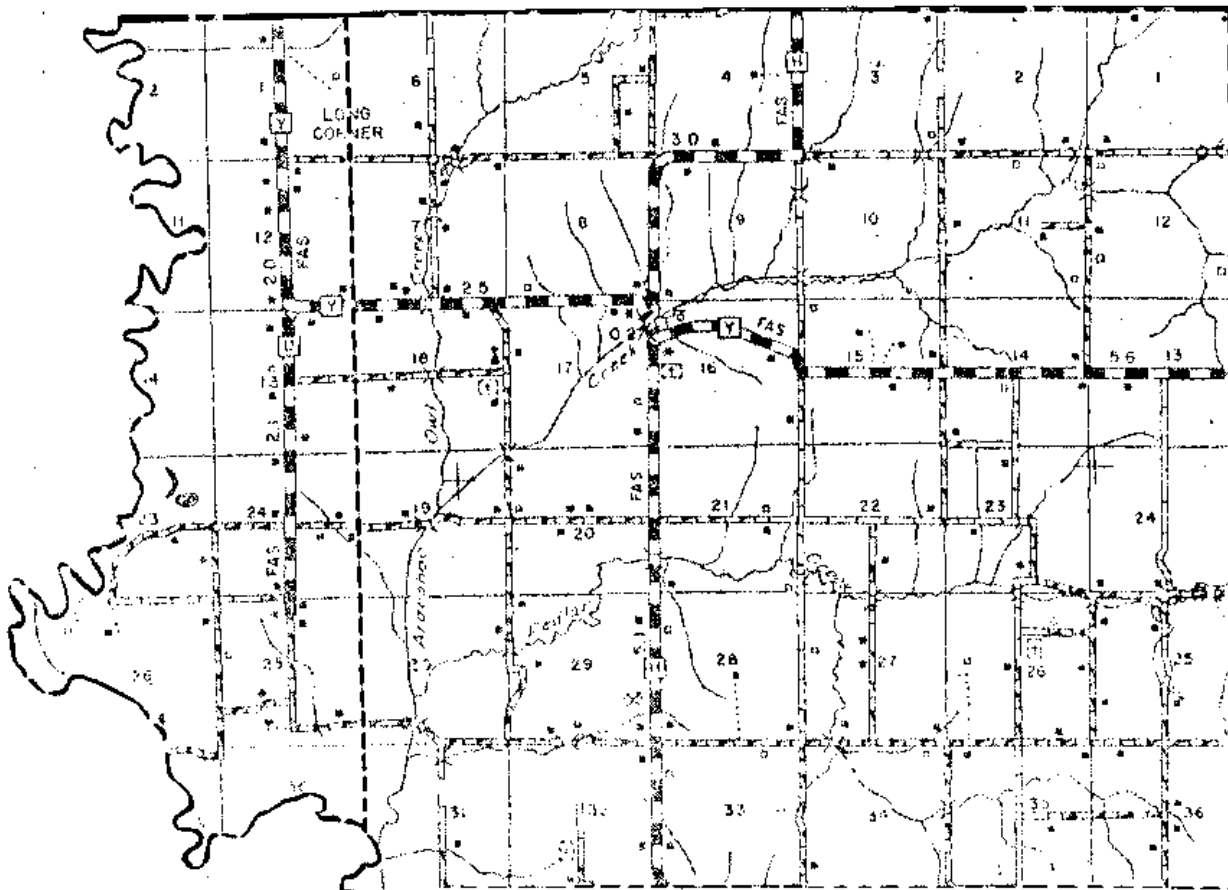

HISTORIC SITES MAP · ANDREW COUNTY, MISSOURI  
 TOWNSHIP 61 N  
 RANGE 36 W, 37 W

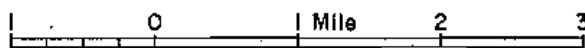

No architectural or historical sites available during this portion of the survey.